

Advocate Health - Midwest

SHARE @ Advocate Health - Midwest

Aurora St. Luke's Medical Center Books,
Documents, and Pamphlets

Aurora St. Luke's Medical Center

April 2018

Spirit: The Spirit of St. Luke's, Fall/Winter 2001

Advocate Aurora Health

Follow this and additional works at: https://institutionalrepository.aah.org/aslmc_books

THE SPIRIT OF ST. LUKE'S

FALL/WINTER 2001

A Publication of St. Luke's Medical Center Office of Philanthropy



**A Gift from
the Heart**
Young newlywed
gets second chance
with heart transplant

Microwave Surgery
Another first at St. Luke's

Frequent Flyer
California Packer fan finds hope

Hanover Society's Founding Member
Marketos' Lifelong Partnership
Remembering Brenda

PROPERTY OF
AURORA HEALTHCARE LIBRARIES
ST. LUKE'S MEDICAL CENTER

JAN 08 2002

The Spirit of St. Luke's is produced by
St. Luke's Medical Center/Office of
Philanthropy for friends and donors.

President, Metro Region,
Aurora Health Care:
Mark Ambrosius

Administrator, St. Luke's Medical Center:
Mark Wiener

Vice President for Philanthropy:
Brad Holmes

Regional Manager, Philanthropy:
Laverne Schmidt

Philanthropy Coordinator:
Judi Fellows

Administrative Assistant:
Judy Zager

Secretary: Joan Schultz

Secretary: Shirley Skowronski

Secretary: Kimberly Sweet

Written by Amalia Schoone and
Marci Pelzer

Edited by Tricia Friel

Design and Production by
Aurora Creative Services

Please direct gifts and requests for
further information to:

Office of Philanthropy
St. Luke's Medical Center
2900 W. Oklahoma Ave., P.O. Box 2901
Milwaukee, WI 53201-2901
(414) 649-7122



On the Cover:
Monica L. McDonald, MD,
Cardiovascular & Thoracic Surgeon

Spirit

FALL/WINTER 2001



Recent newlywed Kristin Neils gets a second chance at life, page 4



West coast Packer fan finds hope in experimental trials at St. Luke's, page 11



Rick Borowski shares the story of his wife's battle with cancer, page 50

Kristin's Second Chance is Gift from the Heart 4
Young heart recipient's inspiring journey through organ transplant at St. Luke's.

Microwave Surgery: Another First at St. Luke's 10
Dr. David Kress pioneers microwave heart procedure.

Frequent Flyer 11
Gil Valles makes monthly trek from California for cancer treatment at Vince Lombardi Cancer Clinic.

Hanover Society: Larry Newman 14
Founding member gives today . . . and tomorrow.

St. Luke's Heart Care Center and Patient Tower 15
Construction update on our new addition.

Staff Profile: Shirley Skowronski 16
Caring for people drives behind-the-scenes staffer.

St. Luke's Experience Inspires Lifelong Partnership 17
Betty and Leon Marketos recognize excellence in care.

Consider the Benefits of a Named Endowment Fund 18
Tom Lorino's family did—so can you!

2001 Dessert Gala 20
Annual Philanthropists Club gala.

The Gift Programs of St. Luke's 21
There are as many funds at St. Luke's as there are stories of hope.

Why I Give 34
To Craig Jones, philanthropy is a family affair.

The Tribute Fund: Remembering Brenda 48
A young wife's courageous battle with cancer.

ST. LUKE'S EARNS NATIONAL AWARD FOR THIRD STRAIGHT YEAR

“Quality care and service are very important to us.”

A national organization is again honoring St. Luke's Medical Center as Milwaukee's choice for health care. The National Research Corporation recently recognized St. Luke's excellence by awarding it a 2001 Consumer Choice Award.

The award is based on four attributes: doctors, nurses, overall quality and image. The National Research Corporation surveys more than 150,000 households to find the top medical care in the Milwaukee area.

“Quality care and service are very important to us,” says St. Luke's Administrator Mark Wiener. We are grateful to our entire staff and our physicians and we should all take pride in this achievement. The hard work, dedication and professionalism of our physicians and staff make it possible for us to offer the care we do. It's an honor that patients recognize these traits.”

“We are pleased to recognize hospitals consumers say are the best,” says National Research Corporation President and CEO Michael Hays.

St. Luke's achieved this distinction last year and in 1999. It also received similar awards from the same company in 1996 and 1997.



St. Luke's Medical Center®

Aurora Health Care

IN THE SPIRIT – BRAD HOLMES

GENEROUS IN SPIRIT, EXCELLENT AT HEART



Brad Holmes,
Vice President
Philanthropy

This issue of *The Spirit of St. Luke's* comes at a time when our nation has experienced an incredible triumph over tragedy, spurred by our generous American spirit. At St. Luke's, we've been fortunate over the years to have shared your generosity, sometimes in moments of great sorrow and, more often, as a celebration of joy. Always, your gifts have helped us to achieve the medical excellence for which we are known throughout the world.

St. Luke's reputation for excellence transcends geographic boundaries, much like the spirit of giving itself. In this issue, you'll meet Gil Valles, who flies 2000 miles from Southern California to the Vince Lombardi Cancer Center for frequent kidney trials and Betty Marketos, who traveled annually from Utica, NY, with her late husband Leon to get the most advanced heart treatment available. You'll learn how Dr. David Kress is pioneering the use of a microwave radiation device to treat people who suffer from atrial fibrillation. And you'll hear the moving story of Kristin Neils – new bride, college student and thriving recipient of a new heart. Your philanthropy has made all of this possible.

Today's donors have become far more thoughtful, intentional and accountable in their philanthropy. Not only do you give because of the place that St. Luke's holds in your heart, you also want us to help fulfill your own personal charitable goals. For this reason, we have experienced a growth in named funds and gifts designated to specific areas of medical excellence and patient care. You will see this personal involvement throughout this issue of *The Spirit*, particularly in the stories of founding Hanover Society member Larry Newman and the Lorino Family.

As you will read in the following pages, individuals and families have been touched by our services, and, in the true American spirit, have responded with their contributions to further our mission of finding new and better ways to deliver health care. These partnerships will help us to advance our excellent medical care and research now and for generations to come. We hope you feel inspired with your power to change lives through your gifts.

A stylized, handwritten signature in dark ink, appearing to read 'Brad'.

Brad Holmes
Vice President for Philanthropy

NEWLYWED APPRECIATES GIFT FROM THE HEART

Kristin Johnston was an energetic young woman with a busy life and a bright future—planning a wedding, attending college and teaching at a daycare. When she started feeling fatigued in April 2000, doctors at first suspected asthma or a sinus infection, but not the onset of heart failure.

Kristin was, after all, only 20 years old.

“I don’t think my doctors wanted to believe it. I was so young,” Kristin says.

A chest x-ray showed that Kristin had an enlarged heart. By July, doctors determined that a virus had attacked her heart and left her with cardiomyopathy, a condition that causes the heart chambers to enlarge and the heart muscle to stretch and weaken. Her doctor referred her to St. Luke’s Medical Center because of its renowned reputation in heart care.

Monica L. McDonald, MD, cardiovascular and thoracic surgeon with the Midwest Heart Surgery Institute, Ltd., became Kristin’s cardiac surgeon. Dr. McDonald trained at Yale Medical School and at the Mayo Clinic. She joined St. Luke’s in 1999 after additional training in heart failure at the Cleveland Clinic Hospital. Her specialties include heart transplants, transitioning patients from cardiac pump devices and implanting cardiac assist devices. Dr. McDonald’s respect for her now-mentor, Alfred J. Tector, MD—a nationally known and widely published cardiac expert and medical director of St. Luke’s transplant program—and our hospital’s achievements in cardiac care, drew her to St. Luke’s.

By the time Kristin came to St. Luke’s, her heart was barely working. Kristin’s ejection fraction, which indicates how much blood is being pumped to the heart, was 10 to 15 percent, instead of a healthy 65 percent. Because her heart function was so poor, Dr. McDonald immediately qualified Kristin for a heart transplant.

The first step in Kristin’s transplant process was passing an evaluation for psycho-social suitability. Candidates must demonstrate they have the family support and the



After successful heart transplant surgery at St. Luke’s, Kristin (Johnston) Neils (pictured left) is grateful to her heart surgeon, Dr. Monica McDonald, for giving her a second chance at life.

emotional abilities necessary to follow through with the post-transplant regimen of medications and doctor appointments. Transplant patients must be prepared to monitor themselves for the signs and symptoms of rejection for the rest of their lives. Ron Niles, Kristin’s fiancé, now took an active role in her transplant process, too.

BY THE TIME KRISTIN CAME TO ST. LUKE’S, HER HEART WAS BARELY WORKING.

After passing this evaluation, Kristin was entered into the United Network for Organ Sharing (UNOS) and joined 4,000 other patients on a national waiting list for a donor heart.

On the UNOS list, patients like Kristin are sub-ranked by height, weight, blood group, medical urgency and time already spent waiting. When donor hearts become available, they are matched locally, regionally and then nationally. Initially, Kristin was listed as a non-critical status 2 case, because, at the time, she was allowed to

continued on next page

leave the hospital and was not dependent on a device for normal heart function.

While waiting for her donor heart, Kristin received extensive medical care at St. Luke's which enabled her heart function to gradually improve. Briefly feeling better, Kristin returned home, cautiously taking up the activities of a typical 20-year-old—shopping, in-line skating and getting caught up in the planning of her wedding. But as time progressed, Kristin's improved heart function was short lived. Fatigue now affected every aspect of her young life.

By early November, Kristin realized that she wouldn't be able to keep up with her early childhood education classes at the University of Wisconsin-Milwaukee that semester. Despite seeing Dr. McDonald regularly and taking multiple medications, she continued to weaken until she entered the hospital again, desperately ill. Her condition had deteriorated to the point that her survival depended on either a new heart or an artificial device. "In spite of aggressive treatment, she wasn't getting better," Dr. McDonald says.

Since a donor heart was not immediately available, Dr. McDonald connected Kristin's heart to a semi-permanent mechanical pump that is typically used as a "bridge" to transplantation. Because Kristin had right- and left-sided heart failure, the pump was needed to do the work of both sides of the heart. The device was large, cumbersome and connected to a console.

Because of the pump, Kristin would be unable to leave the hospital until a donor heart was available. Her status was immediately advanced to 1A, the most critical ranking on the national waiting list. Kristin and Ron worried about their plans for the future with her life now dependent upon a donor heart.

Kristin spent the next 16 days in the intensive care unit and another week in the cardiac intensive care unit. When her condition stabilized, she was moved to the fifth floor with other pre- and post-transplant and bypass patients to wait for a donor heart.

Kristin's stay on the fifth floor at St. Luke's lasted three long months. Her weight, which in July had ballooned to 152 (from water retention as a result of the medications), dipped to 92, well below normal for her small frame. In December, Kristin and Ron shared a terrible disappointment when they were alerted a donor heart became available, but which was later determined to be a poor match. Through it all though, the St. Luke's staff kept Kristin's and Ron's spirits high.

"It was hard to be in the hospital for the holidays—Thanksgiving, Christmas, New Year's—and I was scared. But the nursing staff was so kind," she says.



St. Luke's surgical assistants and organ procurement coordinators include (front row) Karen Hille, Sue Hornburg, Irena Lachmann-Kavanaugh, Jennifer Johnson, (back row) Paulette Risley, Jesse Houlter, Joan Heimler and Cathy Eaton.

Ron visited daily after work and says the St. Luke's staff treated him like a "second patient." Offers of food, video movies and comfortable chairs made him feel at ease and he appreciated the straightforward information he received about Kristin's progress. "I always felt welcome, no matter what they were doing. I know St. Luke's is the best place Kristin could have been," he says.

The nurses developed a special fondness for Kristin because of her young age and positive outlook. They

continued on next page



St. Luke's transplant coordinator Chris Kretschmer.

realized that Kristin should have been enjoying some of the best moments of an active young life that year—planning her wedding and attending college. The nurses worked hard to make her stay as happy as possible, despite the circumstances.

Being separated from friends and family for such an extended period was difficult for Kristin, but the cardiac care nurses supported her and made her feel special. They decorated Kristin's room, threw her a 21st birthday party, arranged for special menus, stayed after their shifts to chat, and bought her fun pajamas.

In the course of her stay, Kristin developed a special bond with her primary nurse, Michele Schultz. Kristin was a "night owl" and Michele worked the late shift. The two became fast friends.

Michele braided Kristin's hair, helped her order holiday presents over the Internet and taught her how to protect the heart pump while bathing. The two discussed Kristin's wedding plans and shared an interest in scrapbooking. Kristin looked forward to frequent trips

outside with Michele, even though her stay at St. Luke's spanned the coldest months of the year.

"Kristin knew that she had a lot to look forward to when she got her new heart. She became more of a friend than a patient to me. I think that's what she needed at the time," Michele says.

It's not uncommon for nurses and patients at St. Luke's to develop these special bonds. "I feel like I went the extra mile, but we always make a special effort. I try to remember that while people are at St. Luke's, this place becomes their home," Michele says.

Verna Seitz, regional manager of St. Luke's Transplant Program, says each patient has a touching story to tell. "The waiting is difficult for most patients and their families. Our goal is to maximize each patient's quality of life before *and* after transplant," she says.

"I TRY TO REMEMBER THAT WHILE
PEOPLE ARE AT ST. LUKE'S, THIS
PLACE BECOMES THEIR HOME."

— MICHELE SCHULTZ, RN

Kristin quickly and memorably endeared herself to nurses and other patients because of her youth and unusual circumstances. "It's much more emotionally-charged when you have a young patient. Kristin was asking questions we had never heard from a transplant patient before, like whether she could go in a hot tub on her honeymoon and if she would be able to have children. It was hard for the nurses to not let their emotions get the better of them," Dr. McDonald says.

continued on next page

In the middle of the night on January 11, 2001, the St. Luke's team received word that a suitable heart was available for Kristin. At last, Kristin had found her match. Since the narrow window of time for an effective transplant is within four hours of the organ retrieval, Dr. McDonald traveled with the transplant procurement team, by Lear jet and ambulance, to retrieve the heart while Dr. Tector and his team prepared Kristin for surgery by placing her on cardiopulmonary bypass and removing her pump.

The experienced and highly-trained transplant staff, always ready at a moment's notice, was set for action Sunday morning when Dr. McDonald's team returned. Together with Dr. Tector, Dr. McDonald skillfully transplanted Kristin's new heart.

The surgery was a success.

"Every transplant at St. Luke's is a precise and well-orchestrated effort, performed by the best people for the job. A lot of places do heart surgery, but we have the team at St. Luke's that is ready 24-hours-a-day. Everybody comes in and executes their role with precision. They're on alert at all times, even on a Sunday morning," Dr. McDonald says.

Because of strict confidentiality requirements, Kristin knows little about her donor—only that the person was a 20-year-old from Chicago.

Kristin was released from St. Luke's 10 days after her transplant. During the first three months of recovery she built up her strength slowly, minimizing the risk of infection by avoiding crowds of people. This meant postponing her return to college and working in the daycare center. But she still had one goal that wasn't going to be put on hold any longer.

On September 15, 2001, Kristin and Ron walked down the aisle as man and wife and celebrated the wedding of their dreams. Well on the road to recovery, today Kristin has resumed her studies and is on track to

graduate from UWM in 2004. She will take anti-rejection medication for the rest of her life, but has needed to make few long-term lifestyle changes and is feeling great. She has returned to her part-time job at the daycare and plans to teach kindergarten upon graduation. Kristin's nurse, Michele, remains a dear friend, with whom she shares emails and shopping excursions.



Verna Seitz, regional manager of St. Luke's Transplant Program

Dr. McDonald has also maintained a unique relationship with Kristin, one of her youngest transplant patients. Since a heart transplant is only the first step in the care of a patient, Dr. McDonald will closely follow Kristin's progress for years to come.

Kristin's transplant is one of 455 that have been performed at St. Luke's since the Midwest's first heart transplant was performed here in 1968. Each patient who undergoes an organ transplant experiences the same compassion and outstanding care that Kristin received.

"It's unique for a private hospital like St. Luke's to have such an advanced transplant program. The staff is driven to help these incredibly ill patients and has fine-tuned its care to optimize every possible resource. I am very proud of the program," Dr. McDonald says.

Kristin's close relationship with Dr. McDonald and Michele is a result of St. Luke's commitment to having the same team care for a patient—from referral, through surgery, to follow-up. A highly trained cardiac or intensive care nurse also guides the process from behind the scenes as a transplant coordinator.

continued on next page

"It's the most comprehensive approach and we believe it maximizes the most positive outcome. That's why we exceed all the national benchmarks in patient survival," Verna Seitz affirms.

Kristin is extremely grateful for the special care she received at St. Luke's and says that during her long stay, the transplant team's extra efforts made a big difference.

"The nurses have such warmth and personality. They treat you with such concern. They talked to me in terms that I understood. They told it to me straight," she says.

Dr. McDonald credits philanthropy for helping to advance the services that Kristin needed the most.

"Funds raised at St. Luke's support equipment, specialist training, education and innovative technology. These things kept Kristin alive. She's a healthy young woman with her whole life ahead of her, and that's gratifying to the people who worked so hard to keep her alive," Dr. McDonald says.

"EVERY TRANSPLANT AT
ST. LUKE'S IS A PRECISE AND
WELL-ORCHESTRATED EFFORT,
PERFORMED BY THE BEST PEOPLE
FOR THE JOB."

— MONICA L. McDONALD, MD
CARDIOVASCULAR AND
THORACIC SURGEON

Kristin agrees, "You don't have to be wealthy to make a gift or an organ donation. All of us can save lives through our generosity. I'm living proof!"



Cardiac care nurse Michele Schultz, RN, (left) celebrated with Kristin (Johnston) Neils on her wedding day. Their close friendship developed over the course of three months while Kristin waited for a donor heart at St. Luke's.

St. Luke's performs more heart transplants annually than any other hospital in the state. As a total and comprehensive organ transplant program, St. Luke's also performs liver, lung, kidney, and, most recently, pancreas transplants, including multiple-organ transplants. St. Luke's Medical Center is nationally recognized as one of the leading organ transplant programs in the region.

ORGAN DONATIONS GIVE LIFE

Thousands of lives like Kristin Johnston's are saved every year, thanks to the foresight and generosity of organ donors, but too few of us are making the life-giving choice to donate.

WISCONSIN
REGULAR

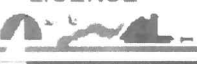
**DRIVER
LICENSE**

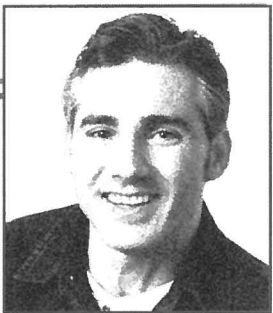

DID: R123-4567-8901-01
Issued: 12-09-01

DOB: 12-10-62
Expires: 12-10-08

Class	Endorsements	Restrictions		
D	None	None		

Sex	Hair	Eyes	Height	Weight
M	BRO	BRO	5'11"	155

STEVEN R. REYNOLDS
3503 COLLE COURT
MILWAUKEE WI 53123

**ORGAN
DONOR**

Any adult may become an organ donor by signing a donor card, indicating this intention on a driver's license, or informing family members. Minors with parental consent are also eligible. Donors may even specify which organs they wish to give.

Although an organ donation is a priceless gift, the donor incurs no costs, as the recipient and their insurance program will cover all medical expenses.

Each year, more than 79,000 children and adults—including many patients at St. Luke's, *one of only four total and comprehensive transplant programs in the state*—anxiously wait and hope for a chance to live normal, healthy lives. Organ donors give mothers, fathers, sons and daughters a second chance for life.

To register or find out more about becoming an organ, tissue or eye donor, call the Wisconsin Tissue Bank at St. Luke's Medical Center at 1-800-722-8230.

To Remember Me

Give my sight to the man who has never seen a sunrise, a baby's face or love in the eyes of a woman.

Give my heart to a person whose own heart has caused nothing but endless days of pain.

Give my blood to the teenager who was pulled from the wreckage of his car, so that he might live to see his grandchildren play.

Give my kidneys to one who depends on a machine to exist from week to week.

Take my bones, every muscle, every fiber and nerve in my body and find a way to make a crippled child walk.

If you must bury something, let it be my faults, my weaknesses and all prejudice against my fellow man.

Give my sins to the devil.

Give my soul to God.

If, by chance, you wish to remember me, do it with a kind deed or word to someone who needs you.

If you do all I have asked, I will live forever.

—Robert N. Test

SUCCESSFUL MICROWAVE HEART SURGERY IS ANOTHER FIRST FOR ST. LUKE'S MEDICAL CENTER



David C. Kress, MD,
Cardiovascular and
Thoracic Surgeon

The effects of the nation's first successful microwave heart procedure to correct atrial fibrillation are expected to ripple into a

revolution, forever changing the way heart arrhythmia is treated.

David C. Kress, MD, chief of thoracic and cardiovascular surgery at St. Luke's, first performed the delicate procedure on 76-year-old Audrey Przbycien in June of this year. He expects to perform around ten by the end of 2001, and an average of 20 or more annually. The technique could eventually be used to treat 80,000 people a year worldwide.

Atrial fibrillation is an uncontrolled beating of the heart's upper chambers due to a breakdown of the heart's electrical signals. It prevents upper chambers of the heart from sending blood into lower chambers, causing problems ranging from fatigue and dizziness to chest pain and sleep disorders. It is the most common form of cardiac arrhythmia and can lead to stroke. In the United States, it affects over 2 million people, and 15 percent of all people over age 80. That number

will grow as the population ages. "This procedure gives surgeons a simple, safe and fast treatment with an expected 80 to 90 percent effectiveness rate," say Dr. Kress.

Inaugural patient Audrey says she is feeling great and back to pruning bushes, gardening and lunching with friends. She had been suffering from arrhythmia since 1962 and says she never worried about being the first patient to have this procedure performed. "I never felt apprehensive. I have great confidence in Dr. Kress and in St. Luke's," she says.

"MOST PLACES DO NOT
HAVE THE CALIBER OF
PEOPLE WE HAVE HERE."

— DR. DAVID C. KRESS

Previously, Dr. Kress treated atrial fibrillation using an electric current technology called *radiofrequency ablation*, a procedure that he also pioneered. Although this technique eliminated the need for surgical incisions, instead heating the heart's atrium, Dr. Kress is already calling it "the old technology."

"The microwave catheter can be slid under the heart and heated on only one side from the bottom-up. You can't do that with radiofrequency," he says.

Microwave technology is faster, safer, more exact and less invasive than other techniques. The fine antenna has shielding which protects other structures in the chest. The ablation lines can be performed in 20 minutes. And it can be done on the outside of the heart, without connecting the patient to a heart-lung machine.

Dr. Kress is already sharing his expertise. He has been asked to set up a registry of microwave procedures performed in the United States and is building a web site that physicians can access. He has conducted training courses and demonstrated ablation techniques to over a dozen visiting surgeons.

There is a reason St. Luke's is on the cutting edge of advances in cardiac surgery procedures, asserts Dr. Kress. "Most places do not have the caliber of people we have here, even academic centers," he says. "We have one of the top electrophysiology labs in the country. I don't think there is another hospital that can provide the level of comprehensive care for atrial fibrillation that we can."

Long-term patient Audrey agrees. "St. Luke's is an outstanding hospital. I'm astounded to see what it's grown into and I'm very happy to hear that people will benefit from what we did," she says. *S*

WEST COAST PACKER FAN TAPS LOMBARDI'S WINNING SPIRIT THROUGH KIDNEY CANCER TRIALS



Gil Valles travels from his home in California once a month to take part in experimental cancer treatment trials at the Vince Lombardi Cancer Clinic at St. Luke's.

Growing up, Gil Valles was a diehard Green Bay Packers fan, admiring the team's ability to overcome obstacles and achieve victory against all odds. But the life-long Californian could not anticipate how the team's spirit of hope would personally touch his life.

Gil, 62, was first diagnosed with renal cell carcinoma, a form of kidney cancer, in June of 1999. After finding a 7-centimeter malignant mass, doctors removed his right kidney. Although the worst appeared to be behind Gil and his family, the following year doctors found a second growth requiring the removal of the top portion of his remaining kidney. After surgery for these two episodes, Gil returned to his job as a longshore-foreman with no evidence of disease.

That fall, Gil's daughter Jody surfed the Internet to search for a treatment that would prolong her father's remission. She found that most trials for renal cell carcinoma involve health risks and severe side effects. Fortunately, an online acquaintance e-mailed her about the Autolymphocyte Therapy Trials at St. Luke's Medical Center in Milwaukee, Wisconsin.

The experimental treatment trials involve removing some of the patient's white blood cells, treating the cells with proteins to activate their cancer-fighting ability, freezing the cells and reinfusing the stronger cells back into the patient. The goal is to stimulate the immune system to prevent the return of kidney cancer.

The trials appealed to the Valles family because the treatment is non-toxic and involves few side effects. Similar treatments have produced positive results in the past for other patients with kidney cancer. "Of all the cancer treatments in all the world, the best one for my dad happens to be 2000 miles from us at St. Luke's Vince Lombardi Cancer Clinic (VLCC) in Milwaukee," Jody says.

The VLCC offers research, prevention, detection and education programs that make cancer preventable and controllable for patients like Gil. The Clinic was named for the beloved Green Bay Packers coach Vince Lombardi, who died from colon cancer in 1970. In 1971, members of North Hills Country Club and other business leaders and golfers mobilized to raise money for cancer research on behalf of Coach Lombardi. The VLCC thrives today as a result of these efforts by Vince Lombardi Charitable Funds.

Gil is mid-way through his treatment, which requires traveling to St. Luke's monthly for six months, and then quarterly for 18 months. In between visits, Gil receives CT scans and radiology work at his home hospital in Laguna Hills, California. Results will be tracked for seven years.

continued on next page

Members of the Valles family, which includes Gil's wife, Sharon; daughters Jody, Nancy and Kelly; sons-in-law Tom and Eric; and grandchildren Kelly, Sarah and Rusty, are hopeful that Gil's treatment is prolonging his remission. Only patients with no evidence of disease are eligible for the program.

Gil says he feels great and is gratified that his participation in the trials could help others. "If this program is successful, it can be done at other hospitals, maybe even in California," he says.

Presently, of the estimated 31,000 new cases of renal cell carcinoma diagnosed annually in the United States, approximately one-third are inoperable and approximately 12,000 patients will die. Chemotherapy is generally ineffective.

Although the cross-country trips are difficult and expensive, Sharon always accompanies her husband to Milwaukee to support him through the treatments. She knows the couple is doing the right thing by participating in this study.

"As much as I thought I would dread this, I look forward to the trip each time. I like seeing the people at St. Luke's. And instead of just sitting back and waiting, we're doing something," she says.

Each June, one VLCC patient is honored at the Vince Lombardi Run/Walk to represent the many stories of hope that the Clinic makes possible. This year's honored survivor was Gil, accompanied by Sharon and Jody. They spent the day with the event's co-chairs, legendary Packers quarterback and Hall of Famer Bart Starr and his wife, Cherry. "We wound up being celebrity guests. We were picked up in a limo and taken to a country club as part of the festivities," Gil says. "We were honored to be a part of this important event."

This year's Run/Walk attracted 3,000 participants, many walking as families and teams in honor of loved ones. A tribute wall decorated by participants was displayed at St. Luke's for several months following the event.



Gil Valles (second from left) was honored at this year's Vince Lombardi Run/Walk. Pictured with Gil are (from left) Bart Starr, Gil's wife Sharon and daughter Jody, and Cherry Starr.

The next month, the couple planned another appropriate outing around Gil's treatment—visiting Lambeau Field and the Green Bay Packer Hall of Fame for the first time. They took the initiative to arrange this trip to learn more about the revered coach and team that have inspired Gil's recovery.

Gil can't help but use a sports metaphor when describing his reason for participating in the trials. For him, the Lombardi spirit and legacy have been a life-saving force. "As a cancer patient, you have to take the offense. Most doctors aren't aware of programs like the one I'm in now. The only doctor I want to see is my oncologist at the Vince Lombardi Cancer Clinic, Dr. John Hanson," Gil says.

Jody Valles believes her dad's connection to Vince Lombardi is oddly appropriate. The special care he is receiving as a part of the coach's legacy is giving the family hope, possibly prolonging Gil's life and that of many others. "Today my dad is getting a promising treatment, created by phenomenal doctors, administered by an incredibly compassionate staff, all on behalf of a man he truly admired," she says. *S*

Vince Lombardi *Cancer Clinic*

Cancer Hotline Connects Callers to Important Information

An Internet search ultimately led Gil Valles to the Vince Lombardi Cancer Clinic, but navigating and analyzing the abundance of available cancer research need not be so complicated.

The Vince Lombardi Cancer Hotline connects cancer patients and their loved ones to the latest research, cutting-edge treatments, prevention information, support groups, financial counseling and other resources. The hotline is open to everyone, and all calls are confidential.

Cancer information specialists field each call, taking the time to understand and address each caller's unique needs.

A variety of resources, including a cancer library, a frequently-updated cancer database, the Physician Data Query of the National Cancer Institute, and Internet searches for national trials may be consulted to answer a caller's questions.

Calling the hotline may be the first step on the journey to remission. Research shows that patients who take an active interest in their health care can have a positive effect on their outcome.

Hotline: (414) 649-7200

1 (800) 252-2990

Save the date!

The 2002 Vince Lombardi Run/Walk is scheduled for **Saturday, June 8** at Menomonee Falls High School.

Call (414) 649-7015 for more information.



VINCE LOMBARDI
Charitable Funds, Inc.

How many **steps** do you walk **each day?**

The latest, greatest way to estimate your total activity is with a Digi-Walker™ step counter. You'll see firsthand the distance you walked and calories burned. Then with the feedback the Digi-Walker™ provides, you'll be able to develop and implement strategies to gradually reach the goal of at least 10,000 steps per day.

The **Digi-Walker™**
can be yours for just **\$20.**

Call (414) 649-5767 to order.



St. Luke's Medical Center®
Aurora Health Care



SPIRIT OF INVOLVEMENT INSPIRES MEMBERSHIP

Larry Newman embodies the philanthropic spirit. His desire to make a meaningful impact with his philanthropy has inspired Larry to join the Hanover Society as a Founding Member.

The Hanover Society, established in 2000, is the newest distinction



Larry Newman

honoring leadership giving to St. Luke's Medical Center. The name comes from the original Hanover General

Hospital on the corner of Madison and Hanover (now South 3rd) Streets in Milwaukee. "I remember when the hospital was there," says Larry, who worked at nearby Allen Bradley for 37 years.

Speaking humbly of his contributions to St. Luke's, Larry explains that he wants his gifts to make a difference during his lifetime. Larry has designated St. Luke's as the sole beneficiary of his estate, knowing that his gift can have a strong impact on medical excellence. His close friend, Dominic Lychwick, has been a contributor to St. Luke's for many years and encouraged him with this decision. Soon afterward, Larry decided he wanted to start making contributions during his lifetime, so he could also enjoy his giving now. He has several charitable gift annuities; through this gift arrangement, Larry receives



quarterly interest payments, and St. Luke's will receive the principal from the gift after his death. "I'm still donating, but I'm getting something in return every year," says Larry.

Born in Loyal, Wisconsin, Larry was raised by an aunt after his parents died when he was very young. After serving his country for four years as a U.S. Marine, Larry moved to Milwaukee. He and his wife, Corinne, traveled extensively throughout the U.S. following their retirement. They enjoyed a long marriage of nearly 60 years before she passed away.

Larry likes his connection with St. Luke's fostered through the Lifetime Philanthropists, an organization for donors who have made provisions to support St. Luke's through their estate plans or through life income gifts, and now the Hanover Society. Motivated to tell others about the Hanover Society prompted Larry to share his story now.

Says Kelly Sachse, former director of Planned Giving at St. Luke's, "Larry is a very modest person, and he has a generous spirit. He is

such a joy and he wants to make an impact on the lives of others.

He often says, 'I really want to make a difference for people.' He genuinely cares about others." Through his philanthropy, the next generations will be touched by Larry's spirit. *S*

ABOUT THE HANOVER SOCIETY

The Hanover Society was established to recognize St. Luke's tradition of medical excellence. Named after the original Hanover General Hospital, membership begins with an initial gift of \$5,000 and is continued with a minimum annual gift of \$1,000. Benefits of Hanover Society membership include:

- The *Reception of Merit*, a special recognition event
- The *Wall of Tradition*, an exclusive recognition area to be established in St. Luke's Heart Care Center and Patient Tower
- Expanded *Naming Opportunities*, including patient rooms in the new St. Luke's Heart Care Center and Patient Tower
- Extraordinary recognition, including *Lifetime Hanover Society Membership* for significant one-time or cumulative gifts
- Continued membership in *St. Luke's Philanthropists Club* and all the associated benefits

For more information about joining the Hanover Society, or to learn more about these benefits, contact Laverne Schmidt at (414) 649-7123.

BUILDING ON TRADITION – ST. LUKE'S HEART CARE CENTER AND PATIENT TOWER

Construction of a 12-story Heart Care Center and Patient Tower on the campus of St. Luke's Medical Center will enhance the facility's long-standing tradition of leadership in heart care excellence and improve the "patient friendliness" of the entire medical complex.

Preliminary site preparation got underway earlier this year for the 420,000-square-foot addition next to and above the existing parking structure. The addition is a major step toward the fulfillment of St. Luke's master plan to cluster services and patient care areas in a way that will accommodate rapidly changing and advancing medical technology, along with accessibility, comfort and convenience for patients and visitors.

The unique design brings together St. Luke's incredible array of cardiac care services. All education, prevention, diagnostic and treatment services—both inpatient and outpatient—will be integrated within the centrally located addition to provide "all under one roof" convenience for anyone needing any level of heart care.

The upper floors of the addition will house 192 private patient rooms, six to eight operating rooms and 78 intensive care unit beds. All cardiovascular and thoracic medical, intensive care and surgical units will move to the new Patient Tower, gaining the distinct advantage



Construction crews work atop the current parking structure.

of close proximity for patients transported in and out of these related areas. "Few

heart centers are able to link the operating rooms and intensive care units like this," says Mark Wiener, St. Luke's administrator. "It will allow St. Luke's to offer the most efficient and effective cardiac surgical and intensive care possible."

Upon completion—projected for 2004—the new addition is expected to be sophisticated and technologically elite. The way it will "look and feel" for patients, families, physicians, employees and others will also make it a truly significant hallmark in health care.

"This expansion is all about moving medicine into the next millennium," says John Bowman, MD, St. Luke's chief of staff. "The design of this addition takes advantage of St. Luke's years of expertise in cardiovascular care and blends it with all the important elements of comfort and function. Patients in every area of the medical center will benefit." *J*

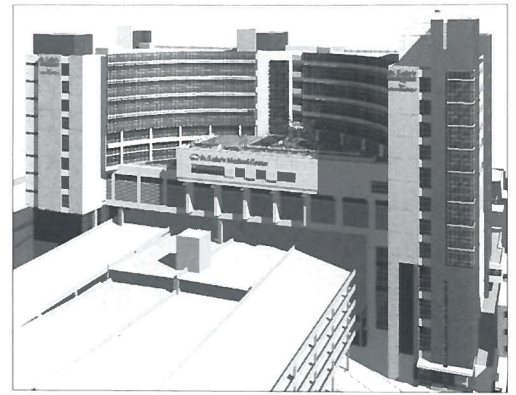

St. Luke's Heart Care Center and Patient Tower is scheduled to open in 2004.

St. Luke's Heart Care Center and Patient Tower Construction Trivia:

- There are approximately 200 on-site workers daily.
- The weight of the large steel trusses placed over the existing parking structure is equivalent to 125 African bull elephants weighing 16,000 pounds each.
- If the amount of steel on this project was shrunk down into 1/4" diameter pieces, it would stretch from Milwaukee to Moscow and back.
- The amount of concrete being used on the project could fill 2,000 concrete trucks.
- The 420,000-square-feet of building space is equivalent to nine football fields under one roof.

SHIRLEY SKOWRONSKI: CARING FOR PEOPLE



Shirley Skowronski

As a secretary in the Office of Philanthropy for almost three years, Shirley Skowronski's behind-the-scenes work has helped donors realize their charitable vision for the hospital. But their vision is also her own. Shirley has undergone surgery at St. Luke's

and has experienced firsthand St. Luke's excellent care. Giving back, as a member of St. Luke's Employee Philanthropy Club, means something special to her. As she says, "It's wonderful working in an area of the hospital where you meet people firsthand who want to express their appreciation through a gift to St. Luke's."

Shirley works closely with Laverne Schmidt, Regional Manager, Philanthropy. Her responsibilities include

assisting with planning for the annual Dessert Gala and the Lifetime Philanthropists luncheon, as well as working with the Stuffer Duffers. "It's fun to get together with them, they're a great group of caring people" she says of the Stuffer Duffers, volunteers who help collate, label and stuff mailings for the philanthropy office.

Shirley's husband Jerry recently retired. They enjoy traveling, with Hawaii as a favorite destination in recent years. During football season, you can find them rooting for the Packers. In the spring and summer, you may find them tending the garden of their dream house that they built four years ago. They have two children, a son, Kevin, and a daughter, Christine. No grandchildren yet, unless you count "the four-legged kind, a cat and a dog," as Shirley says.

Clearly, Shirley enjoys her work in the Office of Philanthropy. "Shirley's willingness to take on any assignment, along with her sense of humor, makes her a great asset to the office," says Laverne Schmidt. *S*



JUST IN TIME FOR THE HOLIDAY SEASON

In the last issue of *The Spirit of St. Luke's*, we told you about Wendy Paustian and her beautiful, hand-made ornaments to benefit breast cancer research at St. Luke's. We're pleased to report that Wendy recently moved back to Milwaukee and will be showing her collection at local craft fairs.

You can also order one or more of Wendy's ornaments in the ribbon colors of your choice by calling

(414) 688-1480 or emailing Wendy at 24601@ticon.net. Ornaments are \$10 plus shipping costs.

Each ornament comes with its own gift bag and tag noting that the proceeds support St. Luke's breast cancer research.

*Happy
Holidays!*



Rich fabrics and metallic ribbons make one-of-a-kind ornaments.

EXCELLENCE AND CARING INSPIRES LIFELONG PARTNERSHIP

When Betty Marketos' husband, Leon, needed a triple bypass in 1977, he chose St. Luke's Medical Center. At that time, triple bypass was relatively new, and Leon wanted to ensure that he received the highest quality of care. In that pre-internet age, choosing a hospital for this procedure seemed like a daunting task. Living in Utica, NY, Leon gathered all the information he could to carefully research outcomes at the leading hospitals around the country. He chose St. Luke's because of its reputation—even back then—as a leader in heart care. Coincidentally, St. Luke's heart specialists Dr. Alfred Tector and the late Dr. Robert Flemma, who died in 1998, also came from Utica. In fact, it was learned that Leon and Dr. Flemma's father both practiced law in the same office building.

Leon's successful bypass began a long relationship of admiration between Leon, his wife Betty and St. Luke's. Every year, they traveled the long distance from Utica to Milwaukee for St. Luke's exceptional heart care. "We were very impressed with the service we received when we first came here. It was one of the first hospitals that had services for everything ... it seemed so progressive, I went home and told everyone all about it," said Betty.

When Betty developed heart problems of her own, she had her surgeries at St. Luke's as well. In the interim, Leon had a second heart surgery in 1989. While the prognosis was not good, Leon enjoyed seven irreplaceable years until his death in 1996, and credited his quality of life to the expert care he received at St. Luke's.

"We got to know many of the heart care specialists at St. Luke's. Coming back year after year, we were treated by the same technologists, who would take our electrocardiograms, and the same nurses ... it was like old home week. We got quite friendly with all the nurses," says Betty, "we had our checkups every year at St. Luke's when we came to Wisconsin to visit our daughter."

Leon and Betty went to high school together, reunited after attending separate colleges and soon married. Leon attended Hamilton College and then Harvard

Law School, while Betty attended the University of Michigan. "We had a wonderful life together," said Betty. They have three children: two sons, Gerald, a doctor in Utica and James, an attorney in Washington; and a daughter, Barbara, who is the general secretary of Black Wolf Run and lives in Sheboygan. They also have six grandchildren and one great-grandchild.

After a successful law practice, Leon was appointed a federal bankruptcy judge. Once the children were grown, Betty returned to work as a high school French teacher. The family enjoyed traveling together every year, with Europe, particularly France and Greece, as a favorite destination.

In appreciation of the special care they received, Leon and Betty wanted to give something back to St. Luke's and so became members of St. Luke's Philanthropists Club. "Leon thought the world of St. Luke's and the doctors and staff. He had great faith in the hospital," said Betty, "and I continue the tradition of giving." Betty, who now lives in Sheboygan to be close to her daughter, still communicates with two of the nurses who cared for her and Leon.

St. Luke's has had a profound effect upon the Marketos family, and, in the true philanthropic spirit, they have advanced St. Luke's mission through their annual support. Their gifts help further the excellence in patient care that Leon discovered here so many years ago. *~*



Betty Marketos and her late husband, Leon Marketos.

CONSIDER THE MANY BENEFITS OF NAMED ENDOWMENT FUNDS

A named endowment fund provides a special way for you to continue giving for decades to come. When you establish an endowed fund at St. Luke's Medical Center, you are expressing your lasting concern for the health and welfare of your community.

A named endowment fund remains intact forever. As with any endowment, the donated funds remain intact and only the income from the principal balance can be used. This type of fund ensures the future viability and success of the hospital and enables the board and its administrative team to plan for the future.

There are many ways to identify your fund in addition to recognizing it with your name. For example, you may choose to name your fund in memory of loved ones, such as your parents. A permanent plaque recognizing your named fund will be placed in St. Luke's distinguished recognition area.

There are two ways to designate your fund. One method is to designate it for a specific purpose such as education or research. Another method is to establish a board-designated fund which allows the hospital's board of directors to designate the interest from your fund for use by the hospital for its immediate needs.

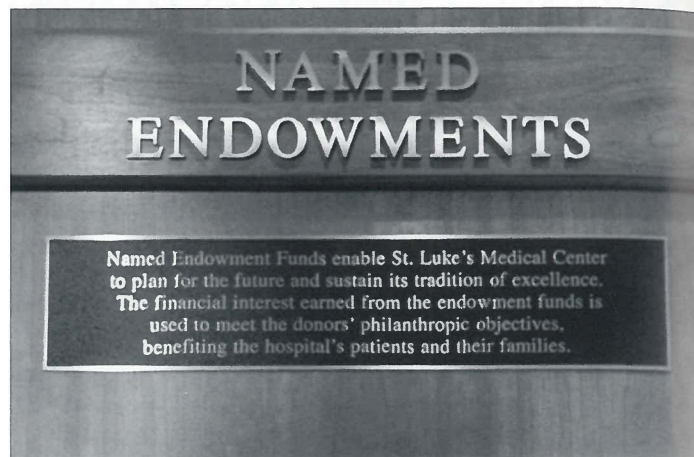

With a gift of \$25,000 or more, a fund can be established in your name or a name of your choice.

A named fund also offers the individuals establishing it many benefits in addition to those outlined above:

- A named fund keeps on giving in perpetuity, benefiting St. Luke's Medical Center, our neighboring communities, and our patients who come from all over the world for their care.
- When you establish an endowed named fund, you may designate it to be directed toward an area of interest to you, such as cancer care, research, education, or heart care.

continued on next page

THE LORINO FAMILY – GIVING FROM THE HEART

Tom Lorino and his family are thankful to St. Luke's Medical Center for the care they have received over the years. In November, in grateful appreciation of the expert heart care he has received, Tom and his wife, Ann Elizabeth, established the Tom A. and Ann E. Lorino Family Heart and Cancer Endowment Fund.

One of Tom and Ann's favorite pastimes is spending time with their 11 grandchildren. Also high on Tom's list of favorites is golfing and reading. Maintaining a healthy lifestyle is important to him and he achieves this through regular exercise and diet.

Tom speaks proudly of his family's involvement in Prolog Logistics, a trucking and logistics management company that he and his wife founded in 1981. "Working is my favorite form of exercise," he adds.

Tom and Ann are pleased to express their caring through the Tom A. and Ann E. Lorino Family Heart and Cancer Endowment Fund. They know that their fund will touch the lives of heart and cancer patients at St. Luke's for generations to come.

- You and others may continue to build on your initial charitable investment. Anniversaries, birthdays, and other special occasions are a meaningful way to celebrate by adding to your fund.
- As a charitable contribution, your gift is tax-deductible as provided by law. There may be other additional tax advantages.
- You may establish a named fund during your lifetime with a gift of cash or appreciated property. A named fund can also be designated through a bequest in your will or by establishing a life income gift, where you retain the income during your lifetime.
- Your endowed fund will be professionally managed and St. Luke's Medical Center will ensure that your

funds are used for the purpose you have specified. You will be kept up to date on your fund so you will have the satisfaction of knowing how your gift is helping others.

Endowment funds are tremendously valuable to St. Luke's Medical Center because they offer permanent financial resources, allowing the hospital to make plans for the future and continue the high quality care patients have come to expect when they come to St. Luke's for their health care needs.

For more information on how to establish an endowed fund, please call Laverne Schmidt, Office of Philanthropy, at (414) 649-7123. *S*



NAMED ENDOWMENT FUNDS

- John H. and Hope E. Barr Immunotherapy Research Endowment Fund
- Mitzi L. Dilworth Nursing Education Fund
- Fred and Jay Dobner Endowment Fund
- Merle and Eunice Eggen Designated Fund
- Employee Philanthropy Club
- John and Judy Gardetto Heart and Cancer Endowment Fund
- Fred C. and Edna Goad Educational Endowment Fund
- Larry J. Horton Leukemia Endowment Fund
- Jahr Cancer Research Endowment Fund
- Knisely Clinical Pastoral Education
- Tom A. and Ann E. Lorino Family Heart and Cancer Endowment Fund
- Medical Staff Endowment Fund
- Russell Rutter Nursing Education Fund
- Schildkraut Memorial Lectureship Fund
- Siebert Pastoral Care Endowment Fund
- R. L. Siebert Endowment Fund
- Walter Schroeder Chair of Nursing
- Walter Schroeder Endowment Fund
- William G. Schuett Cancer Research and Education Endowment Fund
- Security Cancer Lectureship
- Sileno Families Endowment Fund
- James T. and Carol G. Williams Gamma Knife Endowment Fund
- William Worzalla Heart Research Endowment Fund
- Karen Yontz Women's Cardiac Awareness Endowment Fund

PHILANTHROPISTS CLUB FEASTS ON SWEETS

Many donors look forward to eating their sweet delights at St. Luke's annual Dessert Gala. This year's event, held May 2 at the Wisconsin Club, may be remembered as the sweetest celebration yet.

The Dessert Gala recognizes members of St. Luke's Philanthropists Club who have made an annual gift of \$100 or more. It's a time for club members to catch up with old friends and meet new members who share a common goal of advancing medical excellence at St. Luke's.

The honorary committee welcomed guests to this memorable evening, including chairpersons Norbert and Betty Pischke, and members Mary Frances Bullamore and Charles and Mary Schick.

Thoracic and cardiovascular surgeon Daniel P. O'Hair, MD, gave the keynote presentation entitled, "*Innovations in Cardiac Surgery: The Future is Now.*" He explained how the new robotic surgery techniques provide for a safer procedure with less pain and a faster recovery period. A surgeon operates with tiny, highly-detailed surgical instruments controlled at a console. No bones are cut and the incisions are small. Thanks in part to the contributions of many members of St. Luke's Philanthropists Club, these innovations have made cardiac care one of St. Luke's most widely recognized specialties.



2000 Philanthropists of the Year Jim and Carol Williams

Guests also saluted Carol and Jim Williams for their 35 years of outstanding support for St. Luke's. The Williams received the club's highest honor at the Gala, the 2000 Philanthropist of the Year Award. Their recently established named endowment fund, the James T. and Carol G. Williams Gamma Knife Endowment Fund, supports technology to perform delicate brain surgeries at St. Luke's without a single scalpel cut. Mr. Williams has served on the board of directors for both St. Luke's and Aurora Health Care, following in the tradition of Carol's late father, Arthur Grede.

St. Luke's mission of innovative care, as related by Dr. O'Hair and the generosity of St. Luke's Philanthropists Club members, exemplifies the partnership between philanthropy and medical excellence at St. Luke's. Philanthropists Club members' renewable support furthers advanced technology, innovations and research at St. Luke's.

For information on joining St. Luke's Philanthropists Club, please call Laverne Schmidt at (414) 649-7123.

Honorary Philanthropy Committee members (pictured left to right): Mary Frances Bullamore, Charles and Mary Schick, and Norbert and Betty Pischke.

HOW CAN I DIRECT MY GIFT?

For every life touched at St. Luke's Medical Center there is a unique and enduring way to give back. Many of our donors have a story to tell, having known the kindness of a special nurse or the miracle of a medical breakthrough. Others are moved by empathy for indigent families or the power of possibility. At St. Luke's, our donors' collective vision moves daily victories of life and science. Consider furthering your own vision for the future by directing your next gift to a specific fund. We will continue to feature funds that benefit specific programs and services in upcoming issues of *The Spirit*.

Cardiac Care Fund

Recognized throughout the world as a leader in treating heart disease, many of the world's cardiac "firsts" have been pioneered at St. Luke's. From the first heart transplant in the Midwest 33 years ago to this summer's major breakthrough in treating arrhythmias, St. Luke's remains committed to research and development. Research brings hope and is the key to medical progress.

Endocrine-Diabetes Fund

The Endocrine-Diabetes Center treats patients with the full range of endocrine disorders. The physicians using the center have complementary areas of expertise and the supporting staff is experienced in dealing with a variety of conditions, resulting in patients receiving highly skilled, state-of-the-art care. The center includes a productive research laboratory that benefits patients from all over the country, as well as at St. Luke's. Access to clinical research is an asset to patients.

Immunotherapy Program

Just recently, St. Luke's Immunotherapy Program announced the activation of a new clinical trial for patients with metastatic (advanced) breast cancer. A bispecific antibody enables the patient's own immune cells to target and effectively destroy the tumor. This targeting molecule was discovered at St. Luke's and is the only facility in the United States to offer this.

Madison Street Clinic

Located in the most culturally diverse community in the state, the Madison Street Clinic is a free, walk-in clinic serving the uninsured, the homeless and those who face other barriers to access. Staff estimate that a minimum of 10% of their clients are living on the streets, 60% are in unstable housing and 100% are uninsured. Also, 51% are Spanish-speaking only and more than 70% of the Latino population they serve are undocumented.



*Laverne Schmidt
Regional Manager,
Philanthropy*

Nursing Fund

Nurses continuously improve their skills to respond more effectively to their patients' needs. To maintain excellence in all aspects of nursing services, support is provided through this fund for nursing research programs, special educational needs and other nursing activities and programs.

Vince Lombardi Cancer Clinic

Established at St. Luke's in 1989, the VLCC has become synonymous with excellence in cancer prevention, early detection, education and comprehensive treatment of cancer patients. Cancer patients from across the state and nation come to St. Luke's for specialized procedures and services.

For more information on designating a gift to your area of interest, please call Laverne Schmidt at (414) 649-7123.



WELCOME NEW DONORS

GIFTS RECEIVED JANUARY 2001 THROUGH SEPTEMBER 2001

GIFTS RECEIVED AFTER SEPTEMBER 30, 2001 WILL BE RECOGNIZED IN THE NEXT ISSUE OF THE SPIRIT.

Ms. Phyllis S. Aceto
Mr. and Mrs. Paul L. Aiello
Ms. Sarah Al-Saadi
Mr. and Mrs. Paul Alane
Mr. and Mrs. Leslie L. Alt
Mr. James Amberger
Ms. Armella Amhaus
Ms. Natalie Angeli
Mr. and Mrs. John R. Apriesnig
Mr. and Mrs. Richard F. Arndt
Mr. and Mrs. Anthony S. Ascolani
Asociacion Medica Hispano
Americana De Wisconsin
Astra-Zeneca
Mr. and Mrs. Joseph Baef
Mr. and Mrs. Paul R. Baker
Ms. Laurie S. Balistreri
Ms. Marion A. Balz
Mr. and Mrs. Craig Battaglia
Mr. Louis Bauer
Ms. Vivian M. Baumann
Mr. and Mrs. James H. Bayer
Ms. Kathleen A. Bebeau
Ms. Mary M. Beder
Mr. and Mrs. Charles Beetow
Mr. and Mrs. Sigmund B.
Bergesen
Mr. and Mrs. Floyd Bethke
Mr. and Mrs. Lloyd E.
Bettenhausen
Mr. Vernon J. Biever
Ms. Helen M. Billing
Mrs. Genevieve Biskup
Ms. Joan P. Blasczyk
Mr. and Mrs. Clyde C. Bloom
Mr. and Mrs. Paul R. Boltacz

Mr. and Mrs. Robert L.
Brandenburg
Mr. Louis H. Brazee
Ms. Kathryn Brill
Ms. Elizabeth Brisson
Mr. B. V. Brooks
Mr. Thomas J. Broske
Mr. Keith L. Brott
Ms. Janice L. Bruskewitz
Ms. Virginia M. Brzezinski
Mr. and Mrs. Jack Buchler
Mr. and Mrs. Gerald Byrnes
Ms. Leola K. Calkins
Mr. Patrick L. Call
Mr. Remo Z. Cameranesi
Mr. and Mrs. Carl Carstens
Mr. Michael A. Cavalenes
Mrs. Olivia Cerminara
Mr. and Mrs. Patrick Champeau
Mr. Orrin R. Christianson
Mr. and Mrs. Ken Christopherson
Mr. Don Clousing
Mr. Robert P. Colla
Mr. Charles D. Collova
Mr. and Mrs. Robert J. Conohan
COR Therapeutics, Inc.
Mr. and Mrs. Patrick Coraggio
Cordis Corporation
Mr. John-Carl Davis
Mr. George Debellis
Mr. Peter J. Dequarde
Dey, LP
Mr. and Mrs. Robert E. Dieter
Ms. Dorothy R. Digregorio
Mr. and Mrs. Leonard Ditsworth
Mr. and Mrs. Leroy J. Doll



Jean and Raymond Hardt

Dura Pharmaceuticals
Mr. and Mrs. Dan Durante
East Town Pharmacy, Inc.
Ms. Mary H. Eggebrecht
Mr. and Mrs. Jerold D. Engstrom
Mr. and Mrs. Kirk R. Evenson
Mr. and Mrs. William J. Fabian
Mr. and Mrs. Myron K. Ferber
Mr. and Mrs. James R. Filipek
Mr. Gerhard C. Firme
Mr. and Mrs. Andrew G. Forrest
Mr. J. A. Frautschy
Mr. and Mrs. Richard A.
Frederick
Mr. John J. Fritz
Fujisawa Healthcare, Inc.
Mr. and Mrs. John J. Funck
Ms. Luella M. Gau
Mr. and Mrs. Vincent F.
Genatempo
Ms. Madeline R. Gianforte
Ms. Lenore Gillig
Ms. Marie Girard
Ms. Alberta I. Goris+
Ms. Genevieve T. Gorski
Mr. and Mrs. Richard J. Graybar
Great Lakes Surgical, Inc.
Mrs. Arloine Greibe
Mrs. Arlene A. Griep
Mr. and Mrs. Peter R. Grob
Ms. Annabelle Gross
Mr. and Mrs. Robert B. Grosz
Mr. Reginald Grover
Mr. and Mrs. John J. Gryboski
Mr. Clarence Gutoski
Mr. and Mrs. Ruben Guzman
Ms. Dorothy E. Haack
Mr. and Mrs. Alvin O. Haase
Mr. Harold Hafemann
Ms. Dorothy A. Hanna

Mr. and Mrs. Leif R. Hanstad
Ms. Sally K. Harper
Haskin & Book
Ms. Barbara Havnen
Mr. and Mrs. Gerald C. Hay
Ms. Diane J. Hazlett
Mr. and Mrs. Don Hazlitt
Mr. and Mrs. Harry H. Hein
Mr. and Mrs. John Heinen
Mr. and Mrs. Douglas M.
Helgeson
Ms. Emily Hengel
Mrs. Rosemary Hengel
Mr. and Mrs. Steven J. Hengel
Mr. and Mrs. William Hengel
Mr. and Mrs. Carl W. Henrichson
Ms. Kathleen Herbst
Mr. and Mrs. William G. Hesse
Mr. Emmett Heup
Mrs. Helen Heynssens
Mr. and Mrs. Dale E. Hinze
Mr. Harley Hoene
Mr. and Mrs. Robert J. Hoey
Ms. Christine Hogue
Mr. John B. Hove
Mr. Gene Howard
Interiorscapes, Inc.
Mr. Anthony J. Irek
Ms. Elizabeth B. Jacobson
Mr. and Mrs. William R. Jacobson
Mr. and Mrs. Daniel E.
Jakubowski
Mr. and Mrs. Dennis E. Jenkins
Mr. Oscar Jeskewitz
Mrs. Sylvia P. Jordens
Ms. Tammy Kaczmarek
Mr. Rudolf K. Kaden
Mr. and Mrs. Harold Kammerer
Mr. Eldon W. Kannenberg
Mr. Eugene P. Kannin



William and Fran Betz

Mr. and Mrs. Vern W. Bowers
Mr. and Mrs. Dennis M. Bramstedt
Mr. and Mrs. George A.
Brandenburg

Ms. Arlene Dorman
Mrs. Roberta L. Dowell
Mr. Paul A. Drabes
Ms. Lorraine Dubanewicz
Mr. and Mrs. Ronald Dukat

Please note that in order to retain your privacy,
we do not share our mailing lists.
+ Deceased

THE PHOTOGRAPHS ON PAGES 22 - 47 WERE
TAKEN AT THE 2001 DESSERT GALA

Ms. Donna M. Kanter
 Mr. Parminder Kaur
 Mr. Jack W. Kellner
 Ms. Audrey E. Keppler
 Ms. Pelagia Kingl
 Ms. Mary Kirkwood+
 Mr. and Mrs. Richard Kirsop
 Sr. Angela Merici Knepprath
 Mr. William Knudson
 Mr. Kenneth Kobs
 Mr. James Kolander
 Mr. Ralph B. Kolesar
 Mr. and Mrs. Ronald R. Krautkramer
 Ms. Zita I. Kremer
 Mr. John S. Krzyzanowski
 Mr. and Mrs. George W. Kuchenbecker
 Mr. and Mrs. Michael Kuepper
 Mr. and Mrs. George Kuffel
 Ms. Anne L. Kuhn
 Mr. and Mrs. Henry L. Kupsik
 Mr. Arthur E. Kurtz
 Ms. Anna R. Kutrovich
 Ms. Robin Larner
 Rev. and Mrs. Dale M. Larson
 Ms. Edna A. Leider
 Mr. and Mrs. Joseph C. Lentz
 Mr. and Mrs. R. Timothy Lenzi
 Mr. James V. Letizia
 Mr. and Mrs. Dennis L. Lipski
 Mr. and Mrs. Joseph Lontkowski
 Mr. and Mrs. Kenneth Loomis
 Mr. Charles L. Ludden
 Ludman Machine Company
 Ms. Joyce Lukas
 Ms. Agnes Lundwall
 Mr. and Mrs. Adolph A. Lusic
 Mr. and Mrs. Edward R. Maki
 Mr. and Mrs. George S. Malachowski
 Ms. Ruth G. Marks
 Ms. Mary Marsh
 Ms. Catherine T. Maynard
 Mr. Weldon McIntosh
 Mr. Ralph J. McLaughlin
 Ms. Eunice M. McMillan
 Mr. and Mrs. Lloyd C. Meier
 Mr. Warren A. Meilicke
 Mr. and Mrs. Norbert Meinnert
 Mr. John Melesky
 Ms. Marjorie Beukema Metcalf
 Sr. Mary Elsa Metternich
 Ms. Jo Ann R. Metzger
 Mr. Ronald J. Mitchell
 Mrs. Bernadette Moehn
 Mr. Robert F. Moore
 Mr. and Mrs. Daniel Morrical
 Mr. and Mrs. Eugene J. Mueller
 Mr. and Mrs. Kenneth J. Mueller

Ms. Lorraine F. Mueller
 Mr. and Mrs. George Nehrbass
 Mr. Dan A. Nelson
 Mr. and Mrs. Charles S. Newton
 Mr. and Mrs. Arthur F. Niquet
 Dr. and Mrs. Victor I. Nwagbaraocha
 Mrs. Judith O'Hair-Regan
 Ms. Janis G. Oleszak
 Mr. and Mrs. Robert M. Olive
 Ms. Mary J. Olszewski
 Mr. and Mrs. Blasko J. Pagini
 Mr. Richard J. Pagon
 Mr. Daniel Palubicki
 Ms. Mary Ann Palubicki
 Ms. Helen Panko
 Mr. and Mrs. Tom Papez
 Mr. and Mrs. Charles T. Parker
 Mr. Donald W. Pautz
 Milton and Lillian Peck Foundation, Inc.
 Mr. Thomas Pederson
 Mr. Thomas R. Peelen
 Mr. William M. Peltonen, Jr.
 Perclose
 Mr. and Mrs. Oswald E. Peters
 Ms. Betty A. Piantino
 Mr. and Mrs. Donn M. Pierce
 Mr. Edgar Pipkorn
 Mr. Joseph F. Placek
 Mr. and Mrs. William E. Preston
 Ms. Arlene Pritzl
 Mr. and Mrs. John Ptaszynski
 Ms. Doris R. Radtke
 Mr. and Mrs. Antonio Reyes
 Mr. and Mrs. Natividad Reyes
 Mrs. Renee B. Ricco
 Ms. Beverly J. Richards
 Ms. Frances V. Richter
 Mr. Paris Righi
 Ms. Georgiana Risch
 Mr. and Mrs. Ernst A. Riske+
 Mr. and Mrs. Arthur J. Robers

We are so thankful for my husband's care at St. Luke's and to the good doctors.

GRATEFUL WIFE
 HEBRON, ILLINOIS

Mr. Norton C. Roedel
 Mr. and Mrs. Claude A. Rogan
 Mr. and Mrs. Norbert T. Rola
 Mr. Ralph J. Romanski
 Mr. Sidney Rosenthal
 Ms. Lillian F. Rozanski
 Mrs. Patricia Russart



Sara Winski and Betty Kieliszewski

Mr. and Mrs. Rudolph R. Russo
 Mr. Rodney Salzwedel
 Mr. Ervin W. Samolinski
 Ms. Rachel A. Sandretti
 Mr. and Mrs. Marvin J. Schlafer, Sr.
 Mr. John C. Schlosser
 Mr. and Mrs. John H. Schmitz
 Mr. Thomas Schomisch
 Mr. and Mrs. James Schram
 Ms. Kathleen A. Schroeder
 Mr. Loren F. Schultz
 Mr. and Mrs. James G. Schulze
 Mr. and Mrs. Henry P. Schwinn
 Mr. Leroy Schwinn
 Mr. and Mrs. Edward M. Sekutowski
 Mr. and Mrs. Wolfgang Semrau
 Ms. Barbara A. Sharpe
 Mr. and Mrs. Roland B. Sieg
 Ms. Emily Simek
 Mr. and Mrs. George F. Smukowski
 Mrs. Marie R. Snyder
 Mr. and Mrs. Roy A. Speth
 Ms. Katherine M. Springsteen
 Ms. Luella B. Staines
 Mr. and Mrs. Jan Stanislawski
 Ms. Nancy J. Stephan
 Mr. and Mrs. Francis T. Stephens
 Mr. Richard J. Stevens
 Mr. and Mrs. Martin L. Stewart
 Ms. Mae Stine
 Mr. George Stollenwerk
 Mr. and Mrs. Wolfgang Strauss
 Ms. Linda M. Sturm
 Mr. and Mrs. Parker L. Sullivan
 Mr. and Mrs. Jon Sundberg
 Mrs. Regina R. Sweet
 Mr. Steven P. Swetlik
 Mrs. Martha Szopieray
 Mrs. Helen Taylor

Mr. and Mrs. Robert W. Thompson
 Ms. Dorothy J. Thorn
 Mrs. Lena Trandafir+
 Mr. and Mrs. Albert J. Tratnik
 Ms. Carol L. Traub
 Mr. Michael H. Trost
 Mr. S. R. Trucker
 Ms. Florence E. Trzesniewski
 Ms. Margaret A. Tuck
 Mr. Daniel L. Tuszyński
 Mr. George A. Van Eperen
 Ms. Mildred Vierck
 Mr. Frederick A. Voechting
 Ms. Rosemarie J. Voros
 Mr. and Mrs. Alan C. Waal
 Mrs. Sally Wade
 Mr. Reg Waldo
 Ms. Cathy Walters
 Ms. Mary Walther
 Mr. and Mrs. Walter L. Ward
 Mr. Fred A. Washa
 Ms. Diana R. Watson
 Ms. Lisa E. Weber
 Ms. Sophie Weinberg
 Mr. Jerome A. Weitzer
 Mrs. Margaret H. Wells
 Mrs. Mabel Wendorf
 Mr. Donald Westerdahl
 Mr. George Westphal
 Mr. and Mrs. Charles R. Williams
 Ms. Odelia Williams
 Mr. and Mrs. Matthew Winn
 Mr. and Mrs. Peter J. Witt
 Mr. and Mrs. Duane H. Wood
 Mr. and Mrs. Robert A. Wulf
 Mr. Wang T. Yang
 Mr. and Mrs. Fredric R. Yopps
 Mr. and Mrs. John T. Young
 Ms. Sandra Young
 Mr. Clare R. Zimmerman
 Ms. Lynn F. Zwitter

+ Deceased

CORPORATIONS, FOUNDATIONS AND ORGANIZATIONS

GIFTS RECEIVED JANUARY 2001 THROUGH SEPTEMBER 2001

GIFTS RECEIVED AFTER SEPTEMBER 30, 2001 WILL BE RECOGNIZED IN THE NEXT ISSUE OF THE SPIRIT.

The commitment from corporations and foundations is integral to the excellent programs, equipment and services we provide every day to our patients at St. Luke's Medical Center. Through their contributions, we can successfully meet and anticipate the health care needs of the nearly 33,000 inpatients and 417,000 outpatients who come to St. Luke's each year.

Anonymous
A & A Manufacturing
Company, Inc.
Abbott Laboratories
Aerial Work Platforms, Inc.
Archer-Daniels-Midland
Foundation
Asociacion Medica Hispano
Americana De Wisconsin
Astra-Zeneca
Aventis Pharmaceuticals
AXA Foundation
The Baxter International
Foundation
Bethany Presbyterian Church
Big Hollow School District #38
Oscar J. Boldt Construction
Company
Bucyrus International
Foundation Inc.
Chase Manhattan Foundation
The Clasmann Corporation
Client Business Services, Inc.
Cooper Industries Foundation
COR Therapeutics, Inc.
Cordis Corporation
Corning, Inc.
Cost Cutters of
Greater Milwaukee
Custom Structural Inc.
Deutsch Associates
Dey, LP
Dieringer Research Group, Inc.
The F. Dohmen Company
Dura Pharmaceuticals
East Town Pharmacy, Inc.
Fleet Mortgage Corp.

Fortis Insurance Company
Fujisawa Healthcare, Inc.
Genentech
W.W. Grainger Inc
Greater Milwaukee Foundation
Jeannette McKelvey Fund
Great Lakes Surgical, Inc.
Gunny Memorial Golf Outing
Haskin & Book
Heart Care Associates, LLC
Max T. and Anna J. Heller
Foundation
Helwig Carbon Products, Inc.
Household
IBM Corporation
Illinois Tool Works Foundation
Immunex Corporation
Interiorscapes, Inc.
Richard G. Jacobus Family
Foundation, Inc.
Johnson & Johnson
Kohler High School National
Honor Society
KOS Pharmaceuticals, Inc.
Koss Foundation, Inc.
Eli Lilly and Company
Medtronic, Inc.
Merck & Company, Inc.
Metro Milwaukee Auto Auction
Mid Continent
Management Corp.
Midwestern University
Milwaukee Public Schools
Mobile Foundation, Inc.
Northwestern Mutual Life
Novartis
Milton and Lillian Peck



Dessert Gala guests at the Wisconsin Club honoring St. Luke's Philanthropists Club members of 2000.

Foundation, Inc.
Perclose
Pfizer, Inc.
Philip Morris Companies
Pieper Electric/Ideal Plumbing,
Heating & Air Conditioning
Procter & Gamble
Pharmaceuticals, Inc.
Quad/Graphics, Inc.
Rexnord Corporation
Rexnord Foundation Inc.
RSE Video Exchange
Siebert Lutheran Foundation, Inc.
Slattery & Hausman, Ltd.
Sundstrand Corporation
Foundation
That's Amore

Transamerica Foundation
University of Minnesota
Victory Steel
W.O.W. Distributing
Company, Inc.
Wayside Furniture Inc.
Weiss Berzowski Brady &
Donahue
Wisconsin Health and
Social Services
Wyeth-Ayerst Laboratories



Judy and Erwin Lackner



Victoria Italiano and Shawn Kelley

THE GIFT PROGRAMS OF ST. LUKE'S MEDICAL CENTER/OFFICE OF PHILANTHROPY

Congratulations and thanks are extended to those whose names follow for sharing their resources. We salute them for their compassion and sense of community.

HANOVER SOCIETY

Mr.+ and Mrs. James H. Cary
Estate of Anna Patia Evanich
Mr. Fred Gerschwiller+
Mr. and Mrs. Walter F. Landowski
Mrs. Virginia Levenhagen
Estate of Rose Luba
Mr. and Mrs. Ronald J. Miller
Mr. Larry Newman
Mr.+ and Mrs. Earl Qualman
Estate of Ella Sadowski
Mr. William G. Schuett+
Estate of Sidney B. Slocum
Ken and Dorothy Stoll
Estate of Ruth Taplin

DIAMOND

Felicia C. Bartoszak+
Ms. Vivian M. Baumann
Ms. Joanne E. Becker
Mr. Bill Broydrick
Mr. and Mrs. Raymond Burton
Mr. and Mrs. Robert J. Byers
Mr. and Mrs. Kenneth A. Daum
Mr. George L. French
Mr. and Mrs. Charles V. Goldsworthy
Mrs. Joan Greb
Mrs. Agnes Hamilton
Mr. and Mrs. J. Andrew Heller
Mr. Harry G. Henke
Mr. and Mrs. John J. Jaeger, Jr.
Mrs. Sally Kuhlman
Teckla F.+ and Bernard S. Kulinski+
Mr. Dominic Lychwick
Dr. Mary Ness and Mr. Kenneth Ness
Mr. and Mrs. Walter Peltz
Mr. and Mrs. George J. Porter
Dr. and Mrs. Gregory Rypel
Mr. Edward H. Saemann
Mr. and Mrs. Robert L. Schlossmann
Mr. and Mrs. John H. Schmitz
Mr. and Mrs. Charles Shiley, Jr.
Mr. and Mrs. John L. Stearns
Mr. and Mrs. Jon Sundberg
Matched by Household
Dr. and Mrs. Alfred J. Tector
Mr. and Mrs. Kevin Tyler
Matched by Baxter Foundation
Mr. and Mrs. Frederick Wittkowske

CRYSTAL

Mr. Wilfred A. Brighum
Mr. and Mrs. William I. Buckeridge

Mr. and Mrs. Richard Bush
Mr. and Mrs. Alphonse D. Cerasoli
Mr. Howard L. Chertkof
Mr. James P. Connelly
Mr. and Mrs. George Dalton
Mrs. Ruth S. Dreier+
Mr. and Mrs. Maurice M. Felgar
Ms. Rachel E. Finger
Mr. James Flynn
Mr. and Mrs. Glenn A. Francke
Mr. and Mrs. Richard A. Frederick
Mrs. Alice Hansen
Mrs. June Hansen
Mr. and Mrs. Charles Jerele
Mr. and Mrs. William W. Keefer
Mr. Shawn C. Kelley
Mr. and Mrs. James A. Ladish
Mr. and Mrs. David M. Lowe
Mr. Walter Maas
Mr. and Mrs. John J. Marchese
Mr. and Mrs. James G. Marks
Mr. and Mrs. James J. Micale, Jr.
Mrs. Bernadette Moehn
Mr. and Mrs. Frank J. Odill
Ms. Ruth Pallamolla
Mr. Ralph A. Pelton
Mr. and Mrs. Robert Ptaszynski
Mr. and Mrs. Erwin W. Reinke
Mr. and Mrs. Karl G. Roeming
Mr. Joseph E. Schick
Mr. John A. See
Mr. and Mrs. Richard L. Seiders
Mr. and Mrs. Frank M. Sterner
Mr. Richard J. Stevens
Mr. and Mrs. Harold W. Stollberg
Mr. and Mrs. Donald Ullmann
Mrs. Betty Vanderheyden
Mr. and Mrs. Martin Voigt
Mr. and Mrs. Edward J. Warchol
Mr. William W. Winkler
Mr. and Mrs. Lee W. Wolf
Ms. Marguerite Zacher
Mr. and Mrs. Rudolph Zemanovic
Mr. Robert W. Zigman

RUBY

Mr. and Mrs. John A. Abramczyk
Ms. Lynn M. Adams
Ms. Jayne M. Baker
Mrs. Ruth Benduhn
Mr. William V. Benjamin
Mr. Frank J. Berger
Mr. and Mrs. William J. Betz
Mr. and Mrs. Jerome Borowski
Mr. and Mrs. Thomas J. Bretza
Mr. and Mrs. James E. Brisson

Mr. B. V. Brooks
Mr. Harold P. Carrier
Mr. Michael F. Cienian
Mr. William O. Cory
Mr. Melvin Datka
Mr. and Mrs. Anthony J. DePetro
Mr. and Mrs. Edwin Ergen
Mr. and Mrs. Andrew G. Forrest
Mr. Leslie L. Franz
Mrs. Bridget Garavalia
Mr. James A. Garity
Ms. Madeline R. Gianforte
Mr. Glen Haggith
Mrs. Lillian G. Herman
Mr. Arthur J. Hildebrand
Mrs. Patricia Hilliard
Ms. Floretta Holland
Mr. and Mrs. William R. Holmquist
Mrs. Genevieve Horbinski
Ms. Joan A. Jaworski
Mrs. Dorothy Johnson
Ms. Tammy Kaczmarek
Mr. John S. Kennedy
Mrs. Helen J. Kittsley
Mr. and Mrs. Leonard A. Klafka
Mrs. Helen Klement

Mr. Raymond Kolmer
Mrs. Mary Lou Krenz
Mr. Frank C. Kwiatkowski
Mr. and Mrs. Loyal V. LaPlante
Mr. Jack Larson
Mr. and Mrs. Basil Lien
Mrs. Marjorie Lockwood
Mr. Bill H. Loveless
Mrs. Eleanore Majcher
Mr. and Mrs. Joseph T. Mallof
Mr. Walter Martyka
Mr. and Mrs. Glenn L. Mast
Mr. William McClellan
Mr. and Mrs. William R. Meier
Mr. Glenn C. Mertens
Mr. and Mrs. David Meyer
Mr. Ronald Mikrut, Sr.
Mr. Richard M. Miller
Mr. Gerald Moore
Mr. George P. Mueller
Ms. Constance E. Pomeroy
Mr. and Mrs. David L. Precour
Mr. and Mrs. David W. Rendall, Jr.
Mr. Robert A. Rosemurgy
Mr. and Mrs. Thomas Saeger
Mr. and Mrs. Christopher Schimmel

ST. LUKE'S PHILANTHROPISTS CLUB

St. Luke's Philanthropists Club is an honorary membership organization established as a special way of expressing our appreciation to individuals who support the mission of St. Luke's Medical Center with an annual gift of \$100 or more within a calendar year.

EVERY GIFT IS LIKE A PRECIOUS GEM

Annual participation in the St. Luke's Philanthropists Club is designated at the following levels:

Garnet	\$ 100
Emerald	\$ 150
Ruby	\$ 250
Crystal	\$ 500
Diamond	\$1,000
Hanover Society	\$5,000
	and above

For information on membership in St. Luke's Philanthropists Club and the Hanover Society, please call Laverne Schmidt, Office of Philanthropy, (414) 649-7123.

Bold print indicates an increased gift.
+ Deceased

THE GIFT PROGRAMS OF ST. LUKE'S MEDICAL CENTER/OFFICE OF PHILANTHROPY *continued*

Mr. John T. Schlindwein
Mrs. Leone L. Schoen
Ms. Faye F. Schulte
Mr. and Mrs. Raymond R. Schultz
Mr. Darrel G. Scott
Mr. Ray E. Sherman
Mr. and Mrs. Fred J. Stack
Mr. John Stauss
Mr. William G. Stumpf
Mr. and Mrs. Joseph Toth
Mr. and Mrs. Willes J. Traver
Mr. and Mrs. Donald Vander Velden
Mr. and Mrs. Frank S. Vignieri
Mr. and Mrs. Richard W. Voeltner
Mrs. Sally Wade
Mr. Thomas J. Walker
Mr. Melvin C. Welch
Mrs. Dorothy A. Wenzel
Dr. John E. and Rev. Holly Whitcomb
Mr. Steven Whitsitt
Mr. and Mrs. Robert H. Wills
Mr. and Mrs. Robert A. Wulf
Mrs. Helen Zapfe
Mr. A. W. Zillmer

EMERALD

Mr. and Mrs. Wesley Altwies
Mr. and Mrs. Louis J. Amoroso
Mr. and Mrs. Don Bastian
Mrs. Betty Bauldry
Mr. and Mrs. Clyde Bawden
Miss Anna M. Betz

This past August I was married and we had the traditional "dollar dance." We collected the money in my brother's memory on behalf of the Vince Lombardi Cancer Clinic. Our family will always remember the kindness of everyone at St. Luke's Medical Center.

BRIDE AND GROOM
CUDAHY, WISCONSIN

Mr. and Mrs. Harvey J. Bingen
Ms. Patricia A. Bladow
Mr. Frank J. Blau
Mr. David Calandra
Mr. and Mrs. John L. Call
Mr. Frank J. Chamernik
Matched by Abbott Laboratories
Mr. Charles F. Christenson
Dr. and Mrs. Donald G. Chzran
Mr. J. Marshall Cobourn
Mr. and Mrs. Leslie Cowen

Mr. W. B. Hughes
Mr. and Mrs. William J. Hussli
Mr. and Mrs. Bernard Huth
Mr. Anthony J. Irek
Mr. Victor O. Italiano
Mr. Charles F. James, Jr.
Mr. and Mrs. Robert F. Janke
Ms. Shirley K. Jensen and
Mr. Robert Bremer
Mr. and Mrs. Robert A. Johnson
Ms. Janet J. Jones
Mr. and Mrs. Donald Jorgensen

Mr. and Mrs. Robert L. Cowles
Mrs. Winifred Davis
Mr. and Mrs. Eugene M. De Clerck
Mr. George Debellis
Mr. and Mrs. Dale Del Ponte
Mr. and Mrs. Carl Dentice
Mr. Allison Diebels
Mr. and Mrs. Alfred A. Drosen
Mr. and Mrs. Donald D. Duncan
Mr. and Mrs. Ralph Dunkert
Mr. and Mrs. Walter W. Dusold
Dr. and Mrs. Johann L. Ehrenhaft
Mr. Ohannes Esmerian
Mrs. Melvina Feest
Mr. James J. Fischer
Mr. and Mrs. Philip Fisher
Mr. and Mrs. Duane J. Gannon
Mr. and Mrs. Gary L. Gass
Mr. Karl F. Gengler
Mrs. Eileen J. Gorzalski
Ms. Marion E. Gratz
Mr. and Mrs. Hugh W. Greathouse
Dr. and Mrs. Herbert M. Gross
Matched by Abbott Laboratories
Ms. Carolyn J. Grunewald
Mrs. Jill Guentert
Mr. and Mrs. Howard Gygas
Ms. Marjorie A. Hawkins
Mr. and Mrs. Raymond D. Heitkemper
Mr. Howard P. Herrmann
Mr. Jaren E. Hiller
Mrs. Shirley Hintz
Mr. and Mrs. Ronald Hryniewicki
Mr. Robert Huetiger



John J. and Frances Jaeger

Mr. and Mrs. Kenneth L. Jorgensen
Matched by Sundstrand Corporation Foundation
Msgr. Eugene J. Kapalczynski+
Mr. and Mrs. Raymond Klacan
Mr. and Mrs. Edward Klinger
Mr. James E. Kobza
Mrs. Dorothy Koepsel
Mr. Philip S. Kola
Mr. and Mrs. Raymond A. Kowalske
Mr. Ronald Laurent
Mr. Robert C. Lawler
Mrs. Elsie M. Legrand
Mr. and Mrs. Earl G. Leigeb
Mr. Kenneth Lessard
Mr. and Mrs. Richard G. Lock
Mr. and Mrs. Kenneth Loomis
Mr. and Mrs. Robert E. Luebke
Mr. and Mrs. Donald Meneau
Mr. and Mrs. Jerome Merkel
Mr. and Mrs. George R. Moritz
Mr. and Mrs. Milton Morris
Mr. and Mrs. Christopher A. Mutschler
Mrs. Phyllis Nault
Mr. Kenneth Nelson
Mr. and Mrs. Leonard A. Nowacki
Mr. Raymond L. Panzer
Mrs. Dorothy M. Paplaczky
Mr. Charles E. Pendock
Mr. and Mrs. Harold C. Powers
Miss Dorothy M. Raasch
Mr. and Mrs. Myron J. Raasch
Mr. and Mrs. Walter H. Rahn
Matched by Abbott Laboratories
Dr. David A. Rein and Dr. Beth A. Derfus
Mr. and Mrs. Paul W. Repp
Mr. and Mrs. Michael D. Rosen
Mr. and Mrs. Floyd E. Rosenquist
Mr. and Mrs. Michael Sablich
Matched by Quad/Graphics
Mr. and Mrs. Helmut Sawall
Mr. and Mrs. Lawrence Scavarda
Mr. and Mrs. Charles L. Schick
Mr. and Mrs. Leonard A. Schilz

Mr. John P. Schmitt
Mr. and Mrs. Raymond Schueffner
Mr. and Mrs. Gerald A. Sciascia
Mr. and Mrs. Leonard E. Sloane
Mrs. Joyce F. Steinmann
Mr. John E. Stinchfield
Mr. and Mrs. Ray Strehlow
Mr. and Mrs. D. B. Stroud
Mr. Willis W. Stubbe
Mr. Leonard J. Susalla
Mrs. Juanita Teising
Mr. and Mrs. Allan Thorpe
Ms. Margaret R. Tomczyk
Mr. Paul E. Toon
Mr. and Mrs. Albert Treland
Mr. and Mrs. Walter Troppmann
Mr. and Mrs. William D. Trotter
Mr. and Mrs. Floyd A. Webb
Mrs. Alvena E. Wernsman
Mr. and Mrs. Joseph F. Whitney
Mrs. Kathleen Wickert
Mr. Richard Wilton
Mr. Robert B. Wise
Mr. and Mrs. James Wojcehowicz
Mr. and Mrs. Don Wood
Mr. and Mrs. Norbert P. Worzala
Mrs. Jean Zacharski
Mr. Anthony J. Zekich
Mr. Maylnn T. Zisk

GARNET

Anonymous
Mrs. Helen Aasen
Ms. Joanne M. Abramovich
Mr. and Mrs. Marvin D. Accetta
Mr. and Mrs. Ernest L. Alexander
Mr. and Mrs. Andrew F. Allen
Mr. and Mrs. Kenneth R. Allen
Mr. James Amberger
Mrs. Delores Anderson
Mr. and Mrs. Jack L. Anderson
Mr. and Mrs. Norbert M. Anderson
Mr. Paul Anderson
Mr. R. J. Anen
Mr. and Mrs. Frank J. Angelos

Bold print indicates an increased gift.
+ Deceased

THE GIFT PROGRAMS OF ST. LUKE'S MEDICAL CENTER/OFFICE OF PHILANTHROPY *continued*

Ms. Gerianne Asti
Mr. and Mrs. Peter R. Bachmann
 Mr. and Mrs. Joseph Baef
 Mrs. Mary Baer
Matched by Cooper Industries Foundation
 Ms. Laurie S. Balistreri
 Mr. and Mrs. George S. Baritt
 Mr. and Mrs. Bernard T. Barrett
 Mr. Frederick A. Barrington
 Mrs. Constance K. Barry
 Mr. Peter E. Barry
 Mr. and Mrs. C. Scott Bartlett, Jr.
 Mrs. Rose M. Bartolotta
 Mr. and Mrs. Robert O. Baumgart
 Mrs. Elnor L. Baxter
 Ms. Kathleen A. Bebeau
 Mr. Johann Beck
 Mr. Albion O. Behrens
 Mr. John P. Bell
 Mr. and Mrs. Eugene C. Belscamper
 Mr. and Mrs. Ervin Benish
 Mr. and Mrs. Edwin Benkowski
 Mr. and Mrs. Johannes Berndt
 Mr. and Mrs. Jeffery A. Beyer
 Mrs. Genevieve Biskup
 Mr. and Mrs. Vaso Bjegovich
 Mr. Richard Blankenheim
 Mr. and Mrs. William Blue
 Mr. and Mrs. Harold A. Bobrofsky
 Mr. and Mrs. Richard Bodin
 Mrs. Loraine Borck
 Mr. William T. Born
Mr. and Mrs. Harold Bradley
 Mr. and Mrs. Robert L. Brandenburg
 Mr. and Mrs. Frank M. Brandis
 Mr. Curtis Brandt
 Mr. and Mrs. Leo J. Breirather
 Mr. and Mrs. John E. Brilla
 Mr. and Mrs. David E. Brittain
 Mr. Jay H. Brost
 Mrs. Loretta Brown
 Ms. Elayne A. Bruder
Mr. Harvey W. Brunsch

Mr. Dan Brusslan
 Mr. and Mrs. Thomas A. Budnik
 Mr. and Mrs. Leonard C. Budnowski
 Ms. Anne Bukolt
 Mr. and Mrs. Edward P. Bullock
 Mrs. Jean B. Burke
 Mr. and Mrs. Lawrence Burton
 Judge and Mrs. Robert C. Cannon
 Ms. Therese Castiglioni and
 Mr. James H. Klick
 Mr. and Mrs. Ken Christopherson
 Mrs. Anita Chudnow
 Mr. Stephen Cibra
 Mr. Martin C. Connelly
 Ms. Annelise Cooney
 Mr. Orville Copoulos
 Mrs. Marion Crawford
 Dr. William Crowley
 Mr. and Mrs. Alexander Crowther
 Mr. John R. Cullen
 Mr. Thomas R. Curzon
 Mr. and Mrs. John Damkot
 Ms. Clara J. Daniels
 Ms. Mary Jane Davidson
 Mr. and Mrs. Oliver R. De Groot
 Ms. Marlene DeBraal
 Mr. and Mrs. Herbert C. Devine
 Mr. and Mrs. Conrad Dietz
 Mr. and Mrs. Leonard Ditsworth
 Mrs. Lois Doolittle
 Ms. Lorraine Dubanewicz
 Mrs. Darlene Dworak
Miss Camille Dziubek+
 Mr. Milton Einsteadig
 Ms. Gertrude Eisenzopf
 Mr. and Mrs. Harold G. Elfner
 Mr. and Mrs. Robert H. Ellis
 Mrs. Mary Elizabeth Ellison
 Mr. and Mrs. John F. Erickson
 Mr. Roberto W. Esteves
 Mr. Guy Ewing
 Mr. James Faytis
 Mr. and Mrs. Paul Feuling
 Mr. and Mrs. Adrian J. Fitzhonts

I want to thank all the wonderful people who cared for my mother during her cancer illness. Everyone was so supportive and compassionate, and mom really appreciated what everyone did to make her feel comfortable. We love all of you; God bless each and every one.

GRATEFUL FAMILY
 MILWAUKEE, WISCONSIN

Miss La Verne Flach
 Mr. and Mrs. John G. Fleckenstein
Matched by Philip Morris Companies
 Mr. and Mrs. Charles Fojtik
Mrs. Patricia R. Foley
 Mr. and Mrs. Dennis W. Folkman
 Mr. and Mrs. Ernest E. Force
 Mr. and Mrs. John R. Frank
 Mr. Stanley J. Fredericks
 Mrs. Dorothy H. Freihube
 Mr. Gardner L. Friedlander
 Mr. and Mrs. Matthew Fritz
 Mr. George Gallepp
 Mr. and Mrs. Felix Gallo, Jr.
 Mr. and Mrs. Paul W. Ganiere
 Mr. and Mrs. William P. Gano
 Mr. and Mrs. Richard Garber
 Mr. and Mrs. Walter R. Gartman
 Ms. Joyce A. Gass
 Mr. and Mrs. Robert M. Gaulke
 Mr. and Mrs. Phillip Gerbert
 Mrs. Joan L. Geshay
 Mr. Karl Gierhahn
 Ms. Barbara Ann Gilles
 Ms. Lenore Gillig
 Mr. and Mrs. Randall Godsey
 Mrs. Jeanette L. Goebel
 Mr. and Mrs. Charles Gorzalski
 Mr. and Mrs. David Gorzalski
 Mr. and Mrs. Richard J. Graybar
 Mr. W. James Grebe
 Mrs. Grace E. Greenman
 Mrs. Arlene A. Griep
 Mr. and Mrs. John Grissmeyer
 Ms. Maria J. Gross
 Mr. Reginald Grover
 Mr. Jerome L. Grummel
Dr. and Mrs. Thomas Gullick
 Mr. and Mrs. John Haita
 Mrs. Patricia Ann Hamilton
 Mr. Edward J. Hammer
Mr. and Mrs. Norman H. Hammetter
 Mr. and Mrs. Robert T. Hanschman
 Mrs. Betty Harder
 Mr. Chester T. Harrison, Jr.
 Mrs. Elizabeth Harter
 Mr. and Mrs. Gerald C. Hay
 Mr. and Mrs. Eugene J. Hayman
 Mr. and Mrs. Cornelius Heffernan

Mr. Edward M. Heffner
 Mr. and Mrs. Douglas M. Helgerson
 Mr. and Mrs. Carl W. Henrichson
 Mr. and Mrs. Russell S. Henry
Mr. and Mrs. Lawrence J. Hilgart
 Mrs. Ruth Hilrich
 Mr. Carl G. Hinman
 Mr. and Mrs. Arthur Hoberg
 Mr. and Mrs. Don L. Holem
 Mr. and Mrs. Russell Holmes
 Mrs. Julius L. Hopfensperger
 Mrs. Carole F. Houston
 Mr. Maurice J. Hovland
 Mr. and Mrs. Lee R. Hribar
 Mr. Gerald F. Hubbard
 Mr. and Mrs. Sam Huibregtse
 Mr. Ray Ignatowski
Mrs. Faye Jacobs
 Lt. Col. Norman L. Jacobson
 Mrs. Louise Jaeckels
 Mr. and Mrs. Daniel E. Jakubowski
 Ms. Marian R. Jamnik
Matched by Rexnord Corporation
 Mr. and Mrs. V. Bruce Janius
 Mr. James M. Jankowski
 Mr. and Mrs. Symphorian Januszewski
 Mrs. Joyce G. Jaquith
 Mr. and Mrs. Dennis E. Jenkins
 Mr. and Mrs. William T. Jens
 Mr. and Mrs. Arthur Jeske
 Mr. Samuel Johns
 Mr. and Mrs. Peter F. Jones
 Mr. Robert J. Jurci
Mrs. Mary Ann Jurkowski
 Mrs. Eleanore K. Kaiser
Mr. and Mrs. Vernon T. Kaminski
 Mr. and Mrs. Harold Kammerer
 Mr. Edward G. Kasprzak+
 Mr. and Mrs. Albert C. Kasulke
Mrs. Kathleen Kasza-Shaw
Mr. Richard Kazmierczak
 Mr. and Mrs. Walter M. Keippel
 Mr. and Mrs. Alysious J. Keller
 Mr. Jack W. Kellner
 Mr. and Mrs. Raymond M. Kendzierski
 Ms. Sandra Kincaid
 Ms. Pelagia Kingl
 Mr. Tom Kintis



Jeanette Fiolich and Pearl Reupert

Bold print indicates an increased gift.
 + Deceased

THE GIFT PROGRAMS OF ST. LUKE'S MEDICAL CENTER/OFFICE OF PHILANTHROPY *continued*



Karm Cromwell and Alice Horton

Mr. and Mrs. Walter F. Kirkland, Jr.
 Mr. and Mrs. Pat J. Kline
 Mr. David R. Kling
 Mr. Larry M. Klug
 Mr. Thomas C. Kmiec
 Mr. Ronald A. Kmiecik
 Mr. Harold Kmiecik
 Mrs. Harriet T. Knudson
 Mr. Leroy Koehler
Mr. and Mrs. Charles R. Koenes
 Mr. and Mrs. Abe Kogan
 Mr. and Mrs. Daniel J. Kolb
 Mr. and Mrs. Glenn R. Kolbow
 Mr. and Mrs. Joseph Koneczka
 Mr. and Mrs. Gerald E. Kosharek
 Mr. and Mrs. Roger V. Kotz
 Ms. Lorraine Kovac
 Mr. and Mrs. Gordon Kowalski
 Mr. Ted Koziol
Mr. and Mrs. Arthur B. Kozminski
 Mr. Otis Krebs
 Mr. and Mrs. Arnold G. Krenzke
 Ms. Judy Krepsky
 Mrs. Elizabeth J. Kress
 Mr. Gary P. Krumel
 Mr. and Mrs. Thaddeus R. Kucharski
 Mr. Harold Kuckkan
 Mr. and Mrs. Michael Kuepper
 Mr. and Mrs. Edward H. Kukuk
Mr. and Mrs. John Kukuwich, Jr.
 Mr. and Mrs. Karl Kumpel
 Mr. Edward Kurylo
 Mr. William D. Kyle
 Ms. Nancy Ann Ladwig
 Ms. Deborah Lang
 Ms. Kristina Lang
 Mr. and Mrs. Robert J. Lang
 Mr. Clarence F. LaPinske
Mr. David Lassa
Ms. Genevieve B. Latus
 Mr. William Leachy
 Mrs. Billie Lee
 Mr. and Mrs. Wayne W. Lehman, Sr.
 Mrs. Eugene W. Leicht
 Mr. and Mrs. John H. Leick

Mrs. Susan A. Lesperance
 Ms. Eileen Lewin
 Mr. and Mrs. George W. Liberatore
 Mr. Joseph J. Lingle
 Mr. Chester C. Link
 Mrs. Harriet Llewellyn
 Mr. Peter Lobenhofer
 Ms. Maureen Longcor
 Mr. and Mrs. Robert D. Love
 Mr. Leslie L. Ludtke
 Mr. and Mrs. Wilton M. Lundberg
Mr. Walter J. Maass
 Mr. and Mrs. Gerald B. Maciolek

The employees of EOG Environmental, Inc. collected this money as a Christmas gift and wish to forward it to the Vince Lombardi Cancer Clinic at St. Luke's.

COMPANY EMPLOYEES
 MILWAUKEE, WISCONSIN

Mr. and Mrs. Robert Makal
 Mr. Bertrand H. Mallison
Mrs. Loraine Marino
 Mr. Rodney G. Martin
Msgr. Richard A. Maufort
 Mrs. Mary M. Maxham
 Mr. John F. McCune III
 Ms. Dolores E. McGuire
 Mr. and Mrs. Pat McIntosh
 Mrs. Helen S. McMillan
 Mrs. Mary Ann McNicol
 Mr. and Mrs. Jack J. Medved
 Mr. and Mrs. S. K. Mehta
 Mr. and Mrs. Donald M. Meier
 Mr. and Mrs. Earl A. Meinen
 Mr. and Mrs. Lawrence J. Michalets
 Mrs. Adeline M. Michna

Mr. David M. Mikrut
 Mr. Elmer J. Millette
 Mr. and Mrs. Frank J. Milz
 Ms. Alice B. Mirkowski
 Mr. and Mrs. Leo J. Miron
 Mr. Charles E. Morgan
 Mr. and Mrs. Ronald J. Morgan
 Mr. and Mrs. Daniel Morrical
 Mrs. Estelle K. Moses
 Randy and Cheryl Moss

Matched by AXA Foundation

Mr. and Mrs. Eugene J. Mueller
Mr. and Mrs. Ralph H. Nabak
 Mr. and Mrs. James F. Nader
 Mr. and Mrs. Ralph Nadolinski
 Mrs. Mary M. Nault
 Mr. and Mrs. George Nehrbass
 Mr. DeWayne Nehs
 Mr. and Mrs. Charles S. Newton
 Mrs. Susan A. Niederjohn
 Mr. and Mrs. Arthur F. Niquet
 Mr. and Mrs. Glen Nordin
 Dr. and Mrs. Victor I. Nwagbaraocha
 Mrs. Judith O'Hair-Regan
 Ms. Janis G. Oleszak
 Mr. and Mrs. Robert M. Olive
 Mr. John O'Meara
 Mr. and Mrs. Robert P. O'Meara
 Mr. Thomas G. Ottavi
 Mrs. Marguerite Otto
 Mrs. Helen M. Owens
 Mr. and Mrs. Phillip M. Parisi
 Mr. and Mrs. Elden Parkkonen
 Mrs. Junette C. Pederson
 Mr. Roger Peelen
 Mr. Jerome Peters
 Mr. and Mrs. Oswald E. Peters
 Ms. Marian E. Peterson
 Mr. Frank A. Petta
 Mr. Harold Pfrang
 Mrs. Ruth E. Phelps
 Dr. James M. Pickerill
 Mr. and Mrs. William Piper

Matched by Bucyrus

International Foundation, Inc.
 Mrs. Margaret F. Ploskee

Mr. and Mrs. Arnold A. Polisky
 Mr. and Mrs. Leon Polites
 Mr. and Mrs. William E. Preston
 Miss Ora Quandt
 Mr. Joseph R. Quickel
 Mr. and Mrs. Owen N. Rabourn
 Mrs. Rosemary Race
 Mr. and Mrs. Albin P. Radaj
 Mr. Frank J. Reidhauser
 Mr. Fred M. Reimer
Mrs. Lillian J. Repa
 Mr. and Mrs. Bill H. Richards
Mrs. Donna L. Riley
 Mr. and Mrs. James Rindfleisch
 Mr. and Mrs. Leslie N. Roberts
 Mr. Eugene J. Roethle
 Mr. Wallace Rogers
 Mr. George A. Roth
 Ms. Beth Rudell
 Mr. Milton M. Rusch
 Mrs. Patricia Russart
Mr. Ralph D. Rutkowski
 Mr. Leroy W. Sackman
 Mr. and Mrs. Rudolph Safarik
 Mr. Rodney Salzwedel
 Mrs. Evelyn Sammarco
 Mr. Roberto Sandolo
 Mr. Roger W. Schaus
 Mr. Joseph A. Scheinkoenig
Mr. Ernest C. Scheitel
 Mr. and Mrs. Emerich Schenk
 Mr. and Mrs. Robert Schlemm
 Mr. John C. Schlosser
 Dr. Terence and Dr. Karen Schmahl
 Mr. and Mrs. Arlon Schmidt
 Lt. Col. and Mrs. Howard B. Schmidt
 Mr. and Mrs. John Schmidt
 Mr. and Mrs. Alan W. Schneck
 Mr. and Mrs. Fritz W. Schneider
 Dr. Walter H. Schneider
 Mr. Leroy M. Schroeder
Mr. Howard R. Schultz
 Mr. and Mrs. Walter R. Schultz
 Mr. and Mrs. Quentin J. Schumacher
 Mr. and Mrs. Howard J. Schwartz
 Mr. Jack P. Schwellinger



John and Marian Stretch

Bold print indicates an increased gift.

+ Deceased

Thank you
for your generosity
throughout the year.

*May all that is
precious to you
be yours this
holiday season.*

St. Luke's Office of Philanthropy

THE GIFT PROGRAMS OF ST. LUKE'S MEDICAL CENTER/OFFICE OF PHILANTHROPY *continued*

Mr. and Mrs. Henry P. Schwinn
 Mr. Leroy Schwinn
Mr. Albert Sharpless
 Mr. and Mrs. Donald Shore
 Mr. and Mrs. Bert T. Sjoström
 Mr. and Mrs. Dale H. Slaasted
 Mr. Arthur O. Smith
 Mr. and Mrs. Donald L. Smith
 Mr. and Mrs. William D. Snarski
 Mr. and Mrs. Jay Soley
 Ms. Phyllis C. Sonntag
 Ms. Mary Ann Sosnowski
 Mr. and Mrs. Clayton H. Squires
 Mr. and Mrs. Joseph J. Stanis
 Mr. and Mrs. Ralph R. Staven
 Mr. Anthony W. Stavish, Sr.
Mr. and Mrs. Samuel J. Steffan
 Mr. E. Stony Steinbach
 Ms. Patsy L. Steinbach
Mr. and Mrs. Robert J. Steininger
 Mr. and Mrs. Edward M. Stevens
 Mr. and Mrs. Ervin A. Stolz
 Dr. and Mrs. Richard H. Strassburger
 Mr. and Mrs. John W. Stretch
 Ms. Helen Stringer
 Mr. Leonard R. Strzelecki
 Mr. William E. Stuart
 Mr. and Mrs. Donald Sturvist
 Mr. and Mrs. Ed A. Sturzl
 Mr. Richard Swessel
 Mr. and Mrs. Ray D. Szalacinski
 Mr. and Mrs. George F. Szostak
 Mr. Robert A. Teper
 Mr. and Mrs. Peter L. Thompson
 Ms. Marcia Thurnbauer and
 Mr. Scott Jonovic
 Mr. Fred Tietzen
 Mrs. Mildred Tinker
 Mr. Tony J. Torcivia
 Mr. Joseph Trapp
 Ms. Caroline J. Trester
 Mr. and Mrs. Robert D. Troudt
 Mr. and Mrs. Richard Tuskiewicz
 Mr. Daniel L. Tuszynski
 Mr. and Mrs. Robert J. Van Lanen

Ms. Gloria J. Venski
 Mr. and Mrs. Robert E. Victor
 John and Linda Visek
 Mr. Alan R. Voss
Mr. Jules F. Wachs
 Mr. John L. Wade
 Ms. Gladys E. Wagner
 Mrs. Patricia Waletzko
 Mr. and Mrs. F. Douglas Walker
 Mr. and Mrs. Clyde G. Wallenfang
 Mr. and Mrs. Robert W.
 Wallschlaeger
 Ms. Cathy Walters
 James R. Warsh, M.D.
Mr. Charles J. Wasserman
 Ms. Diana R. Watson
 Mr. Anthony F. Wawrzyniak
 Mr. Durand E. Weiler
 Mr. and Mrs. Clinton D. Welch
 Mrs. Margaret H. Wells
 Mr. and Mrs. William Wenger
Mrs. Evelyn R. Wenzel
 Mr. and Mrs. Ray J. Werner
 Mr. and Mrs. Edwin C. Whiteman
 Mr. Cary B. Wiger
 Mr. and Mrs. Jerome E. Wild
Mr. and Mrs. Ronald E. Will
 Mr. and Mrs. Matthew Winn
 Ms. Eleanore M. Wirfs
 Mr. John W. Wirtz
 Mr. and Mrs. Archie Wise
 Ms. Evangeline Wiskowski
 Mr. and Mrs. Peter J. Witt
 Mrs. Bonnie Jean Wolfram
Mr. and Mrs. Harold E. Wright
 Mr. John S. Wright
 Mr. and Mrs. Frank J. Wrzeski
 Mr. and Mrs. Alfred Wunsch
 Mr. and Mrs. Fredric R. Yopps
 Mr. and Mrs. Paul Zak
 Ms. Lauren C. Zarder
 Mr. Robert J. Zeit
 Mr. and Mrs. Albert Zeleske
Dr. and Mrs. Gerald J. Ziebert
 Mr. and Mrs. Ralph Zimmerman



Lee and Mary Angert

We are most grateful for the excellent care and concern shown to our father and husband and to our family by the cardiac intensive care unit staff. The nurses, doctors and other support staff offered words of encouragement and provided quality care. Their knowledge is commendable. We are very thankful that they helped us during our father's illness. God bless each and everyone of them.

GRATEFUL FAMILY
 OAK CREEK, WISCONSIN



William G. Stumpf and Lois and Richard Anderle

Bold print indicates an increased gift.
 + Deceased

PARTNERS IN HEALTH (GIFTS UNDER \$100)

St. Luke's Medical Center is very grateful to our donors whose contributions help carry on the St. Luke's mission. Their many gifts provide the support necessary to continue in our efforts to provide quality health and patient care to those we serve.

EMPLOYEE PHILANTHROPY CLUB

GIFTS RECEIVED JANUARY 2001 THROUGH SEPTEMBER 2001.

Anonymous (2)	Ms. Linda Cottreau	Mr. and Mrs. William Haase	Ms. Amy Kopp
Ms. Patricia Abella	Mr. Richard Crooke	Ms. Audrey Hafeman	Ms. Rose Ann Kowitz
Ms. Terri Adams	Mr. and Mrs. Michael R. Cummings	Ms. Susan Hafemann	Mr. Michael Kraft
Mrs. Sharon Akey	Mrs. Kathryn Jo Curtin	Ms. Margaret Haferman	Ms. Alice Kramer
Ms. Helen Albanese	Mr. and Mrs. David Czecholinski	Ms. Denise Hagen	Ms. Cheryl Krebsbach
Mr. Brent Aleshire	Ms. Lila Daut	Ms. Sally Hahn	Ms. Judith A. Krieger
Ms. Marcia Ali	Ms. Sally De Vriend	Ms. Susan Hajducki	Ms. Barbara Krug
Dr. J. Joseph Allen	Ms. Tracy Delfield	Mrs. Kathleen Halkin	Mrs. Judith Lackner
Mr. and Mrs. Mark Ambrosius	Mr. Robert E. Desjarlais	Ms. Debra Hall-Kind	Ms. Leann Lagerman
Mr. Alfred Anderson	Ms. Kay Dieringer	Mrs. Joanne M. Halverson	Ms. Catherine Lake
Ms. Jeanne Anderson	Ms. Janet Doern	Ms. Barbara Hannes	Ms. Patricia Landergott
Ms. Karen Anderson	Mr. Rodney Dole	Ms. Lisa Hannes	Mr. Lee Lansinger
Ms. Anita Andrzejewski	Ms. Carol Dombrowski	Ms. Carolyn Hansen	Mr. Jason LaVake
Ms. Mary Angert	Mr. Dale Dornacker	Ms. Mary A. Hansen	Ms. Linda Leach
Ms. Pamela Aoy	Mrs. Helen Downie	Ms. Margaret Hanson	Ms. Susan Leffelman
Mr. David Arnold	Ms. Sheila Drewel	Mrs. Lois H. Harrison	Chaplain and Mrs. Eugene Leffingwell
Ms. Helen Atkinson	Mr. Bret Duchateau	Ms. Joan Heimler	Ms. Dianne Lezotte
Ms. Donna Babcock	Mrs. Jeanne DuPont	Mr. Timothy Heyse	Ms. Mary J. Libby
Ms. Margaret Babcock	Ms. Coleen B. Dusold	Ms. Kathryn Hien	Ms. Katherine Liberacki
Mrs. Marlene Baldikoski	Ms. Nancy Duthie	Ms. Mary Jo Hintz	Mr. Kennedy Lightfoot
Mr. Dennis Balsewicz	Ms. Dorothy Eastman	Ms. Pamela J. Hintz	Ms. Laurie Ligoeki
Ms. Jill M. Barrett	Mr. John Michael Eaton	Jon and Mary Lou Hoffmann	Ms. Barbara Linton
Ms. Marie Barrett	Ms. Judy Ehlenfeldt	Mr. Randy Hoffmann	Ms. Alla Lisak
Mr. Steven Belanger	Ms. Diane Ekstrand	Mr. Brad Holmes	Mrs. Kristine Lobotzke
Ms. Michelle Belmore	James and Claire Elsesser	Ms. Lorraine Holtz	Ms. Rebecca Long
Mr. Joseph Bena	Mrs. Julie Ewert	Ms. Valerie Holzman	Mr. Francisco Lopez
Ms. Jennifer Bernard	Mr. Thomas A. Ewing	Ms. Mary Hook	Ms. Susan Lorenz
Ms. Beth Betts	Ms. Sandra Falkowski	Mr. and Mrs. Donald Horack	Ms. Angela Lotz
Ms. Patsy Bichanich	Ms. Sharon Falque	Mr. and Mrs. G. Edwin Howe	Mr. William Love
Ms. Lora Biddle	Ms. Joyce Favre	Ms. Dona L. Hutson	Ms. Susan Luedtke
Ms. Debra Biggins	Mrs. Judith L. Fellows	Ms. Jean Jacobs	Ms. Linda Lundin
Ms. Heidi Bishop	Ms. Frances Fera	Ms. Tracie A. Jacobs	Ms. Pamela Lyon
Ms. Ellen E. Bladorn	Mrs. Mary K. Fields	Ms. Sandra Janeczko	Ms. Elisabeth Magnus
Ms. Gloria Boelter	Mr. Robert L. Fields	Ms. Deborah Janke	Ms. Cynthia Mahlberg
Mr. John Borowski	Ms. Cynthia Finger	Ms. Jaime Jenjak	Mr. Anthony Marek
Mrs. Joann Boulton-Walton	Mr. Michael Fitzgerald	Ms. Donna B. Jennings	Ms. Diane M. Marek
Ms. Patricia Bowen	Ms. Julie Fohr	Mr. Lee Jeske	Rev. Marcia Marino
Ms. Eileen Braeger	Ms. Julie Fox	Ms. Lynn Johnson	Ms. Linda Marolt
Mr. Dennis Brierton	Mr. Stephen Francaviglia	Mr. Neal Johnson	Ms. Donna Marszalkowski
Ms. Karla Brish	Ms. Laurie L. Frank	Mr. Craig Jones	Ms. Carol Martin
Ms. Katie Brown	Ms. Karen Frederick	Ms. Jane Jones	Ms. Deborah Martin
Ms. Karen Brubakken	Ms. Marjorie Frinzi	Mr. James Jopek	Ms. Kathryn Mather
Mrs. Mary Bruders	Ms. Vicky L. Gallagher	Mrs. Zora Jovanovic	Ms. Kristin M. Mathison
Ms. Patricia Brys	Ms. Maria Garcia	Mrs. Pauline Judy	Ms. Tequila Matthew
Ms. Marie D. Brzezinski	Ms. Barbara Garnier	Mr. Thomas Kandarapally	Ms. Sharon Matyas
Dr. Jane Bubik	Mr. Jeffrey Gavitt	Ms. Janet Keepers	Ms. Ann Matz
Ms. Linda Buck	Ms. Vicki George	Ms. Cynthia Kennedy	Ms. Pat McGinnis
Ms. Laura Burke	Ms. Cari Giles	Ms. Rosalee Keser	Ms. Paula McKean
Ms. Madeline Burt	Ms. Patricia Givens	Ms. Carol Kesery	Ms. Linda L. McKinney
Ms. Gail Butz	Ms. Christine Glad	Mrs. Cathleen C. Kinnick	Ms. Siobhan McMahon
Ms. Connie Caiati	Mrs. Kristen Gleesing	Ms. Carol Kitzrow	Ms. Wendy S. Medlock
Ms. Roberta Carlson	Ms. Kathleen Goudie	Ms. Sandra Klafke	Ms. Julie Meloy
Ms. Martha Castillo	Ms. Judith Granatella	Mr. and Mrs. Richard Klein	Ms. Angela Mengelt
Ms. Candace Caylor	Ms. Rachel Gresk	Mr. Brian A. Kling	Ms. Sandra Menting
Ms. Patricia Celek	Ms. Therese Greysen	Ms. Pauline Klinkosh	Ms. Mary Jo Merwin
Mr. Paul Charles	Ms. Kathleen Griebenow	Ms. Katherine Kloecker	Ms. Barbara Meyrose
Ms. Mary Chaudoir	Ms. Jackie L. Grigg	Ms. Lori Knight	Ms. Jean Michalek
Ms. Maryann Cierzan	Ms. Kathleen Groth	Mr. Eric Knutson	Ms. Jadwiga Michelus
Ms. Mary Cieslak-Duchek	Ms. Heidi Grow	Ms. Cathy Kobylinski	Mr. Michael Middlemas
Mr. and Mrs. Michael Connor	Ms. Linda J. Grulke	Ms. Kathleen Kochanski	Ms. Margaret Mihm
Mr. Larry Conrad	Mrs. Barbara Haag-Heitman	Mr. Gary Koepke	Ms. Mary Milan
Ms. Jacqueline Coons	Mrs. Patricia M. Haak	Ms. Cynthia Kollauf	Ms. Doris Miles
Ms. Jennifer Cooper		Mr. Andrew Kontowicz	

WHY I GIVE:

IT'S IN THE FAMILY

The Jones family works together and gives together. Craig Jones, who has worked for St. Luke's for the past 16 years, joined the Employee Philanthropy Club with encouragement from his sister, Michelle.

Craig currently works as an interventional vascular technician in the Intervention and Radiology department, where he assists doctors with procedures such as catheterizations and angioplasties. "I enjoy the hands-on work with doctors and patients, being involved with patient care" says Craig.

According to co-worker Mike Farrell, Craig's generous spirit shines at St. Luke's and beyond. "He's an outstanding, giving person, inside and outside. He's always willing to go the extra mile to ensure a patient's overall comfort throughout the hospital stay," says Mike. This dedication to excellence has won Craig several employee awards recognizing extra effort beyond assigned job responsibilities.

Supporting St. Luke's is a family affair. Michelle Jones, Craig's sister, is a manager in the Aurora business office and previously served on St. Luke's Employee Philanthropy Club committee.



Craig Jones (above) finds membership in the St. Luke's Employee Philanthropy Club a family affair.

Pictured at left (from left to right) are Craig's sister Michelle, his mother Maureen, and his wife Lynne.

Craig's mother, Maureen, recently retired from her position as a health unit coordinator. And last, but certainly not least, Craig's wife Lynne works as a financial counselor, helping uninsured or self-pay patients enroll in public medical care programs.

"St. Luke's has for such a long time, and continues to be, a leader in heart care. Without programs like the Employee Philanthropy Club, it's hard to stay on the cutting edge of technology," says Craig. With the help of dedicated employee donors like the Jones family, St. Luke's will remain a leader in health care. *S*



EMPLOYEE PHILANTHROPY CLUB *continued*

Ms. Joan Miller
Ms. Penny Miller
Ms. Pamela Minzlaff
Mrs. Suzanne Mirenda
Ms. Geraldine Mitchell
Ms. Laura L. Molleson
James and Diane Moraza
Ms. Mary Moritz
Ms. Nancy Naus
Marvin and Cindy Nawrocki
Mrs. Carol Nelson
Ms. Shirley Nelson-Kocol
Ms. Kathleen Nesseth
Ms. Mary M. Neumann
Mrs. Sandra Noel
Mrs. Kimberley Nordby
Ms. Diane O'Donnell
Dr. Martin Oaks
Ms. Adela Obradovich
Ms. Liesel A. Oechsner
Mr. Steve Ohly
Mrs. Christine Olson
Ms. Christine Orłowski
Mr. Robert J. Ottoson
Ms. Linda Palmer
Mrs. Kathleen Pape
Mr. Bruce Parker
Ms. Peggy Parker
Ms. Jane Parthum
Ms. Darlene Parworth
Ms. Sharon Paulson
Mrs. Margaret Pazucha
Ms. Sandra Pelczynski
Ms. Jeannine Perushek
Ms. Lou Ann Pluta
Ms. Becky Pogacar
Ms. Sandra Poska
Mrs. Patricia Posselt
Ms. Debra Printz
Ms. Janice Przybylski
Ms. Catherine Ptak
Ms. Julie Raaum
Mr. Rade Radich
Ms. Judith Radish
Ms. Sharon Radloff
Ms. Diane Ramski
David and Neva Reimer
Ms. Vicky Reith
Ms. Marlea Renk
Ms. Janet L. Rewolinski
Ms. Paulette Risley
Ms. Shelley Robakowski
Ms. Shelley R. Robles
Ms. Joy M. Rodriguez
Ms. Diana Rohloff
Ms. Elizabeth Roll
Mr. William Romo
Ms. Shelly L. Rosenstock
Ms. Carol Rosmait
Ms. Barbara Ross
Ms. Patricia Rowe
Mr. Danny Rueter
Ms. Judith Ryan

EMPLOYEE PHILANTHROPY CLUB *continued*

Ms. Donna Rygiel
Mr. Bradley J. Sabre
Mrs. Kelly W. Sachse
Ms. Debra Sadowski
Ms. Joan Satorius-Unruh
Ms. Christine Schanz
Ms. Patricia Scheckel
Ms. Mary Schigoda
Ms. Angela Schlemm
Mrs. Karen Schmeling
Ms. Deborah Schmidt
Mrs. Laverne A. Schmidt
Ms. Nancy Schmidt
Ms. Janet Schoba
Ms. Lynn Schubert
Ms. Karen Schulte
Ms. Marilyn Schultz
Ms. Rebecca Schultz
Mrs. Suzanne Schultz
Mr. Martin Schutte
Ms. Lynn Schwochert
Ms. Susan Sear
Ms. Judith Seeger
Ms. Verna Seitz
Ms. Kim Semmelhack
Mr. and Mrs. Scott Semrad
Ms. Patricia Shapiro
Mrs. Judith Silvernail
Dr. Douglas Simpkin
Ms. Laura Sims-Bundy
Ms. Natalie Singer
Ms. Wendy Skare

Mrs. Shirley A. Skowronski
Ms. Delores Smith
Mr. and Mrs. Michael Smith
Ms. Rosemary Smith
Ms. Alicia Smokowicz
Ms. Jill Soderstrom
Mr. Mark Sorenson
Ms. Nancy Stachnik
Mr. Edmund Staroselec
Mr. Allen Stasiewski
Ms. Peggy Stefanac
Mr. John Steinman, Jr.
Mrs. Joan Stencil
Ms. Jill Sternberg
Ms. Leslie A. Stich
Mrs. Jan Stockstell

*I can't say enough
good things about
St. Luke's.*

GRATEFUL PATIENT
OCONOMOWOC, WISCONSIN

Ms. Maria Stone
Mrs. Diane Strack
Mrs. Jacqueline Straszewski
Ms. Lisa A. Sullivan
Ms. Mary Swahn
Ms. Emerald J. Swanson

Mr. Kenneth M. Swoboda
Ms. Cheryl Tersen
Ms. Elizabeth Thompson
Ms. Anne Thornton
Ms. Carol Toutant
Ms. Kimberly Traxel
Mr. Steve Trojanowski
Ms. Christine Truskowski
Ms. Elizabeth Tulpa
Mr. and Mrs. Edward Turcotte
Ms. Sally Turner
Ms. Ann Margaret Tylenda
Mrs. Rita P. Udovich
Ms. Lisa Urban
Ms. Beth Van Enkenvoort
Mr. Christopher Vandenberg
Mr. James Vlazny
Mr. Mark Vogel
Mrs. Ann Wade
Ms. Jeannette Wade
Ms. Jennifer Wade
Ms. Johanna Walker
Ms. Cheryl Walters
Ms. Janis Waraxa
Ms. Charlotte Ware
Mrs. Sheryl Watkins
Mrs. Marija Weidman
Ms. Elizabeth Weindorfer
Ms. Lori Weiss
Mrs. Debra M. Wencka
Ms. Mary Westphal
Ms. Doreen Wheaton

Ms. Sharon K. White
Mrs. Katherine M. Wicker
Ms. Betty Wicks
Mr. and Mrs. Mark S. Wiener
Ms. Flora Williams
Ms. Marcia Williams
Ms. Dawn Wilson
Mrs. Laurel Wilson
Ms. Carol Witt
Ms. Alice M. Witz
Gary and Cheryl Wolff
Ms. Susan Wood
Ms. Joan Woods
Mr. and Mrs. William James Woods
Ms. Linda Worthington
Mr. James and Dr. Sheryl Wrass
Ms. Abigail Wroblewski
Ms. Jean M. Wucinski
Ms. Lynn Wyman
Ms. Beverly Yahnke
Ms. Lynda Yanny
Mrs. Sally M. Young
Ms. Karen Yust
Mrs. Bernadette Zacher
Ms. Beth Zallar
Ms. Karen Zeier
Ms. Sandra Zemke
Mr. Steven Zielinski
Mr. and Mrs. Ronald Zoulek

COOKING WITH SPIRIT: SALMON BALL

Just in time for holiday entertaining, the salmon ball's flavor, both comforting and enticing, is certain to please guests of all ages. Salmon's nutty and woodsy taste makes it a perfect complement to other seasonal offerings. To conserve time, make it the day before your big party and chill in the refrigerator overnight. Bon Appetit!

Cooking with Spirit: **Salmon Ball**

8 ounces fat-free cream cheese – softened
16 ounces canned salmon – well drained
2 teaspoons grated onion
1 tablespoon lemon juice

1 teaspoon horseradish
1 cup chopped pecans
½ cup chopped parsley

Mix together cream cheese, salmon, grated onion, lemon juice and horseradish. Chill. Shape into a ball, then roll ball into chopped pecans and parsley. Serve with assorted low fat crackers.

Note: The fat in this recipe is from the salmon, which is a great source of omega 3 fatty acids, and the nuts, which are high in monounsaturated fat.

Makes 10 servings.

Nutrient information per serving: 159 calories, 10 grams fat (only 1.5 grams saturated), 377 mg sodium

– Contributed by Robin Peterson, Dietician, St. Luke's Cardiopulmonary Rehabilitation Department

THE TRIBUTE FUND

GIFTS RECEIVED JANUARY 2001 THROUGH SEPTEMBER 2001

GIFTS RECEIVED AFTER SEPTEMBER 30, 2001 WILL BE RECOGNIZED IN THE NEXT ISSUE OF THE SPIRIT.

Designating St. Luke's as the recipient of memorial gifts is a very special way to remember a loved one or to express your appreciation for a loved one's care. To let friends and relatives know of your wishes, may we suggest the following wording:

*The family would appreciate memorials to St. Luke's Medical Center,
c/o The Tribute Fund, P.O. Box 14123, Milwaukee, WI 53214.*

If you would like to receive a St. Luke's Tribute Fund booklet, a convenient and meaningful way to honor or remember family members and friends, please call The Tribute Fund office at (414) 328-6424.

In Honor of

DR. ARVIND AHUJA
Mr. and Mrs. Frank Odill

MR. JAMES V. AIELLO
Mr. and Mrs. Paul L. Aiello

MR. AND MRS. JOHN
ARZBERGER 50TH
WEDDING ANNIVERSARY
Mrs. Erna L. Ziegelmann

DR. JILL A. BABBITT
Mr. and Mrs. Roland B. Sieg

DR. KENNETH BORTIN
Mr. David M. Mikrut

KATHLEEN BROWN
BIRTHDAY
Ms. Kathryn L. Nelson

DR. BART L. COX
Mr. Richard Pudroski

DR. JOHN D. CROUCH
Mr. John L. Wade

DR. RUSSELL C. DABROWSKI
FOR HIS CARE AND
CONCERN
Mr. and Mrs. Louis J. Amoroso

LYNNE DAY
Mr. George A. Roth

ELENA T. FERRISE
Mrs. Nilda M. Ferrise

DR. JOSEPH GEENEN
Mr. and Mrs. Greg Balmes

PATRICIA GOHS
RETIREMENT
Big Hollow School District # 28

JOHN GOODGER
NEW HEART RECIPIENT
Mrs. Diann Goodger

RITA GORDY
FOR A SPEEDY RECOVERY
Mr. and Mrs. Walter Peltz

ALFRED AND DONNA HEON
Dr. Mary Ness and Mr. Kenneth
Ness

CLAYTON T. HERLACHE
Mr. and Mrs. Clayton T. Herlache

EUGENE HERTE
Mr. and Mrs. Gregory Herte

TRUDE HEUP
Mr. Emmett Heup

FAYE JACOBS
50TH BIRTHDAY
Mr. and Mrs. Paul Jacobs

MR. AND MRS. PAUL JACOBS
50TH WEDDING
ANNIVERSARY
Mr. and Mrs. Paul Jacobs

ALVIN JAECKELS
Mr. and Mrs. Ed Maki

MRS. LESLIE KALLENBACK
Mr. and Mrs. David Raine

JILL RENEE KELLER
Ms. Cynthia Brown
Mr. and Mrs. W. Dewsenberry
Mr. Richard King

DR. LEONARD H. KLEINMAN
Ms. Vivian M. Bauman
Mr. and Mrs. Felix Gallo, Jr.

DR. DEAN E. KLINGER
Mr. Richard J. Stevens
Ms. Bernadine Wollner

ALVIN KNUDSON
Mr. and Mrs. Rod Gnerlich

MR. HENRY J. KRIER
EOG Environment, Inc. Employees

MRS. SALLY KUHLMAN
HAPPY BIRTHDAY
Mrs. Sally McReynolds

MR. AND MRS. LEONARD
LAUWASSER 50TH
WEDDING ANNIVERSARY
Mr. Milton Morris

DR. JAMES A. LEIBSOHN
AND STAFF
Ms. Arlene A. Griep

DR. STEVEN LONGO
Mr. and Mrs. Donald Krasno

DR. FRANKLIN LOO
FOR ALL HIS CARE AND
KINDNESS
Mr. and Mrs. Walter Peltz

DR. JAMES L. MAHONEY
Mr. Richard Pudroski

DR. MARK A. MEIER
Mr. and Mrs. Frank Odill

KENNETH R. MURRAY
Mrs. Frances E. Murray

JAMES NADER
Mr. and Mrs. James Nader

DAVID P. NOWACKL
Mr. and Mrs. John T. Young

JAN PALLEON
Mr. Julian Zander
Mr. Thomas Zander

DR. GERARD T. PARENT
Mr. and Mrs. Robert J. Larkin

LILA PARZYCH
WONDERFUL CAREGIVER
Ms. Lisa E. Weber

KYLE AND AUBRIE POCKEY
LOVED GRANDCHILDREN
Mr. and Mrs. Kenneth Loomis

MRS. ARDIS QUANDT
Mrs. Helen Berghammer

HELEN RONKIEWICZ
Ms. Hanna M. Womack
Elizabeth and Mark

BOB ROTHWELL
Mr. Thomas J. Walker

DR. JAMES A. RYDLEWICZ
Mr. and Mrs. Adrian J. Fitzhonts

ST. LUKE'S MEDICAL CENTER
IN GRATITUDE FOR THE
EXCELLENT CARE HER
FATHER RECEIVED
Mr. and Mrs. Peter L. Thompson

*This donation was made possible by the efforts
of four gentlemen who hosted a golf outing to
honor my late husband's memory. Please
acknowledge these four friends, who graciously
donated their time and energy to help raise
these proceeds.*

GRATEFUL WIFE
NEW BERLIN, WISCONSIN

THE TRIBUTE FUND *continued*

ST. LUKE'S MEDICAL CENTER
DEDICATED NURSING
STAFF

Mr. Francis T. Stephens

ST. LUKE'S MEDICAL CENTER
PHYSICIANS

Mr. Gus C. Boll

ST. LUKE'S MEDICAL CENTER
STAFF OF HEART
TRANSPLANT CLINIC

Mr. and Mrs. Alphonse Cerasoli

ST. LUKE'S MEDICAL CENTER
STAFF OF THORACIC
TRANSPLANT
HEART FAILURE CLINIC
FOR THEIR SINCERE
CARING AND CONCERN

Mr. and Mrs. Dale Slaasted

ST. LUKE'S MEDICAL CENTER
STAFF OF VINCE LOMBARDI
CANCER CLINIC
FOR EXCEPTIONAL
CARE GIVEN

Ms. Lillian G. Piantanida
Mr. Thomas J. Walker
Mr. and Mrs. Donald C. Wiemann

ST. LUKE'S MEDICAL CENTER
VAN DRIVERS AND
SCHEDULERS

Ms. Amelia Kmet

DR. GREGORY H. SCHUCHARD
Ms. May Hamann
Mr. and Mrs. Frank Wrzeski

DR. HOWARD SHORT
Mr. Guy Ewing

HELEN M. STUBBE
Mr. and Mrs. Willis Stubbe

MR. AND MRS. JEROME
TADYCH 50TH WEDDING
ANNIVERSARY

Mr. and Mrs. Harry C. Mack

DR. ALFRED J. TECTOR
Ms. Marian J. Bukachek
Ms. Bridget Garavalia
Ms. Laverne Kasian
Mr. Richard Miller
Mr. Richard Pudroski
Mr. and Mrs. John H. Schmitz
Mr. Jules F. Wachs

LENA M. TRANDAFIR
Mr. Charles Trandafir

MR. MICHAEL C. VILIONE
EOG Environmental, Inc.
Employees

BOBBIE L. VOSS
STRONG, POSITIVE ROLE
MODEL
Employees of the Boucher Group

CLIFF AND MARION
ZIEGELMANN
61ST WEDDING
ANNIVERSARY
Mrs. Erna L. Ziegelmann

In Memory of

JOHN ACETO
Mrs. John Aceto

DONALD ADAMS
Ms. Lynn Adams

HARLAN AND ROSE
ANDERSON
Mr. Sam Steffan

HERBERT ANDERSON
Mr. and Mrs. Robert L. Cowles

LEONARD E. ANDERSON
Mrs. Delores R. Anderson

SARAH ANDERSON
Mr. and Mrs. Royal E. Beguhl

GEORGE J. ANGYAN
Ms. Carole Houston

LEE ARNESON
W.O.W. Distributing Company, Inc.
Aldo, Tom and Gina Madrigano

JEAN AUSMAN
Mrs. Bunny Cohen

OZZIE BABIASZ
Mr. and Mrs. Robert L. Fountaine

LAWRENCE BABKA
Mr. and Mrs. Richard C. Moore

FRANCIS BAGNIEWSKI
Mrs. Iola Bagniewski

DIANE L. BALDASSI
Mrs. Eleanor Janonis



Barbara Springer and Irma Springer

GAIL BALTHAZOR
Ms. Marguerite C. Zolnierrek

SAM VINCENT BARTOLOTTA
Mrs. Rose M. Bartolotta

FELICIA C. BARTOSZAK
Mr. and Mrs. Henry A.
Maksimowicz

ANTHONY BATCHER
Mr. and Mrs. William Bagguley

RON BATES
Mrs. Ruth Bates

HARRY BAULDRY
Mrs. Betty Bauldry

BRIAN BAUMLER
"Gunny" Memorial Golf Outing

JOSEPH W. BAXTER
Mrs. Elnor L. Baxter

BARBARA G. BECKER
Mr. and Mrs. Donald W. Almquist
Mr. and Mrs. Rudy Bialek
Family and Friends
Mr. and Mrs. Emil Gohr
Mr. and Mrs. Brian Leair
Mr. and Mrs. Erik Sande

FLOSSIE M. BEHRENS
Mr. Albion O. Behrens

MANFRED P. BENDUHN
Mrs. Ruth Benduhn

ANN H. BERGER
Frank J. Berger and Family

MICHAEL BERRES
American Family Insurance Group

JAMES BETZ
Mr. and Mrs. William Betz

CHARLOTTE BISKUPSKI
Mr. Joseph Biskupski

EVELYN BJERKE
Mr. Floyd Bjerke

STEVE BLATNAK
Mrs. Doris Blatnak

RUPERT L. BLAZER
Mr. and Mrs. Roland G. Kiefer

PAUL A. BLESER
Dr. Terence Schmahl

JOE BLOCHOWIAK
Mrs. Mary Ann Jurkowski

MARGARET M. BLUEMKE
Mr. Jack W. Boettcher

LESLIE BOLNICK
Mr. and Mrs. Rusty Katz

BRENDA ANN BOROWSKI
Mr. and Mrs. Richard W. Riesch

ROBERT L. BOWMAN
Mr. and Mrs. Walter W. Dusold
Mr. and Mrs. Timothy A. Klug
Mr. and Mrs. Robert Smith

KELLEY L. BOZZACCHI
Mr. and Mrs. Donald Vander
Velden

EDWARD BRANZOL
Tool & Die Makers Lodge #78

THE TRIBUTE FUND *continued*



Jill and Tom Budnik

DONALD BRAUER
Mrs. Loretta Brauer

CELESTINE D. BRICE
Mr. Harold E. Brice

DAVID T. BROWN
Mrs. Margaret E. Brown

MARCELLA BUEGE
Mrs. Dolores Kluth

BURDECKI AND ERNST
FAMILIES
Mrs. Dorethy L. Vincent

ROBERT F. (BOB) BURKE
Mrs. Jean B. Burke

ALBERT CALOGERO
Mr. and Mrs. Vincent J. Falvo

DR. THOMAS CALVY
Dr. and Mrs. Richard H.
Strassburger

DOLORES CAMPOS
Mr. and Mrs. Raymond A.
Bartman
Mr. and Mrs. Paul S. Brock
Ms. Linda M. Ditello
Mr. and Mrs. Russell Holmes
Mr. and Mrs. Clifford S. Johnson
Mr. and Mrs. Al Krause
Mr. and Mrs. Steve Midthun
Ms. Marlene Miller
Ms. Ruth Nelson
Mr. Michael Reinke
Kelly and Greg Sachse
Cindy and Ken Timm
Mr. and Mrs. John Winkowski

GLADYS P. CARRIER
Mr. Harold P. Carrier

ALFRED D. CASPER
Mr. and Mrs. Peter F. Jones

KATHLEEN CHARNEY
Mr. and Mrs. George Kuffel

CIBIRA FAMILY MEMBERS
Mr. Stephen Cibira

MARGARET CIELINSKI
Mr. and Mrs. Edward P. Rymer
Mr. and Mrs. Timothy J. Rymer

MILDRED K. CIENIAN
Mr. Michael F. Cienian

DOROTHY R. CIESLIK
Ms. Lora Biddle
Mr. and Mrs. William Buechner
Family and Friends
Mr. and Mrs. Fred J. Jahnke
Ms. Rita P. Kaczmarek
Mr. and Mrs. Marvin M. Koch
Ms. Margaret Kozlowski
Mr. and Mrs. Gary W. Larsen
Mr. and Mrs. Emil Lukaszewski
Retired Fire & Police Association
Mr. and Mrs. Albin A. Rutkowski
Ms. Margaret R. Schwacher
Mr. and Mrs. Casimir G. Szygiel
Mr. and Mrs. Conrad T.
Wasielewski
Ms. Melody D. West

MICHAEL J. COLLA
Mrs. Florence J. Colla

ROBERT L. CRAWFORD
Mrs. Marion Crawford

ELIZABETH CRIBB
Mr. and Mrs. Kevin Tyler

BRUCE CURTIS
Mr. and Mrs. Bob Nadolske

MELVIN D. DALYRUMPLE
Family and Friends
Mr. and Mrs. Richard E. Fernhout
Mr. and Mrs. Kenneth P. Kneeland
Lakeside Manufacturing, Inc.
Mr. and Mrs. Richard G. Paulsen
Mr. and Mrs. Kenneth J. Savadil
Ms. Laurel L. Schubert

DAVID DAMON
Mrs. Patricia Rankin Koch

JOHN DANGELO
Mr. David B. Witkowski

SOPHIE DAVIS
Mr. Walter L. Davis

BARBARA, DOMINIC,
FILOMENA DE BELLIS
Mr. George De Bellis

JACK DE BRAAL
Ms. Marlene De Braal

BERNARD DEJA, SR.
Mr. and Mrs. David Bainer

GERROLD DENNENBURG
Mrs. Lee Sweet

ANGELINE DE VITA
Ms. Gerianne Asti
Mr. and Mrs. Art Biesek
Mr. and Mrs. Ed Ciechanowski
Mr. Dino De Vita
Ms. Mary Elizabeth De Vita
Mr. and Mrs. Robert J. De Vita
Mr. and Mrs. Chester Kwiatkowski
Mr. and Mrs. Gerald Redmond
Mrs. Evelyn Sammarco
Mr. and Mrs. Wayne E. Schroeder
Mr. and Mrs. Daniel E. Sherman
Mr. David J. Singer and Ms. Rose
Marie Langland
Mr. and Mrs. Richard G. Templin
Wayside Furniture, Inc.
Mr. and Mrs. Edward Winnie
Ms. Sylvia Wray

THOMAS L. DINEEN
Mr. and Mrs. Robert W. Bender

TOM DIXON
Mr. and Mrs. Ervin A. Stolz

GORDON DOHERTY
Mr. and Mrs. Edward Klinger

RUSSELL E. DOOLITTLE
Mrs. Lois M. Doolittle
Mr. and Mrs. Jack Tinker

RUTHE M. DOUTHITT
Mr. and Mrs. Gerald M. Lawonn

RALPH R. DUNLAP, JR.
Ms. Edna R. Christensen
and Family
Mr. and Mrs. Harry Christensen
Mr. Rollo Christensen
Mr. and Mrs. John Filiczowski
and Family
Ms. Julie S. Hancock
Ms. Florence J. Hintz
Mr. and Mrs. Steve Honerlaw
Mr. and Mrs. Robert Jester
and Family
Mr. and Mrs. Bill Joas
Kiwani Manor Nursing Home
Employees
Ms. Beverley Knoll and Family
Mr. and Mrs. Larry McIntyre
Ms. Gertie Mielke
Mielke Village Market Employees
Ms. Rosy Sieg
Mr. Jack Stearle
Mr. and Mrs. Verb Symons
Ms. Marion Taubert
Ms. Bette Wall
Mr. Dennis A. Zagorski

HAROLD A. EBERT
Mr. and Mrs. Peter Witt

RICHARD EBERT
Mr. and Mrs. Willis Dewsenberry

JOHN N. ECKROTH
Mrs. Louise Eckroth

ERVIN EHMKE
Mr. and Mrs. Merlin Rehbein

WALTER EHMKE
Mr. and Mrs. Edward F. Schmidt

LYNN E. ELLISON
Mrs. Betty Ellison

NANCY J. ENDERS
Ms. Dawn C. Sehmer

ED ENERSON
Mr. and Mrs. Robert Trout

RICHARD ERHARDT
Mr. and Mrs. Walter M. Keippel

LAWRENCE ESCH
Mr. and Mrs. David Meyer

THE TRIBUTE FUND *continued*

ROBERT S. FALTYNEK
Mrs. Dolores R. Faltynek

GERALD FARNSWORTH
Mr. Bernard E. Necas

FRANCES A. FAYTIS
Mr. James L. Faytis

GLADYS FEICH
Ms. Roberta L. Boehm
Ms. Mary B. Butkus
Mr. and Mrs. Anthony Clementi
Mr. and Mrs. Mark L. Crom
Mr. and Mrs. Joseph R. Dempsey
Mr. and Mrs. Matthew M.
Kopczynski
Metals USA
Mr. and Mrs. John M. Nacker
Ms. Margaret M. Skowlund
Mr. Rudy Struhar
Mr. and Mrs. Robert E. Terrell
Mr. and Mrs. Robert S. Terrell

CECILE FELLIN
Mr. Edward E. Fellin

THOMAS M. FERRI
Mr. Ambrose F. Ferri

WILLIAM FISCHER
Mr. and Mrs. Richard Poplawski

GERI FITZGERALD
Mr. and Mrs. Robert Cowles

ARTHUR E. FLACH
Mrs. LaVerne E. Flach

DR. ROBERT FLEMMING
Mr. and Mrs. Leonard Henry

DONNA FLOCK
Ms. Elayne A. Bruder
Mr. and Mrs. Jack Dapiran

DELORES FLYNN
Mr. James Flynn

MARTHA FRANZ
Mr. Leslie L. Franz

R. RAY FRONBERRY
Mr. and Mrs. V. Bruce Janius
Sr. Mary Margaret

FRANCIS H. GAVIN
Mr. and Mrs. Russell L. Cook

GERALD G. GENRICH
Mrs. Carol B. Genrich

GLENA GERLACH
Ms. H. Virginia Cziok
Ms. Charlotte M. Petri

RITA J. GIGANTI
Mr. and Mrs. Howard E. Alcorn
Mr. and Mrs. Michael T. Allen
Ms. JoAnn Best
Ms. Barb Bowe
Mr. and Mrs. James A. Caylor
Mr. and Mrs. Rudy L. Di Mickle
Mr. and Mrs. Brian G. Dockerty
Ms. Darlene Drall
Family and Friends
Dr. and Mrs. Dean E. Goblirsch
Ms. Georgia Henry
Mr. Frank Herzbert
Mr. John M. Holman
Ms. Marian Jamnik
Ms. Karen Kimball
Ms. Jean Kurowski
LifeTime Credit Union
Mr. and Mrs. Bryan T. Lumb
Mr. Donald E. McCool
Ms. Jane Miller
Ms. Judy Milosch
Mr. and Mrs. Dennis Missun
Ms. Pauline Mussa

Norstan Communications
Employees
Stefanie C. Cristan,
Kasey Fitzpatrick,
Christine Holloway,
Robert Kunz
Mr. Phil Ortiz
Mr. Bruce Paulson
Ms. Nancy Potters
Mr. Dave Rendall
Rexnord Corporation
Conveying Equipment
Goodfellowship Club
Rexnord Goodfellowship Club
Rexnord Foundation, Inc.
Mr. and Mrs. Herman Rohleder
Ms. Doris Rubin
Mr. and Mrs. Kurt Schaefer
Mr. Wayne Schink
Ms. Linda Sims
Mr. Robert Socher
Mr. and Mrs. Michael Sosalla
Ms. Roberta H. Stoppenbach
Ms. Kimberly S. Strike
Ms. Sue Tomczyk
Ms. Karen Weis
Mr. and Mrs. Ronald D. Wilcox
Wisconsin Regional Users Group
Ms. Betty Wolski

HERBERT GILL
Mr. and Mrs. William Bagguley

EVA GLICKSMAN
Mrs. Bunny Cohen
Mr. Neal Cohen

EARL GOELZ
Mr. and Mrs. Gary Gass
Same Day Cardiac Services
Sunshine Club, St. Luke's
Medical Center

BONNIE GOETZ
Mr. James C. Goetz
Mr. Jerry Goetz
Mrs. Marilyn L. Graves and Family
W.O.W. Distributing Company
Aldo, Tom and Gina Madrigano,
Thomasina, Kathy, Luigi

DR. ARNOLD GOLDMAN
Mr. and Mrs. Rusty Katz

KENNETH GONWA
Mr. and Mrs. Leonard S. Fairbanks
Ms. Charlene Waterman

LINDA GORMAN
Mr. and Mrs. John C. Young

CLARENCE F. GOYETTE
Mr. and Mrs. Dwaine P. Peterson

ADELLE GRAHAM
Mr. Henry C. Graham

MR. GRAUPNER
Randy, Nick, Pat, Sue, Kim, and
Joe Koch

RICHARD GREB
Mrs. Joan Greb

CLIFTON E. GREEN
Mrs. Louis Lessard

EDMUND F. GROOTEMAAT
Mrs. Delores R. Anderson

VICTORIA GRUDZINSKI
Mr. Edwin Grudzinski

EUGENE C. GUENTERT, JR.
Mrs. Jill Guentert

HAROLD R. HAACK
Mrs. Dorothy E. Haack

CHARLES H. HABERICHTER
Ms. Judy C. Acker
Ameritech Training Center
Ameritech Training
Center Employees
Kathy Antoneiwicz
Tom Bergen
Icay Bowie
Terry Burki
Bob Ciganek
Debby DeAtley
Nancy Fabian
Gary Fitzgerald
Kathy Fixel
Dawn Hager
Chris Haufe
Kathy Hermans
Valley Hollins
Dennis Knollenberg
Kathi Luther
Therese Manuel
Cheryl Polansky
Laura Potter
Lori Recht
Joan Rheineck
Jim Snyder
Patti Szabo
Dianne Szajna
Ellyn Tokarczyk
Dennis Weber
Mr. and Mrs. William A. Baumgart
Mr. and Mrs. James Bernier
Ms. Frances M. Bock
Mr. Jay H. Brost
Mr. and Mrs. Douglas Burmeister
Mr. and Mrs. Anthony Clementi
Mr. Neil Corcoran
Family and Friends
Gary Fields Family
Ms. Frances L. Finkler

TIME TO SPARE?

A few times a year, volunteers are needed to help with mailings from the philanthropy office. If you have a few hours to spare and would like to join a congenial group of hospital friends known as the "Stuffer Duffers," please call Shirley in the Office of Philanthropy at (414) 649-7194.

THE TRIBUTE FUND *continued*

Mr. and Mrs. Ronald G. Fritsch, Sr.
Ms. Arlene A. Glenz
Mr. and Mrs. James Hahm
Mr. and Mrs. Frank Hayashi
Ms. Rebecca G. Hobart
Mr. and Mrs. William C.
Hoffmann

Ms. Phyllis R. Holzman
Ms. Sandra A. Ivers
Mr. and Mrs. Louis Kapfhammer
Mr. Colin P. Kattner
Ms. Sandra Kicaid
Ms. Betty Ann Koepsel
Ms. Kelly A. Kubec
Ms. Lois Kuehn
Mr. and Mrs. Dean P. Larkin
Ms. Barbara Lodde
Mr. and Mrs. Gerald Mattke
Mr. and Mrs. Pat McIntosh
Mr. and Mrs. S. K. Mehta
Ms. Mary Moritz
Mr. and Mrs. Richard H. Ohl
Mr. and Mrs. Val Palama
Mr. and Mrs. Ronald Poe
Mr. and Mrs. Earl Rigg
Mr. and Mrs. James A. Rodrian
St. Vincent Clothing Company Staff
Mr. and Mrs. Thomas Saeger
Mr. and Mrs. Rodney J. Schey
Ms. Susanne A. Schilke
Mr. and Mrs. Kurt Schlotter
Ms. Charlene Southworth
Mr. and Mrs. Robert E.

Williams, Jr.
Mr. and Mrs. Lloyd H. Willms
Mr. and Mrs. Gary A. Ziegler
Mr. and Mrs. James P. Zierk

LARRY HAMILTON
Mrs. Patricia Hamilton

MORLAND J. HAMILTON
Mrs. Agnes Hamilton

ROBERT AND DOLORES
HAMMETTER
Mr. and Mrs. Norman Hammetter

KATHY HANDELAND
Ms. Marjorie Maschman

JAY HANE
Mid Continent Management
Corporation
Mr. and Mrs. Ron Wierzchowski

GERALD HANSEN
Mrs. Arlene Hansen

GLADYS M. HANSON
Mr. and Mrs. John Brilla

GORDON HASENSTEIN
Mr. and Mrs. John P. Duffey

PAULINE M. HATCHELL
Mr. Ernest Hatchell

SUSAN HAUSER
Ms. Theresa R. Held

JANICE HECKERT
Ms. Marilyn Heckert

LILLIE M. HEFFNER
Mr. Edward M. Heffner

NANCY E. HEGEMANN
Family and Friends
Mr. and Mrs. Karl Goetzke, Sr.
Mr. and Mrs. Mike Gunderson
Mr. Michael Hegemann
Mr. and Mrs. Tony Hegemann
Mr. and Mrs. Ron Hocharer

SELMA HEIFETZ
Ms. Rita H. Hanke
Ms. Carol J. Pingel

J. DOUGLAS HELLER
Mr. and Mrs. J. Andrew Heller
Max T. and Anna J. Heller
Foundation
Mr. and Mrs. Robert F. Whealon

JOHN D. HENDRICKSON I
Mr. and Mrs. Christopher Schimel

BARBARA HENERICH
Mr. and Mrs. David Meyer

ELIZABETH HENKE
Mr. Harry G. Henke

BETTY HENNING
Ms. Dawn Slawnikowski

ALBERT, HELEN,
WILLIAM HESS
Mrs. Dorothy H. Freihube

ELIZABETH HESS
Dr. James R. Warsh

MARGIE A. HESSELMAN
Mr. Darren S. Almquist
Mr. and Mrs. Delfred R. Beyers
Ms. Barbara J. Bowe
Mr. and Mrs. David W. Erickson
Family and Friends
Foran Spice Company
Mr. and Mrs. Richard G. Halverson
Ms. Nadine E. Kroenke
Music Theatre Louisville
Ms. GERALYNN NELSON
Mr. and Mrs. Duane Paul
Mr. and Mrs. James Ragsdale

Mr. and Mrs. Edward A. Smith
Mr. and Mrs. William D. Snarski
That's Amore
Mr. and Mrs. Floyd Webb
Mr. Cary B. Wiger
Ms. Cynthia A. Zyzdik

CARYL HEUP
Mr. Emmett Heup

LILLIAN M. HINMAN
Mr. Carl G. Hinman

ROSEMARIE HRIBAR
Mr. and Mrs. Lee R. Hribar

JOHN HRUZ
Ms. Maureen C. Jones

INEZ M. HUBBARD
Mr. Gerald F. Hubbard

EARL HUDDLESON
Ms. Jane Bubolz
Ms. Jeanette M. Bubolz
Ms. Lucille H. Bubolz

MRS. HUEBSCH
W.O.W. Distributing Company, Inc.
Aldo, Tom and Gina Madrigano

MILDRED HUGHES
Mr. James J. Fischer

ROSEMARY HUSSLI
Mr. and Mrs. William J. Durivage
Family and Friends
Mr. and Mrs. Randall Godsey
Ms. Andrea M. Hussli
Mr. and Mrs. William J. Hussli
Mr. and Mrs. Robert P. Mammen
Mrs. Helen M. Owens

SIDNEY E. HYDE
Mrs. Hilda L. Hyde

JOSEPHINE HYLAND
Mr. and Mrs. Irv Hansen
Mr. and Mrs. Raymond J. Klink
M&I Bank - Northern
Mrs. Laverne Schmidt

ROD IMHOLTE
Mr. Stephen Kulasa
Ms. Wendy Puza

PHYLLIS ROSE IREK
Mr. Anthony J. Irek

ROBERT A. ISAACS
Mr. and Mrs. Ken Charles
Mr. and Mrs. James Hudy
Mr. and Mrs. David Isaacs
Mr. and Mrs. Ed Kurdziel
Mr. and Mrs. Grant Lubin
Mr. and Mrs. Paul Moss
Mr. and Mrs. Erwin Oberle
Mr. John Oberle
Ms. Andrea A. Phelps
Mr. and Mrs. Lothar Schienbein
Ms. Arlene G. Schlederer
Mr. and Mrs. John Schmidt

WILLIAM A. JACKSON
Mr. and Mrs. Daniel Dziedzic
Family and Friends
Ms. Beth Fewless
Mr. and Mrs. Terry A. Gaouette
Greenfield Middle School Teachers
Mr. and Mrs. Scott D. Hoerig
Ms. Judith F. Huck
Mr. and Mrs. Charles Ivancic
Mr. and Mrs. Thomas J. Kay
Mr. and Mrs. Russell W. Lemberger

Mr. and Mrs. Clyde Nettles
Craig and Trevor
Mr. and Mrs. Samuel Rogers
Ms. Kathleen Scaffidi
Ms. Christine M. Schlicht
Mr. and Mrs. Robert J. Schlicht
Mr. and Mrs. William J. Schlicht
Mrs. Ruth Shully



Jack and Marcella Boettcher (left) seated with Anita and Emerich Schenk

THE TRIBUTE FUND *continued*

GILBERT S. JAECKELS Mrs. Louise E. Jaeckels	JILL RENEE KELLER Mr. and Mrs. William Dewsenberry Cynthia Brown and Richard Klug	RUTH KRONKA Mr. and Mrs. Robert J. Lang	MARK ANTHONY LA SOTA W.O.W. Distributing Company, Inc. Aldo, Tom and Gina Madrigano
HOWARD R. JAQUITH Mrs. Howard R. Jaquith	MRS. KING Mr. and Mrs. Leonard F. La Coursiere	HELLMUTH KRUEGER Mr. and Mrs. Fred H. Huck	DARLENE LASSA Mr. David Lassa Milwaukee Professional Fire Fighters Auxiliary
JAMES JAYE Mrs. Helen R. Jaye	CHARLES KIRSCH Mrs. Florence Kirsch	ANN KRUPSKI Mr. and Mrs. James Krupski	DAVID L. LAUTERBACH W.O.W. Distributing Company, Inc. Aldo, Tom and Gina Madrigano
WALTER JEDRYSZEK Ms. Barbara J. Parsygnat	JOHN M. KLEIN Ms. Ellen Bladorn	ROSEMARY C. KUCKKAN Mr. Harold C. Kuckkan	JOSEPHINE LAWLER Mr. Robert C. Lawler
ROBERT L. JOHNSON Mrs. Dorothy S. Johnson	PHILIP KLEINMAN Operating Room Staff St. Luke's Medical Center	GARY D. KUHLMAN Ms. Annelise Cooney Ms. Julie M. Grissmeyer Mrs. Sally A. Kuhlman Ms. Susan A. Lesperance Mrs. Sally McReynolds Mr. and Mrs. Paul Repp	GERTRUDE M. LECHER Mrs. Patricia Posselt
STEWART JOHNSON Mrs. Dolores J. Kluth	DON KOCH Ms. Patricia D. Flynn Mrs. Patricia Rankin Koch Ms. Emily O'Connor	TECKLA F. AND BERNARD S. KULINSKI Mr. and Mrs. Henry A. Maksimowicz	TIM LEET Mr. and Mrs. Joseph Lehn and Family
STANLEY W. JONES Ms. Janet Jones	GENE CARL KOCH Mrs. Patricia A. Rankin Koch	ELIZABETH KUSS Ms. Janice Frey	RUSSELL E. LEGRAND Mrs. Elsie M. Legrand
WALTER JORDENS Mrs. Sylvia P. Jordens	RAY KOEPEL Mrs. Dorothy Koepsel Mr. Jack Larson	RICHARD KUZMINSKI Mr. and Mrs. Walter W. Dusold Mr. and Mrs. Michael L. Hernandez Ms. Julie Mikolajczak Ms. Julie Sebastian Mr. and Mrs. Robert J. Steininger Mr. John Sumi Ms. Gloria J. Venski Mr. John Wagnitz	WILLIAM H. LIEDTKE Mrs. Genevieve R. Liedtke
LOUIS L. JOST Mr. and Mrs. Stanley Zlotocha	EMANUEL KOHLBECK Mrs. Grace Kohlbeck	LUCILLE AND ROSE KWIATKOWSKI Mr. Frank Kwiatkowski	JAMES LIMACHER Mr. Kevin Calder Mr. Roy A. Calder Deutsch Associates Mr. Dan Hall Ms. Colleen Johnson Ms. Beverly Krause Dr. and Mrs. J. Krause Mr. and Mrs. Donald R. Larson Ms. Peggy A. Limacher Mr. and Mrs. Royce Lockwood Mr. and Mrs. Kevin Nelson Mr. Ronnie Nelson Mr. and Mrs. Mark A. Pasch Ms. Patricia Sales
NICK KACHIKIS Mrs. Eleanor Janonis	DOROTHY KOLA Mr. Philip S. Kola	ELLEANORE LA FLEUR Ms. Jeanette M. Bubolz Ms. Lucille H. Bubolz	RITA L. LINK Mr. Chester C. Link
ANNIE KACZMAREK Mr. and Mrs. Edward J. Miller	JON KOLBERG Mr. and Mrs. Vernon Hafeman Mrs. Betty Kolberg	KATHLEEN LAMBRECHT Mr. and Mrs. E. Edward Klessig	IRVINE LLEWELLYN Mrs. Harriet B. Llewellyn
BRUCE KALINOSKI Mr. and Mrs. Richard Bodin	PAUL D. KOWALSKI Mrs. Louise Czajkowski Family and Friends Mr. and Mrs. David J. Heller Mr. and Mrs. Gilbert C. Palkowski	NORMAN W. LANG Mrs. Kristina Lang	FRANCIS A. LOCKWOOD Mrs. Marjorie A. Lockwood and Family
GEORGE KAMAKIAN Ms. Mary Ann Injasoulion Mr. and Mrs. Frank Patriacuca Mr. and Mrs. Ray Verwey	LEO G. KRENZ Mrs. Mary Lou Krenz	PETER LANGO Mr. and Mrs. Michael T. Rotter	LESTER AND DOROTHY LORENZ Ms. Joyce A. Gass
TIM KAMER W.O.W. Distributing Company, Inc. Aldo, Tom and Gina Madrigano	DIANE KREPSKY Ms. Judy Krepsky	GENEVIEVE LA PINSKE Mr. Clarence La Pinske	
STEVE AND ANNA KAMINSKI Mr. and Mrs. John Ptaszynski	FREDERICK F. KRESS Mrs. Elizabeth Kress	ALVIN LARSON Ms. Mary L. Burac	
BERT KANNAPINN Ms. Gladys Smith	JENNIFER KRESSATY Mr. and Mrs. Wallace R. Christine Mrs. Marguerite Marchitelli		
MAGDALENA KAPITAN Mr. and Mrs. Jack A. Bevel	DOROTHY J. KROEGER Ms. Donna L. Goetz		
ROBERT AND TEOLA KAY FAMILY Ms. Deborah L. Lang			
CELMER (JERRY) KEARNES Mr. and Mrs. Walter Silks			



Norbert Pischke, Co-chair, Honorary Philanthropy Committee

ELIZABETH J. LUNDGREEN
ACL Microbiology Department
Employees, West Allis
Memorial Hospital
Mr. and Mrs. John P. Bellotti III
Mr. and Mrs. Daniel Blinka
Mr. and Mrs. David E. Brittain
Fiserv Inc.
Ms. Shirley Plesha
Mr. Frank Pleuak
Ms. Paula G. Rauth
Mr. and Mrs. David R. Roslowski
Mr. and Mrs. Lothar Schienbein
Mr. and Mrs. Thomas F. Scrobel
Mr. and Mrs. Robert L. Schroeder
Ms. Linda Schulz
Ms. Paulette S. Shanti
Mr. and Mrs. Arthur J. Takishian
Mr. and Mrs. Sam Tavidian
Mr. and Mrs. Yun-Chi Tsao

HENRY R. LUNDWALL
Ms. Agnes Lundwall

JEANETTE LYCHWICK
Mr. Dominic Lychwick

CATHERINE M. MAAS
Mr. Walter Maas

GERALD B. MACIOLEK
Mr. and Mrs. John R. Berg
Ms. Nancy M. Berg
Mr. and Mrs. Patrick E. Ciriacks
Mr. and Mrs. Bernard Conrad
Mr. and Mrs. Rudy Cudzinovic
ERP at S&C Electric Company
Mr. and Mrs. Robert R. Essig
Family and Friends
Ms. Laurie Forrestal-Parr
Mr. and Mrs. Raymond T. Franecki
J & L Fiber Services
Mr. Keith Lutz
Mr. Steve Pavloje
Mr. and Mrs. Howard N. Rubin

Mr. and Mrs. Robert C. Schroeder
Mr. Ray J. Schuenke
Weiss Berzowski Brady &
Donahue, LLP
Wisconsin Electric Service Center
Employees - Menomonee Falls

LOUISE MACKLAY
Mr. and Mrs. David Meyer

LORRAINE MAC PHETRIDGE
Mrs. Marilyn L. Graves

JAMES K. MAHER
Mrs. Marilyn, Freddy and
Todd Graves
Bill and Jodi Patek

JOHN MAITLAND
Mr. Richard Bodin

WALTER S. MAJCHER
Mrs. Eleanor Majcher

FRANK MALKO
Mr. and Mrs. Kraig Hackbarth

PHIL MANNING
Ms. Lorraine Dubanewicz

JOSEPH MARINO
Ms. Loraine Marino

RICHARD MARSEL
Mrs. Alvena E. Wernsman

ANTONIO CORONA
MARTINEZ
Mr. and Mrs. Michael Rosen

RICHARD D. MARTINS AND
PEARL KING
Mr. and Mrs. Richard Martins

MARY
Ms. Elizabeth R. Marton

JOSEPH MATEL
Ms. Joyce Wallskog

ALICE MATTES
Ms. Virginia Beckwith
Mr. and Mrs. Vaso Bjegovic
Ms. Suzianne Clark
Ms. Loraine Gro
Ms. Karen Lobb
Mr. and Mrs. Ray Morin
Ms. Rose Premetz
Ms. Gladys G. Pullen
Mr. and Mrs. Tom Ryan
B. Slick
Ms. Sylvia Vanbibben
Ms. Dorothy I. Vojtik

CATHERINE H. MATZELLE
Mr. and Mrs. Robert A.
Malaczewski

DR. DAVID L. MAXHAM
Mrs. Mary M. Maxham

FRANK J. MAYER
Mrs. A. G. Mayer

GEORGE A. MAYER
Mr. Carl O. Friend

TOBIN MAYER
Mr. and Mrs. Milton Morris

JOSEPHINE J. MAYS
Mr. Leonard C. Winters

THOMAS MC CORMICK
Ms. Dolores E. McGuire

F. JAMES MC DONALD
Dr. and Mrs. Alfred J. Tector
Mr. and Mrs. Robert A. Wulf

DONALD P. MC FADDEN
Mr. Jack W. Boettcher

NEIL A. MC LELLAN
Mr. and Mrs. Forrest Day
Mrs. Gertrude Eisenzopf
Mr. and Mrs. Mark Hazzard
Ms. Diane O'Donnell
Ms. Dorothy Parcels
Ms. Mary Surges

DONALD F. MC MILLAN
Mrs. Helen S. Mc Millan

EUGENE A. MEDELBERG
Mrs. Barbara Medelberg

PAUL L. MELSON
Mr. and Mrs. John W. Bunn

HENRY A. MICHNA
Mrs. Adeline M. Michna

EMMIE MIKULAY
W.O.W. Distributing Company
Aldo, Tom, Gina Madrigano
Dawn Slawnikowski

ARVELLA MILLER
Mrs. Charlotte L. Larson
Ms. Karen Philleo

JOHN MINEO
Ms. Donna Heden

IRENE C. MITKUS
Ms. Jessie Beaudry
Mr. Jim Fenske
Mrs. Mary Hughes
Ms. Jean Kowalski
Mr. Richard E. Schoen
Ms. Nicole A. Teweles
Mr. and Mrs. L. William Teweles

GEORGE J. MOEHN
Mrs. Bernadette Moehn

MARY J. MOORE
Mr. Robert F. Moore

MARK MOREY
Mrs. Joyce Morey

DOLF MORTENSEN
W.O.W. Distributing Company, Inc.
Aldo, Tom, Gina Madrigano
Dawn Slawnikowski

JOHN MORTENSEN
Mr. Charles Borkenhagen

EDGAR MUELLER
Dr. and Mrs. William E. Mateicka
Dr. and Mrs. Timothy Wells

NORMA MUELLER
Mr. James E. Burac
Mr. Robert J. Dierksmeier

KENNETH R. MURRAY
Mrs. Frances Murray
Pro Quest Information
and Learning

JEFF NADBORALSKI
Mr. and Mrs. Wayne M. Kankelfitz
Mr. and Mrs. David Meyer

JOHN R. "JACK" NAULT
Mr. and Mrs. Joe Baer
Ms. Mary Baer
Mr. and Mrs. Gaylon Fox
Mrs. Mary M. Nault
Ms. Phyllis Nault

RALPH L. NEBEL
Mrs. Sandra Sobon

MICHAEL NEDELSKY
Mrs. Jeanette K. Nedelsky

JUNE DICKINSON NELSON
Mr. Kenneth Nelson

HUGH NESBITT
Mr. George Alexander
Mr. and Mrs. Andre Belanger
Mr. and Mrs. Frank Mattaino
Ms. Linda Mikorski
Ms. Carolyn Mulvaney
Mr. and Mrs. Dave Radtke
Mr. and Mrs. Edward F. Schmidt
Mr. and Mrs. John Smith
Mr. and Mrs. James Weber
Ms. Joan Zeznanski

MARY NESTOR
Mr. James P. Connelly

BETTY NETTESHEIM
Mr. David B. Witkowski

TONI NEULREICH
Mr. and Mrs. Edward Zawikowski

ALLAN AND MAY NIQUET
Mr. and Mrs. Arthur Niquet

JAMES D. NOLTE
Boston Store friends
and co-workers

ROBERT A. OBST, SR.
Mr. and Mrs. Charles Overeem

PAULINE OLMSTEAD
Mr. and Mrs. Robert Thostenson

HELEN O'NEIL
Mr. and Mrs. Paul F. Neumann
Mr. and Mrs. Ken Wirtz

STAN ORCHOLSKI
Ms. Carol Mathems

JEROME M. ORLOWSKI
Ms. Jana Charvat

MARY OSTROWSKI
Mr. Joseph Ostrowski

ROLAND PADBERG
Mr. Eugene R. Baehring
Mr. and Mrs. Kenneth L. Bilek
Fortis Insurance Company
Joy Global Industries, Inc.
Employee Benefits Department
Mr. and Mrs. Wayne W.
Lehman, Sr.
Ms. Dorothy B. Liebenstein
Mr. and Mrs. Melvin J. Seib
Mr. Michael J. Seib
Mr. and Mrs. Conrad J. Szyzka
Ms. Patricia E. Welch

ROBERT F. PAGELS
Mr. and Mrs. Allen Brown
Mr. and Mrs. James W. Oberg
Mr. William H. Pagels
Ms. Anne Wagner
Mr. Wayne Wroblewski
Mr. and Mrs. Brian J. Zuberbier

CONSTANCE PAGLIANO
Mr. and Mrs. Harry H. Hein
Mr. and Mrs. Ted Kucharski
Mr. and Mrs. Russell H. Mathems

JOE PAPP
Ms. Rhonda Macleod

ANNA PELCZYNSKI
CNS/NC Group
Aurora Health Care
Ms. Dona L. Hutson
Mr. and Mrs. Joseph R. Kukla
Mrs. Nora Ladwig
Mr. and Mrs. John Leonardelle
Ms. Kristin M. Mathison
Ms. Deborah Pajot
Mr. and Mrs. Richard A. Peters
Mr. and Mrs. Norbert Rola
and Roberta

PATRICIA PELRINE
Ms. Theresa R. Held

CELIA PENKALSKI
Mr. Raymond J. Penkalski

CELIA, STELLA AND FRANK
PENKALSKI
Ms. Eleanor Penkalski

THELMA PERCY
Mr. Carl O. Friend

LEONARD PERUSHEK
Bay Finance Company, Inc.
Mr. David M. Brazeau
Brick Buildings
Ms. Tammy L. Burgess
Family and Friends
Mr. Kyle D. Johnson
Mr. and Mrs. Don Michalek
Mr. Steven C. Port
Ms. Lisa A. Sullivan
The Parenting Network, Inc.
Troop No. 96, Boy Scouts
of America
Dr. Nick W. Turkal
Ms. Sally Turner
Mr. and Mrs. Thomas J. Wagner
Mr. and Mrs. Brett J. Walker
Mr. and Mrs. Terry W. Walker
Dr. A. A. Wisniewski

EDWARD POLITOWSKI
Ms. Linda A. West

ANTONIO PONCE DE LEON
Ms. Annette Scigliano

EARL QUALMAN
Mrs. Evelyn Qualman

FREDERICK E. RACE
Mrs. Rosemary Race

HILDA (BUNNY) RADTKE
Ms. Frances B. Fowler

THOMAS RATLIFF
Ms. Irene Timm



Marilyn Kelley and Victor Italiano

ROSE M. PETERS
Mr. Henry P. Peters

ROBERT PETERSEN
Ms. June L. Scott

DOLORES PETERSON
Mr. and Mrs. Richard Kraeblen

MILLIE PHILLIPS
Mr. and Mrs. Earl R. Paradies

MARK PIETILA
Mr. and Mrs. Henry Hrobsky

LEONARD (BUTCH) PILARSKI
Dr. and Mrs. Donald J. Chrzan

MARY BETH PILGREEN
North Hills Country Club

LEO PLAHUTA
Ms. Patricia Kirsop

BARB REDMANN
Mr. and Mrs. Joseph Lehn and
Family

PATRICK J. REGAN
Ms. Marian Peterson

JOHN (JACK) REHRAUER
Mr. Thomas C. Rehrauer

HENRY REPA
Ms. Judith A. Brickler
Mr. and Mrs. Aaron Callender
Dr. and Mrs. Lawrence Cardassi
Mr. and Mrs. David F. Church
Mrs. William Doelger
Mr. and Mrs. John P. Duffey
Mr. and Mrs. Glen W. Farrell
Mr. and Mrs. John F. Foley
Mr. and Mrs. Wayne T. Gasparich
Mr. and Mrs. Daniel H. Girmscheid
Ms. Patricia A. Hansen
Mr. and Mrs. Ernest E. Hooks
Mr. and Mrs. Wayne A. Jeffrey

THE TRIBUTE FUND *continued*

Mr. and Mrs. Ronald C. Jezerc
Mr. Robert J. Jurci
Mr. and Mrs. Daniel N. Kainz
Ms. Collette J. Kimber
Mr. and Mrs. Wilburn E. Kóch
Ms. Lorraine Kovac
Ms. Adda C. Lewandowski
Mr. and Mrs. Phillip Lindberg
Mr. and Mrs. F. J. Michalowski
Ms. Gertrude C. Mihalovich
Mr. and Mrs. Louis J. Rebernisek
Mr. and Mrs. Frank J. Repa
Mr. John J. Repa
Mrs. Lillian Repa
Mr. and Mrs. Karl Scheibner
Ms. Lois A. Sieklik
South Milwaukee High School
Mr. and Mrs. James H. Spiegelberg
Ms. Sandra A. Stiglitz
Mr. and Mrs. Harry J. Wesley

EDWARD G. RHEINSCHMIDT
Mr. and Mrs. Roland Kiefer

DANIEL F. RILEY
Mrs. Donna L. Riley

EVELYN RINZEL
Mrs. Marilyn L. Graves

RICHARD ROBEL
Mrs. Barbara Robel

MILDRED ROBERTSON
Mrs. Alvena E. Wernsman

BERNICE ROBY
Ms. June L. Scott

JEAN ROGERS
St. Luke's Medical Center
Volunteer Service

HELEN RONKIEWICZ
Family of Helen Ronkiewicz
Hanna, Elizabeth, Mark
Womack

ARLYS ROOT
Ms. Armella Amhaus

DIANE ROSINSKY
Mr. and Mrs. Wayne A. Kestner
Mrs. Nancy Precour

JOHN RUHL
Mr. and Mrs. Theophil Sidlik

NANCY RUNGE
Mr. Paul Anderson
Becker Boiler Company Inc.
Mr. and Mrs. William A. Calabria
Ms. Therese Castiglioni
Mrs. Lorraine Gustafson
IAC Chapter 78
Mr. James H. Klick
Myrna, Owen and Rosemary Mibus

GEORGE SAYWRIGHT
Mrs. Patricia Rankin Koch

ESTHER AND HAROLD
SCHAEFER
Mr. Thomas Zielonka

JOHN SCHARNEK
Mr. and Mrs. John A. Bauer

MARIE SCHAUS
Mrs. Mary M. Nault

JOSEPH C. SCHICK
Mr. Joseph E. Schick

HAROLD SCHLOOT
Ms. Jane Bubolz

ARTHUR SCHMIDT
Ms. Marlene Baldikoski

ANN SCHROEDER
Ms. Kathleen A. Schroeder

JOSEPH SCHROEDER
Mrs. Virgilia Oetlinger

MARION SCHROEDER
Mr. LeRoy Schroeder

MARY JANE SCHRUBB
Ms. Loraine Marino

WILLIAM SCHUETT, SR.
Dr. and Mrs. Richard Strassburger

EDWARD SCHULGIT
Mr. Mark Ambrosius
Dr. David Rein and Family
Dr. and Mrs. Alfred J. Tector

HELEN SCHULTZ
Mr. Loren F. Schultz

GILBERT R. SCHULZ
Mr. and Mrs. Arlan Rust
Mrs. Blanche E. Schulz
Mr. Dennis Schulz
Ms. Jill Schulz

ROGER SCHULZ
Mr. and Mrs. LeRoy McCue

WILLIAM J. SCHUMACHER
Delphi Employees
St. Francis Professional Police
Association

MARCEL AND LINNEA
SCIEZ
Mr. Louis J. Sciez

KATHLEEN OELKERS
SCOTT
Ms. Barbara A. Sharpe

NAN SCROGGINS
Mr. and Mrs. George W. Liberatore

JUSTINE H. SEE
Mr. John A. See

JOHN A. SEIDENGLANZ
Mr. and Mrs. Donald Yahr

DOROTHY B. SEYMER
Mr. William P. Schmidt

RICHARD SEYMOUR
Mr. and Mrs. Ronald Krautkramer

MARK A SHILEY
Mr. and Mrs. Charles Shiley

DR. RICHARD T. SHORE
Mrs. Judith Balter
Ms. Ruth Miller
Mr. and Mrs. Paul Tannen

HARRIET A. SHUMWAY
Mr. Alfred E. Shumway

CHRISTINE L. SIENKIEWICZ
Mr. Mark Ambrosius
Drs. David A. Rein and Beth
A. Derfus

RONALD R. SLAWSON
Aerial Work Platforms, Inc.
AXA Advisors, LLC
Mr. and Mrs. Tracy Bazen
Mr. and Mrs. Jeffrey A. Beyer
Custom Structural Inc.
Mr. and Mrs. William J. Cvikota
Mr. and Mrs. Robert A. Donegan
Family and Friends
Mr. and Mrs. Dennis W. Folkman
Mr. and Mrs. John Gorski
Mr. Donald R. Hart
Ms. Sharon Harvey

Mr. Scott A. Herkert
Mr. and Mrs. Dennis J. Layne
Mr. and Mrs. Mark Mastrostefano
Mr. and Mrs. Robert McConahay
Mr. and Mrs. Thomas J. Mitschke
Ms. Evelyn Nicholson
Ms. Kim M. Pagel
Mr. and Mrs. James S. Papez
Mr. and Mrs. Paul R. Rasmussen
Ms. Marian A. Sachs
Mr. and Mrs. Warren Schwenner
Slattery & Hausman, Ltd.
Mr. and Mrs. Jeffrey A. Slawson
Mr. and Mrs. Robert G. Stern
Mr. Kenneth D. Vanderhill
Victory Steel
Mr. and Mrs. Steven Wettstein, Sr.
Ms. Sharon A. Whalen
Mr. and Mrs. Blaise P. Zaffro
Mr. and Mrs. Richard G. Zastrow
Mr. and Mrs. Dennis A. Zevnik

SIDNEY B. SLOCUM
Mr. Carl O. Friend

MARY AND JOSEPH SMITH
Mr. Vincent Smith

CONNIE SNYDER
Mrs. Patricia Rankin-Koch

ALBERTINE SONSALLA
Abbott Laboratories Employees

KATHERINE SORLEY
Mr. and Mrs. Robert J. Lang

BEVERLY SPANKOWSKI
Mr. Roger Peelen

ANN SPUDICH
Mr. Frederick A. Voecting

WILLIAM STARRETT
Mr. and Mrs. Jack Bevel
Mrs. Mary Ann Starrett

ERVIN STEFFAN
Mr. Sam Steffan

ANN (NAN) STEPP
Mr. John C. Stepp

LEONARD STEWART
Mr. and Mrs. Ervin A. Stolz

SUSAN STOLLENWERK
Mr. George Stollenwerk

MARY ELLEN STUART
Mrs. Patricia Posselt

GRETCHEN A. STUMPF
Mr. William G. Stumpf

AGNES SUCHARSKI
Ms. Audrey Willms

TIMOTHY L. SUHA
Ms. Carolyn C. Gesell
Mr. and Mrs. Bart Smudde

DENNIS MICHAEL SUND
Mr. and Mrs. Gary L. Gass

ANTOINETTE E. SUSALLA
Mr. Leonard Susalla

VERONICA SWIENCICKI
Mr. and Mrs. Robert M. Olive

I am pleased to contribute to St. Luke's because without my heart transplant by Dr. Schmahl and his team, and without all the great support staff and nurses, I would not be around to be able to contribute. I have also been pleased to participate in two research projects and a blood study. I benefited from these contributions and research studies, and I hope I can be a part of helping others.

GRATEFUL HEART TRANSPLANT PATIENT
SHEBOYGAN, WISCONSIN

CHESTER SZOPIERAY
Mrs. Martha Szopieray

ANTHONY R. SZYMANSKI
FAMILY
Mr. Roger J. Szymanski

GARY TALATZKO
Blackhawk friends
Dorothy, Merle, Jill, Barbara

BILL TANNHAEUSER
Family and Friends

GEORGE O. TART
Mrs. Eleanor Tart

ARNOLD TARZWELL
Mrs. Eunice Tarzwell

HAROLD TEISING
Mrs. Juanita Teising

BOB TELFORD
Ms. Patricia Rankin-Koch

HENRY AND JOSEPHINE THEIN
Mr. Joseph Thein

NUNZIO THOMAS
W.O.W. Distributing Company
Aldo, Tom and Gina Madrigano

PHYLLIS TIMM
Mrs. Caroline Trester

JACK TINKER
Mr. Fred Awe
Mr. and Mrs. Dave DeRue
Dr. and Mrs. Gehl Devore
Mr. Gary Doolittle
Ms. Lois Doolittle
Mr. Terry Duffy
Ms. Evelyn Fabian

Family and Friends
Mr. and Mrs. Larry Flowers
Green Bay Homemakers
Mr. and Mrs. Lloyd B. Howard
Mr. and Mrs. John Huxhold
Ms. Sally Koziol
Mr. and Mrs. Ed Kroll
Mr. and Mrs. Kevin T. Lenihan
Ms. Ilene Macrowski
Mr. and Mrs. Mark McCarthy
Ms. Helen McCracken
Mr. Daniel Mieczkowski
Ms. Genevieve Mieczkowski
Mr. and Mrs. Randy P. Ochoa
Mr. John O'Meara
Mr. and Mrs. Robert P. O'Meara
Mrs. Eileen C. Pedersen
Mr. and Mrs. Don R. Tinker
Mrs. Mildred Tinker
Ms. Mary White
Mr. and Mrs. Nello Zarletti
Mr. and Mrs. Rudy Zarletti
Mr. Vincent Zarletti

ROBERT TOLLEFSRUD
Mrs. Lorraine Tollefsrud

SHARON M. TOUGAS
Mr. and Mrs. Fred L. Benkert
Mr. and Mrs. Lloyd Bergeron
Mr. and Mrs. Brian Brande
Ms. A. Joan Caywood
Clasman Corporation
Mr. and Mrs. Maurice Derosier
Mr. and Mrs. Tom Dobnik
Ms. Susan M. Drapp
Mr. and Mrs. Thomas M. Dudek
Mr. and Mrs. Richard Grobschmidt
Mr. and Mrs. Dale L. Harty
Mr. Brad Kalscheir
Mr. and Mrs. William F. Karls
Mr. and Mrs. James E. Kowalski
Ms. Jennifer L. Kowalski
Mr. and Mrs. Donald
Lachenschmidt
Mr. and Mrs. Leonard LaCoursler
Mr. and Mrs. Daryl Lambert
Mr. Thuy Larson
Mr. Kenneth Lessard
Mr. and Mrs. Maurice Lessard
Mr. and Mrs. Kirt Lessard
Mr. and Mrs. James L. Loden
Mr. and Mrs. Melvin Mercil
Ms. Kathleen M. Meyers
Midwest Express Airlines
Mr. and Mrs. Fredric W. Mitchell
Mr. and Mrs. Ron Morafcik
Mr. and Mrs. Bob Morgan
Ms. Helga Nissen
Mr. and Mrs. Joe Parise
Mr. and Mrs. Robert A. Rockman
Ms. Dawn M. Sass
Mr. and Mrs. Steven Sass and Family
Mr. Gary S. Taylor
Ms. Mary Tetzlaff
Mr. and Mrs. William W. Tetzlaff
U.S. Bank
Mr. Bill Walczak
Mr. and Mrs. Harold Wickstorm
Ms. Lynn Wilding

DICK TRACY
Mr. and Mrs. David Meyer

LEONA TRAKEL
Ms. Barbara Belongia
Mr. and Mrs. John Collins
Mr. and Mrs. Jerry Dohse
Ms. Aldene Egan
Mrs. Joan L. Geshay
Mr. and Mrs. Ronald J. Lemerond
Mr. and Mrs. Gary Manchester
Mr. and Mrs. Eugene Matuszewski
Mr. and Mrs. Don Miller
Mr. and Mrs. Alan W. Schneck
Mr. and Mrs. Richard F. Schneck
Ms. Marilyn Y. Snyder
Mr. and Mrs. Andy Spiering
Ms. Helen L. Spiering
Mr. and Mrs. John Spiering
Mr. and Mrs. Steve Spiering
Mr. and Mrs. Tom Spiering

CAROLINE TREPTOW
Mr. Delvin A. Treptow

JOHN H. TRESTER
Mrs. Caroline Trester

CLETON TRUMBO
Family and Friends

HARRY TUSZYNSKI
Mrs. Jeanette E. Tuszynski

PATRICIA VALDES
Dr. and Mrs. Donald J. Chrzan

ROBERT A. VANDERHEYDEN
Mrs. Margaret Bai
Mr. and Mrs. Donald Berendsen
Mr. Dave Borowski
Mr. John Cashman
Mr. and Mrs. Allan Dahl
Mr. Jim Dobratz
Mrs. Judith Wiese Edelblute
Mr. and Mrs. Ernest Gegare
Bob and Jim Gmack
Mr. and Mrs. Paul Greer
Mr. Dick Hearden
Ms. Judy Heney
Mr. Ed Holschuh
Mr. and Mrs. Richard Huth
Mr. and Mrs. Russell Klimek
Mrs. Janice Konkel
Mr. and Mrs. Clem Kueper
Mr. and Mrs. Robert Landgraf
Mrs. Joan Niquette
Mr. and Mrs. William Phillips
Mr. D. J. Rolain
Ms. Beth Schwartz
Ms. Phyllis Schwartz
Mr. and Mrs. Donald Smits
Ms. Lori Van Boxtel
Mrs. Betty Vanderheyden
Ms. Janice Van Wychen
Mr. and Mrs. Melvin Villwock
Mr. and Mrs. Phillip Whiteman
Mr. and Mrs. Bob Wickman
Ms. Helen Wright

SELENA E. VEGA
Abbott Laboratories
Corporate Engineering,
Dept. 05WW
Center For Pain Control P.C.
Mr. Lyle J. Coen
Myette Beach Golf Group
Ms. Gina Pignato

WILLIAM WAGNER
Mrs. Gladys E. Wagner

BILL WALDRON
Family of Bill Waldron

THE TRIBUTE FUND *continued*



Marilyn and Gary Gass

ANN WARCZYNSKI

Mr. and Mrs. Jamie Barchus
Ms. Michelle Bialas
Mr. and Mrs. Bruce Brusewitz
Ms. Katie Crisp & Family
Mr. and Mrs. Dave Donahue
Mr. and Mrs. John Donahue
Mr. and Mrs. Doug Drysdale
Family and Friends
Mackenzie Frorath
Ms. Miny Gordon & Family
Ms. Patricia Hagen
Mr. and Mrs. Al Katzer
Mr. and Mrs. Peter Kreiter
Ms. Gienia Kuzykalska
Mr. and Mrs. Michael Lutz
Ms. Maryann Marchetti & Family
Mr. and Mrs. Scott Molitor
Mr. Bill Mueller
Northwestern Mutual
Employees
Mr. and Mrs. Jeff Polewski
Mr. and Mrs. Allen Schmitz
Mr. and Mrs. Randy Schultz
Mr. and Mrs. Dave Shapiro
Mr. Wesley Sherlock
Mr. Joe Staral & Family
Ms. Sophie Szejna
Ms. Karen Watry & Family
Mr. and Mrs. Walter Wojcik

CLARENCE WARTICK

Firststar Mutual Funds
Processing Department

JEAN P. WASZAK

Mr. and Mrs. Daniel H. Andrae
Mr. and Mrs. David Andrae
Ms. Dolores H. Friedrich
Mr. and Mrs. Carl R. Ginter
Mr. and Mrs. James A. Kodel

Mr. and Mrs. Raymond D. Luther

Mr. Thomas Radomski
Relizon Company
Mr. and Mrs. Roger Rothenmaier
Ms. Patricia Rypel
Mr. and Mrs. Steven J. Vallee

MARY J. WAWRZYNIAK

Mr. Anthony F. Wawrzyniak

ALMA WEIDENBAUM

Mrs. Bunny Cohen

JUNE WELCH

Bethany Presbyterian Church
Family and Friends
Mr. Jonathan Gundlach
Mr. and Mrs. Robert A. Hamill
Mr. and Mrs. Charles A. Hazzard
Mr. and Mrs. John A. Jackson
Mr. and Mrs. Daniel La Fond
Mr. and Mrs. David C. Middleton
Dr. James M. Pickerill
Dr. Paul R. Schulze
Mr. and Mrs. Gary R. Schwabe
Mr. and Mrs. Edward R. Sell
Mr. Melvin Welch and Family
Ms. Lauren C. Zarder

MARGARET E. WENDLER

Mr. and Mrs. Otto F. Wendler

RUSSELL WENDT

Mr. and Mrs. Gerald R. Rydeski

JOYCE WENNINGER

Ms. Marjorie Maschman

NORMAN E. WENZEL

Mrs. Evelyn R. Wenzel

EDGAR C. WESTPHAL

Westphal Family

FRANK WETZEL

Mr. Edward M. Heffner

LYNN E. WHITSITT

Mr. and Mrs. Dale P. Arnold
Mr. and Mrs. Bruce G. Bailey
Mr. and Mrs. Jerry Bartos
Ms. Lisa Bergstrom
Mr. and Mrs. Gerald J. Bonin
Mr. and Mrs. Paul E. Breniman
Mr. and Mrs. Edgar Brucklacher
Mr. and Mrs. Daniel Connor
Mr. and Mrs. Leo J. Costello
Ms. Corleta Deau and Family
Mr. and Mrs. Brian Ellinger
Ms. Janice Fischer
Mr. and Mrs. Frank T. Free
Ms. Sandy Gates
Mr. and Mrs. Lyle Hach
Mr. and Mrs. A. J. Harmon
Mr. and Mrs. Leonard Hayne
Ms. Val Helzel
Mr. Tom H. Kalinke
Mr. and Mrs. Ed Kalisz
Ms. Kathy Kristl
Ms. Susan Miller
Mr. and Mrs. Bryan J. Monk
Mr. and Mrs. Bruce Munz
Mr. and Mrs. Felix Munz
Mr. and Mrs. Jim Munz and Family
Ms. Ruth E. Munz
Ms. Nancy Privatt
Mr. and Mrs. Earl S. Rose
Mr. and Mrs. Ken Schaefer
Ms. Jean Schiminski
Ms. Ruth J. Siitari
Mr. and Mrs. Charles M. Smith
Mr. and Mrs. Danny L. Soddy
Mr. and Mrs. John O. Tjebben
Mr. Terry M. Trout
Mrs. Lorraine Wandsnider
Mr. Steven Whitsitt and Family
Mr. and Mrs. Daniel W. Williams
Mr. and Mrs. Richard N. Wilson
Mr. and Mrs. Leonard T. Woloszyk

EDWARD WICKERT

Mrs. Kathleen Wickert

WALTER WIEDEMEIR

Metro Milwaukee Auto Auction

MARGARET WIEGAND

Mr. James J. Fischer

MARY ANN WIENER

Mr. and Mrs. James A. Gogan
Ms. Mona Goodnature
Mr. and Mrs. Chester W. Grobschmidt
Mr. and Mrs. David G. Miller
Ms. Mary Peppey and Family
Mr. and Mrs. F. Thomas Rebholz
Mr. and Mrs. Don Reiner
Mr. Gene Stark
Mrs. Virginia L. Uecker
Ms. Rosemarie and Brother Joseph Voros

JOAN WILKE

Mrs. Patricia A. Rankin Koch

SANDI WILLKOMM

Mr. and Mrs. Leander N. Willkomm

JANE E. WINKLER

Ms. Patrice Viganego

MARTIN (MARTY) WIRTH

Ms. Jane Bubolz
Ms. Lucille Bubolz

DR. WILBERT WIVIOTT

Mr. and Mrs. Christopher Mutschler

INEZ I. WOJCIECHOWSKI

Mr. and Mrs. C. Boling
Mr. Daniel J. Borcherding
Ms. Phyllis Brandt
Family and Friends
Mr. and Mrs. David Garbisch
Ms. Lucille Gentel

We are donating the contributions we received in my mother's memory to St. Luke's Heart Fund. We are thankful for the "bonus years" we had with her. We hope more research and study will lengthen survival rates for future generations.

GRATEFUL FAMILY
WAUKESHA, WISCONSIN

Mr. and Mrs. Jeff Jankowski
 Ms. Dorothy Kielley/Stepanovich
 Ms. Evelyn A. Kochanski
 Mrs. Ann Malicki
 Milwaukee Electric Tool
 Corporation
 Mr. and Mrs. David Schmid
 Mr. and Mrs. Andrew J. Steffen
 Ms. Ann Swirkowski
 Mr. and Mrs. E. Szelmecka
 Mr. and Mrs. Joe Tovar
 Washington County Farm Bureau
 D. Wojciechowski Family

THOMAS V. WOLLNER
 Ms. Bernadine Wollner

JACK E. WORKMAN
 Mrs. Marilyn N. Workman

WALTER R. WOYTASIK
 Ms. Marie V. Onopa

THERESA M. WYRWAS
 Mr. Casimir T. Wyrwas

KAREN YONTZ
 Mr. and Mrs. James Bowen

HENRY YOUMANS
 Mrs. Patricia Rankin Koch

GEORGE E. ZACHER
 Mrs. Marguerite Zacher

SHERRY ZANOLA
 Ms. Margaret Wilken
 Kari and Chris

PAUL C. ZAPFE
 Mrs. Helen D. Zapfe

JENNIE ZEGA
 Ms. Mary Ann Palubicki

ESTHER ZIEMER
 Mr. and Mrs. Al Ziemer

MARGUERITE ZISK
 Mr. Maylnn T. Zisk

SPENCER BRIAN ZOGG
 Mr. and Mrs. Don Bastian
 Mr. and Mrs. Gerald M. Block
 Mr. William T. Born
 Family and Friends
 Mrs. Melvina Feest
 Mr. and Mrs. Keith W. Fredericks
 Mrs. Zora Jovanovic
 Ms. Karen Lawonn-Allen
 Ms. Mary M. Neumann
 Mr. and Mrs. James H. Robinson

St. Luke's Medical Center
 O.R. Personnel
 Vicki Acke
 Lee Bauer
 Pam Bauer (Janick)
 Debbie Boguszewski
 Mary Bruckbauer
 Nicole Cerni
 Jenny Cooper
 Tracy Czernick
 Matilda Franksi
 Kathy Frick
 Cece Guerrero
 Jean Hall
 Evo Hendren
 Pat Hickman
 Sue Hornburg
 Nanette Johnson
 Peggy Kethley
 Sharon Kirsch
 Vicky Krause
 Mary Kay Librizzi
 Debbie Malko
 Phyllis Melze
 Sue Mikolczyk
 Mary Olzewski
 Sue Orlich
 Deanna Regulski
 Paulette Risley
 Anne Rope
 Dorene Rossman
 Dr. Terence M. Schmahl
 Mary Schofield
 Sheryl Shiroda
 Beverly Skowronski
 Carol Stankowski
 Rich Stromich
 Michelle Suworoff
 Reggie Thornton
 Shelly Tuominen
 Lillie Wells
 John Wirta
 Pat Worachek
 Julie Yorton
 Schneider Family and Gil and Jerry
 Mr. and Mrs. William F. Schreiber
 Mrs. Bettie Temperly
 Mr. Ken Torres

I'm Free

Don't grieve for me,
 for now I'm free
 I'm following the path
 God laid for me.
 I took His hand
 when I heard Him call
 I turned my back and left it all.
 I could not stay another day
 To laugh, to love, to work or play.
 Tasks left undone
 must stay that way,
 I found that place
 at the close of day.
 If my parting has left a void
 Then fill it with remembered joy.
 A friendship shared, a laugh, a kiss,
 Ah yes, these things,
 I too, will miss.
 Be not burdened
 with times of sorrow,
 I wish you the sunshine
 of tomorrow.
 My life's been full, I savored much,
 Good friends, good times,
 a loved one's touch.
 Perhaps my time seemed
 all too brief;
 Don't lengthen it now
 with undue grief.
 Lift up your heart
 and share with me
 God wanted me now,
 He set me free.

Author Unknown

LIFETIME PHILANTHROPISTS

St. Luke's Medical Center Lifetime Philanthropists is an organization of benefactors and friends of St. Luke's who have made provision to support the hospital in their estate plans or through life income gifts.

Because of their generous commitment, the excellence of health care available at St. Luke's Medical Center will be continued and enhanced for present and future generations.

If you have provided for St. Luke's Medical Center in your estate plans, but are not among those listed, please let us know. We would be pleased to welcome you as a member of the Lifetime Philanthropists.

For more information on becoming a member of the Lifetime Philanthropists, please call or write St. Luke's Medical Center, Office of Philanthropy, P.O. Box 2901, Milwaukee, WI 53201-2901. Phone: (414) 649-7194.

CHARTER MEMBERS

Anonymous
Mr. and Mrs. Ladislav Albert
Mrs. Erwin H. Albrecht
Mr. and Mrs. Alan Ball
Mr. Richard N. Bartels
Mrs. Betty Bates
Mrs. Ruth Benduhn
Mrs. Loretta Brown
Mr. Melvin Datka
Mr. and Mrs. Alfred U. Elser, Jr.
Mr. and Mrs. John G. Fleckenstein
Mrs. Alfred A. Fox
Mr. and Mrs. Edward A. Grede
Mr. and Mrs. Raymond D. Heitkemper
Mr. Harry G. Henke
Mrs. Carole F. Houston
Mr. Gerald E. Kosharek
Mr. and Mrs. Walter F. Landowski
Mr. and Mrs. Robert J. Lang
Mr. Willard Lange
Mr. and Mrs. Helmut Langer
Mrs. Virginia Levenhagen
Mr. James A. Lochschmidt
Mr. Albert Long
Mr. Dominic Lychwick
Mrs. Frank McNicol
Mrs. Mary Nault
Mr. Karl G. Roeming
Mr. Edward H. Saemann
Mr. Waldemar P. Schmitz
Mr. and Mrs. Derrill W. Stevenson
Mr. and Mrs. A. Jerome Stoebe
Dr. Elaine Thomas
Dr. Henry Veit
Mr. Harold C. Vestrem
Mr. Franc Vitale
Charles+ and Ann Wallen

MEMBERS

Anonymous (6)
Mrs. Joyce J. Achtenhagen
Ms. Bernice C. Acorn
Mr. and Mrs. Ralph Ambrosius
Mrs. Doris Arnold
Mrs. Merilee E. Bailie,

in memory of Eda Anderson
Mr. and Mrs. John H. Barr
Dr. and Mrs. James C. Barton
Chaplain and Mrs. Harvey Berg
Mrs. Katherine Berggren
Mr. and Mrs. William J. Betz
Mr. Jonathan S. Braddock
Jerry and Carol Brown
Mr. and Mrs. William I. Buckeridge
Mr. and Mrs. Robert J. Byers
Ms. Colleen Cauley
Mr. and Mrs. Fredric L. Chase
Ms. Lori A. Craig
Mr. Mark T. Davies

*On behalf of my
family, I would like to
thank the St. Luke's
staff for the care they
extended to my
mother and all of us.
Thank you.*

GRATEFUL FAMILY HALES CORNERS, WISCONSIN

Mrs. Johanna Dobner
Mrs. Joy Dory
Mrs. William Duffy
Mr. and Mrs. Merle Eggen
Mr. and Mrs. Timothy C. Ellis-Stigler
Mrs. Joyce Fischer
Mr. George L. French
Mrs. Anna Gerschwiller
Mr. W. Gary Gitchel
Mrs. Edna Goad
Mr. and Mrs. Luther Graef
Fred A. Grube
Mrs. Morland Hamilton
Miss Deanna Hartl

Mr. Brad Holmes
Mr. and Mrs. Fred H. Huck
Mr. and Mrs. Robert C. James
Mr. and Mrs. Charles Jerele
Mrs. Dorothy Johnson
Mr. and Mrs. Carlton P. Kirst
Mr. and Mrs. Robert Krowas
Mrs. Sally Kuhlman
Mr. Joseph A. Lauber
Mrs. Ruth M. Lewis
Mrs. Aleta Lone
Mr. and Mrs. Robert E. Luebke
Mr. Aldo Madrigano
Mr. and Mrs. Paul C. Maillard
Mrs. Dorothy F. McMicken
Mr. and Mrs. Ronald J. Miller
Randy and Cheryl Moss
Mr. William K. Murphy
Mr. Larry G. Neuman
Mr. Joseph Norton
Mr. Walter A. Oestreich
Mrs. Judy Pankow
Mrs. Margaret Peet
Mr. and Mrs. Edward G. Pruim
Mrs. Jean Radosta
Mr. and Mrs. Ricky B. Ross
Mrs. Kelly W. Sachse
Mr. and Mrs. Charles L. Schick
Mrs. Laverne A. Schmidt
Mr. Ray E. Sherman
Mr. Theodore Siegmann
Mr. and Mrs. Ralph R. Staven
Mr. Edward H. Stech
Mr. and Mrs. Kenneth Stoll
Mr. and Mrs. James E. Sullivan
Mr. Sabin C. Taplin
Mr. William H. Tarrolly
Mr. and Mrs. Donald W. Tendick, Sr.
Mrs. Beverlee Tomazin
Dr. and Mrs. John A. Walker
Dr. James R. Warsh
Dr. John E. and Rev. Holly W. Whitcomb
Mrs. Kathleen Wickert
Mr. and Mrs. Don Wood
Mr. and Mrs. Donald A. Zellmer

IN MEMORY

*In memory of St. Luke's Lifetime
Philanthropists and benefactors
whose bequests are living on to
advance the quality of health care
at St. Luke's Medical Center*

Cassie M. Bach
Erika H. Baderman
Leonard L. Bartell
Manfred P. Benduhn
Richard B. Benesch
Aleksy and Sophia J. Biskupski
R. Fred Brenner
Alicia Buchholz
Ruth F. Buchholz
Margaret F. Butler
John C. Cleaver
Viola M. Clow
June B. Davis
Joan M. Dlugopolski
Alex V. Dumas
Anna Patia Evanich
Valentine Fina
Helen G. Fons
Herman Friedrich
Florence Furman
Fred Gerschwiller
Sam B. Ginsburg
Fred C. Goad
Frederic T. Goes
Louise D. Goes
Edward J. Gostomski
Arthur L. Grede
Elizabeth Grede
Anna A. Grunke
Dr. J. Edwin Habbe
Lorraine C. Heinen
Dr. Byron A. Helfert
Walter and Adela Helwig
Elizabeth Henke
Harry Hershoff
Fredda Hoermann
Raleigh Hubbard
Edward C. Huth
Mae E. Imholte
Esther E. Ingraham
Marguerite Jahr
Lucille K. Johnson
Ruth E. Johnson

Italic print indicates St. Luke's Philanthropists Club members.

+ Deceased

At this time of the year, I reflect upon the good things in my life and one of the best things is my father. I'm glad that his hospital is St. Luke's. I appreciate the dedication of your staff doctors, nurses and others who took care of him. Enclosed is a contribution in honor of my father and all those who have worked so hard to make him better.

GRATEFUL DAUGHTER
CEDARBURG, WISCONSIN



Dorothy Johnson and Bette Spaar

Russell K. Kline
Klara and Ralph Kluge
Herbert W. E. Kneisler
Herman Korsitzke
Erwin R. Lamp
Charles Levenhagen
Winetta Long
Stanley and Rose Luba
Georgianna McFetridge
Katherine R. McGill
Carolyn S. McGregor
James F. McMicken
Frank McNicol

Esther Mielke
Helen L. Mikol
James B. Moore
Ernest H. Morgenroth
August G. Mueller
Rudolph Mueller
Ann Murphy
John R. Nault
Alexander F. North
Helen F. Ockerlander
Charles D. Ortgiesen
Josephine Panich
John and Violet Pazucha

Richard S. Piasecki
Margaret Kain Pochert
John L. Racanello
Adolph J. Ricker
Dr. Albray M. and Jennie Riedel
Edward Ropiak
Mary E. Rose
Pierce Rosenberg
Cava Wilson Ross
Charles Louis Rothweiler
Ella Sadowski
Louis R. Schmaus
Walter Schroeder
Elsie M. Seitz
Milton R. Sheffield
John W. Siebert
Reginald L. Siebert
Sidney B. Slocum
Clara A. Speeter
Eleanor Spence

Edna A. Stallman
Minnie Stein
Henry O. Stenzel
Opal A. Stiehm
Olive Stiemke
Walter H. Stiemke
Carl T. Swenson
Ruth Taplin
Ray G. Tiegs
Charles Trinthammer
William W. Verhulst
George K. Viall
Bertha H. Waetjen
George L. Waetjen
Edward R. Wehr
Sophia P. Weisfeldt
Arline White
Eleanora A. Wilinski
Stanley T. and Irene Wos



Virginia Levenhagen

It is that time of the year again when we feel grateful that we can continue our yearly donation to St. Luke's Medical Center.

ST. LUKE'S PHILANTHROPISTS CLUB MEMBERS
MEQUON, WISCONSIN

REMEMBERING BRENDA AND FIGHTING CANCER

Spending a Packer Sunday with friends was a favorite pastime of Brenda Borowski. Regrettably, it was one such game day in 1995 that changed the lives of Brenda and her husband, Rick, forever. She discovered a lump in her breast. "I urged her to get it checked out right away," Rick remembers. Brenda was only 29. Young, in love, and married for only three years, the couple wasn't prepared for the devastating diagnosis to come.

Brenda immediately went to see her doctor, who referred her to St. Luke's oncologist Ronald D. Hart, MD. When the biopsy tested positive for cancer, she began chemotherapy treatments, followed by a modified radical mastectomy on her left side and reconstructive surgery performed by St. Luke's plastic surgeon Philip Sonderman, MD.

Soon after, St. Luke's oncologist Robert Taylor, MD, performed an autologous bone marrow transplant (ABMT), which "reinfused" Brenda's own marrow. Stem cells are the key components in an ABMT. Because they are easily damaged with very high doses of chemotherapy, they are removed from the bone marrow or blood stream and preserved before the patient receives chemotherapy. When the treatment is completed, the stem cells are "transplanted" back into the patient.

Brenda's stem cells were harvested at St. Luke's Vince Lombardi Cancer Clinic (VLCC). For the first three months after the transplant, Brenda made daily visits to the VLCC for lab work and met with Dr. Taylor weekly, to ensure that her recovery was progressing. The chemotherapy, mastectomy and bone marrow transplant occurred within the space of one year, and the cancer went into remission for nearly two years.

During this time of remission, Brenda and Rick returned to many of the activities they had enjoyed together since meeting on a Green Lake beach in 1989. Riding horses, gardening in the backyard, playing volleyball, vacationing with friends and cheering on the Packers were at the top of this list. For Brenda and Rick, being together was the most important thing.

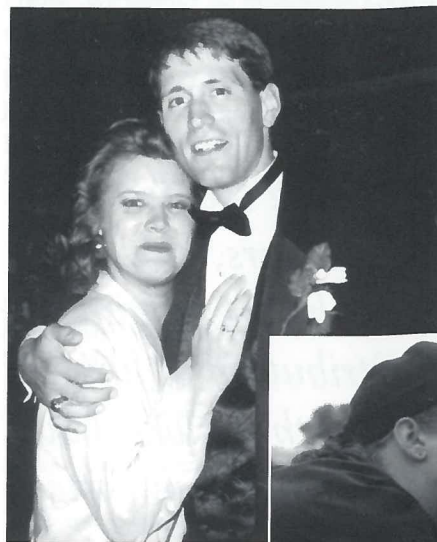

Brenda and Rick Borowski had been married for just three years when she was diagnosed with breast cancer.



In 1997, during a follow-up exam, Brenda's doctor discovered calcifications on her right side. Calcifications are detected through mammograms and can be an indicator of cancer. Although initial results did not indicate cancer, the doctors conferred with Brenda and Rick about the best course of treatment. Given Brenda's history, they decided to do another modified radical mastectomy on her right side, again followed by reconstructive surgery.

Brenda lived cancer-free for another year and a half, until a brain tumor was diagnosed in May 1999. Aided by the advanced technology available at St. Luke's, neurosurgeon Arvind Ahuja, MD, removed an encapsulated tumor from Brenda's occipital lobe, the part of the brain that controls vision. Following surgery, she underwent numerous radiation oncology treatments with Dr. Ellen L. Ziaja. Brenda made a full recovery.

Judy Pinchar, a soon-to-be close friend and confidante, met Brenda for the first time after this latest surgery. "Both Brenda and I were helping mutual friends get ready to open a restaurant. As we began talking, Brenda said she was looking for a job, as she had lost her previous one. When I asked her why, she pulled off her hat, revealing a bald head, saying 'Maybe having brain surgery had something to do with it,'" says Judy. By mere coincidence, Judy, a local attorney, was looking

continued on next page

to hire a new bookkeeper. As Brenda had plenty of experience and the right attitude for the position, she was hired that day.

"She really threw herself into the work with gusto. The clients were all taken with her," Judy remembers. "Although she was desperately ill, you would never have known it. Brenda never wasted a minute; she had a natural gentleness and compassion. When I think about Brenda, I think about her smile and her sense of humor."

Brenda's zeal for life carried her through almost the entire year. As she and Rick prepared to ring in the new millennium, they received another devastating diagnosis – Brenda had developed carcinoma meningitis, a cancer of the brain. While doctors treated this cancer with chemotherapy administered through a shunt in her brain, Dr. Hart told Rick that this time, the prognosis for Brenda was not good.

The brain tumor left Brenda unable to drive, so Rick took her to and from work every day. It was important to Brenda to maintain her daily routine for as long as possible. She worked throughout the summer, but her condition began to decline in the fall.

In late October 2000, Brenda entered hospice care. She passed away on November 21, 2000.

"Brenda had immense respect for the cancer team at St. Luke's. She talked about contributing to the Vince Lombardi Cancer Clinic because of the special care she had received there and her love of the Green Bay Packers," Rick explains. To honor this wish, Brenda's family and friends advance cancer research at St. Luke's through gifts in Brenda's name.

A gift to The Tribute Fund is a thoughtful way to express your feelings and benefit St. Luke's Medical Center at the same time. Your gift can help heal a heart or bring a smile on a special occasion. Through your giving, holidays, recovering from an illness and other significant events in your life or the life of someone special can become a symbol of your concern.

When you give a gift to The Tribute Fund, you will receive an acknowledgement. Notification will also be promptly sent to the person or family you designate. No mention of the amount of the gift will be made. All Tribute gifts are recognized with your name and that of the person being honored or memorialized in *The Spirit of St. Luke's*. Additional distinctive opportunities for recognition are provided at higher levels of giving.

To request a Tribute Fund booklet, please call the Office of Philanthropy at (414) 328-6424.

Please use my gift as an investment in medical progress. I want to help others live a better life.

☐ \$500* ☐ \$250* ☐ \$100* ☐ \$50 ☐ \$25 ☐ Other \$ _____

Gift in *memory* of _____

Gift in *honor* of _____

Occasion _____

Please notify the following of my gift:

Name _____

Address _____

City, State, Zip _____

Please make your gift payable to St. Luke's Medical Center and return this form with your gift.

St. Luke's Philanthropists Club – Suggested Gift Plan

<i>Giving Level</i>	<i>Annual Contribution</i>	<i>Quarterly Contribution</i>
Garnet	\$100	\$25.00
Emerald	\$150	\$37.50
Ruby	\$250	\$62.50
Crystal	\$500	\$125.00
Diamond	\$1,000	\$250.00
Hanover Society	\$5,000	\$1,250.00

* With your gift of \$100 or more, you are invited to become a member of St. Luke's Philanthropists Club. You will receive an invitation to the Annual Dessert Gala and your name will be recognized on a unique display in St. Luke's distinguished recognition area. Additional benefits are provided with increased levels of giving.

Little Luke Fund

The Little Luke Fund was established to educate children about charitable giving, in order to promote those values that are important to you. As adults, we can help children understand all aspects of finances—spending, saving and sharing.

An initial gift of \$1,000 in honor of a child—birth through age 16—establishes a Little Luke Fund. Gifts may be added to the fund throughout its lifetime, and all interest income is 100% reinvested. The fund matures when its value reaches \$25,000.

Upon maturity, the fund is split, with half of that value allocated for purposes designated by St. Luke's Medical Center. The honoree may allocate the remainder of the fund to St. Luke's Medical Center and/or the Aurora Health Care service or program of their choice. As an adult, the honoree will be able to make a significant gift to research or a patient care program of their choice.

Anyone can start a Little Luke Fund—grandparents, parents, godparents, aunts, uncles, cousins, sisters, brothers or friends. Honor the special children in your life and share the joy of giving with them through a Little Luke Fund.

Benefits

- Teaches children about the joy of giving
- Recognizes child and donor in a distinctive way
- Provides educational and age-appropriate newsletters for honoree
- Sparks interest in philanthropy and health care through an annual event
- Encourages family-wide philanthropy
- Updates honoree on growth of fund annually
- Enhances bond between donor and honoree with a unique gift

Information

For more information, contact Laverne Schmidt, Office of Philanthropy, St. Luke's Medical Center, (414) 649-7123.



St. Luke's Medical Center®
Aurora Health Care

Office of Philanthropy
P.O. Box 2901
Milwaukee, WI 53201-2901

ADDRESS SERVICE REQUESTED

Non-profit
Organization
U.S. Postage
PAID
Permit No. 3781

Kathleen Strube
MGR LIBRARY
956 AURORA LIBRARIES
05 / SL